

K9-F28-XL INSTALLATION INSTRUCTIONS

K9 Kit for 2020-2024 FORD INTERCEPTOR UTILITY

TOOLS Needed:

Phillips Screw Driver	Trim panel removal tool	Caulk Gun	Drill & drill bits
Standard Socket set	Wire Cutters /Crimpers	Metric Socket set	

PARTS & HARDWARE:

QTY	DESCRIPTION	ITEM # White	ITEM # Black
1	Front bulkhead with sliding door	18879	18880
2	Lower "B" pillar bracket		18848
2	Upper "B" pillar bracket		18849
1	Rear bulkhead	24588	24589
1	Rear bulkhead cross support bracket	18846	18847
1	Front floor section Driver side		23181
1	Front floor section Passenger side		23182
1	Driver side floor step	18803	18804
1	Passenger side floor step	18805	18806
2	Hot-N-Pop gas spring hole cover	18858	18859
1	Angled rear floor section	22982	23183
1	Front floor bracket		22980
1	Middle floor bracket		22981
1	Rear floor bracket		18798
1	Rear cargo trim cover		18877
1	Ceiling	18811	18812
2	Ceiling air duct vents	18517	18518
1	Passenger side rear wall	18827	18828
1	Passenger side upper trim panel	18835	18836
1	Passenger side / side ceiling trim panel	18843	18844
1	Passenger side lower trim panel	18819	18820
1	Driver side rear wall	18823	18824
1	Driver side upper rear trim panel	18831	18832
1	Driver side / side ceiling trim panel	18839	18840
1	Driver side lower filler trim panel	18815	18816
2	Electronics access cover	18856	18857
1	Driver side door panel (DP-F28-1A)	14607	14608
1	Passenger side door panel (DP-F28-6A)	14621	14622
2	Door panel speaker cover		14628
1	Driver side hinged window guard (WGI-F28-1-K9)		21249
1	Passenger side hinged window guard (WGI-F28-6-K9)		21250
1	Rubber Mat		18853
1	Silicone caulk (sealant)	20011	20012
2	Dome Light Kit	K9-A-106	

C-HK-341 (includes the following)

2	Rubber bumpers (for Rear cargo trim cover)	13691	
39	1/4" serrated flange nut	16086	
27	1/4" x 3/4" Carriage bolt – SS	16235	
67	1/4" x 3/4" Phillips pan head bolt - SS	16618	
68	1/4" Flat washer - SS	16154	
2	5/16" Flat washer	16123	
2	5/16" x 1.25" HHCS	16337	
12	1/4" x 1/2" Carriage bolt	16233	
24	#10 Sheet metal screws	16655	K9-F28-XL_INST_5-25

Installation Notes:

- Read all instructions before installing any Havis, Inc. products.
- Use hardware provided with install kit.

Vehicle Note:

For K9 applications, it is recommended to order the Interceptor Utility with the OEM optional Aux Rear Air conditioning. (Ford option code 17A)

K9-F28-XL Assembly

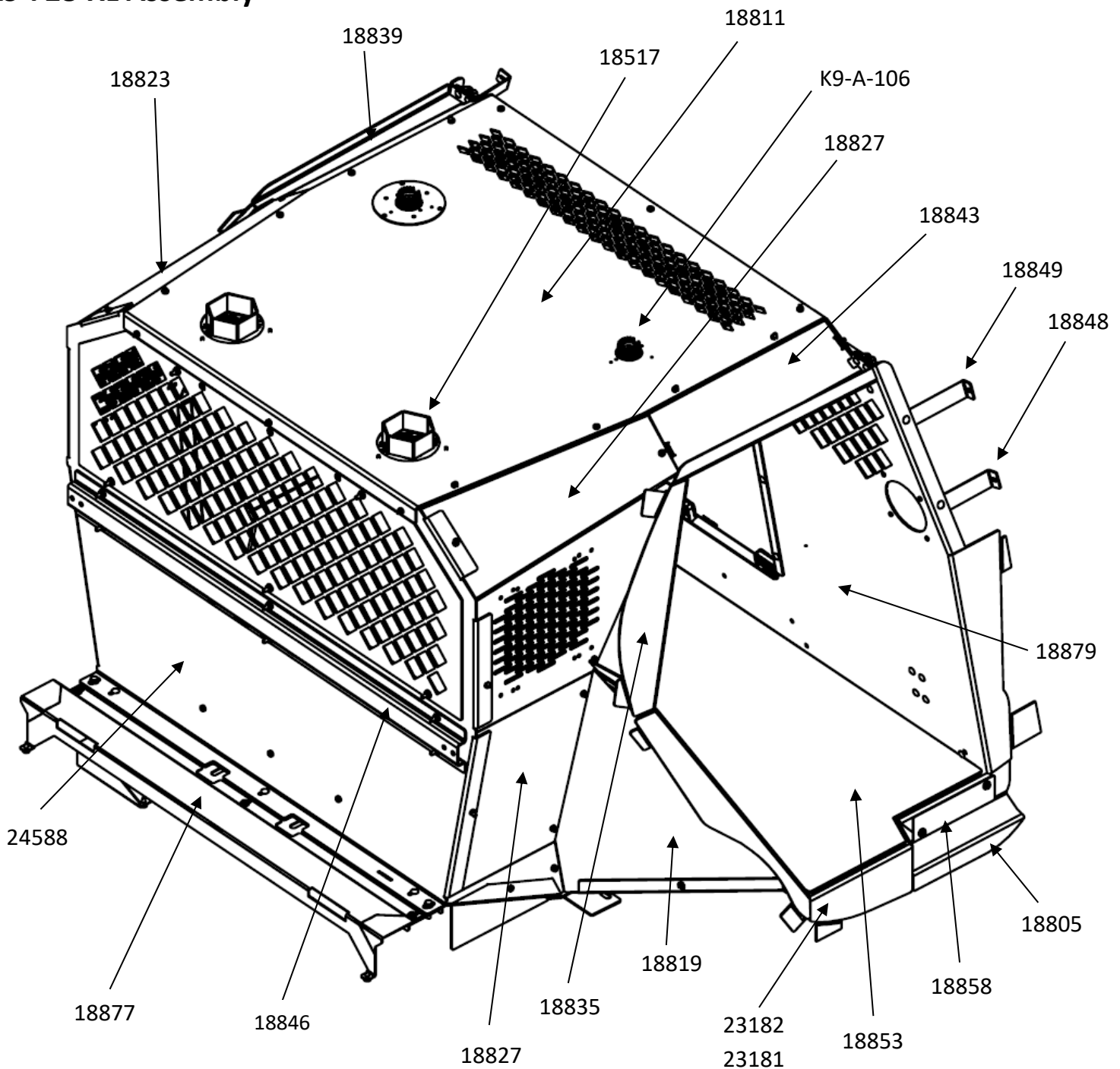



Remove the rear passenger, door panels first. Behind the door open paddle handle and grab handle, remove plastic cover and 10mm head bolts. Remove two 7mm head fasteners from bottom of door.

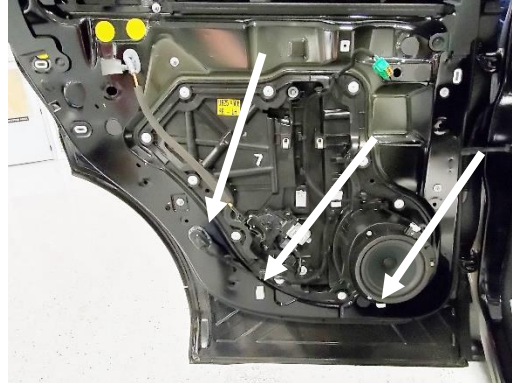

Remove (2) plastic screw retainers from bottom of door. *These will not be reused.*
Note: Push in oval grommet with wire harness so K9 door panel lays more flat when screwed on. Make sure harness does not interfere with internal door parts.



Remove door speaker. (7mm socket)
Prior to next step, attach Speaker cover to door panel with 1/4"x1/2" carriage bolts and serrated nuts.

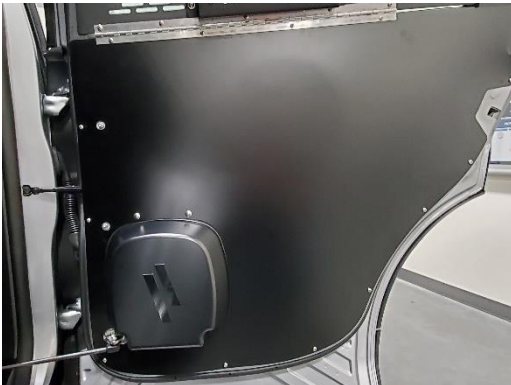

Attach speaker pods to door panels using supplied carriage bolts and serrated nuts. Place K9 kit door panel onto door. The top will hook onto rubber molding.

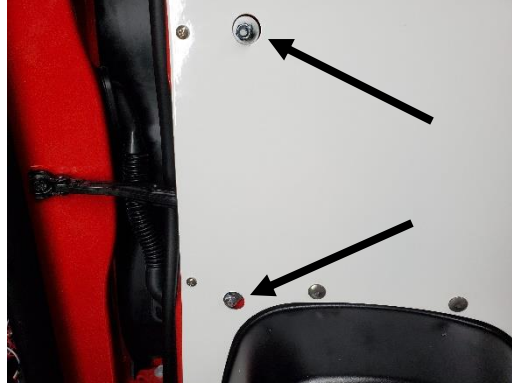

Be sure to center cutouts in door panel over OEM window track studs. Drill mounting holes with 1/8" drill bit. Attach door panels with supplied #10 x 1/2" Phillips pan head sheet metal screws.

Note:

It is always highly recommended to use a drill stop to eliminate the possibility of drilling too deep.

Check remote door unlock feature before closing door.

If desired, the window studs may be cut off or grinded flush to the OEM nuts.



NOTE: Window guards are shipped flat. On the edge of a work bench, bend a contour in the middle of the guard so it will fit tight against the window frame.



Position window guard with hinge assembly inside window frame and attach hinge to door panel pre-punched holes with supplied # 10 x 1/2 Phillips pan head sheet metal screws.



With upper mount bracket attached to window guard, mark mounting hole locations in upper door / window frame. Drill 5/32 holes. **Note: OEM black trim stays on window frame.**



Attach upper mount bracket to window frame with supplied #10 x 1/2 Phillips flat head sheet metal screws.



Door Panel and Window Guard complete.
See last page of instruction if mounting fan to window guard.



Remove back seats and set aside.
Set hardware aside to use later on.



Remove door sill plates.
These will not be reused.



Remove rear floor sections.
T-55 Torx socket will be needed for the forward floor section bolts.



Remove the large section of foam.
This will not be reused.



The two smaller sections of foam can be left in place.



The (3) seat belts on the back seats have built in sensors that will turn on an indicator on the dash. These must be removed from the OEM seats.

(T-50 Torx)

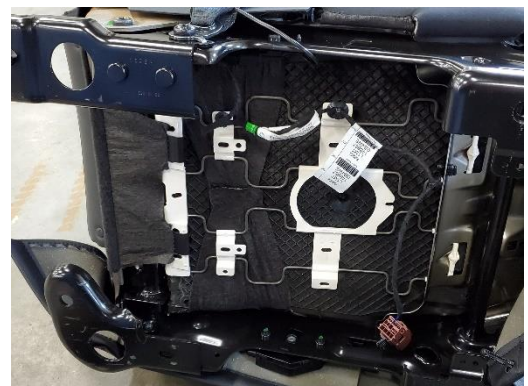

Remove the seat belt harness from the bottom of the seat.

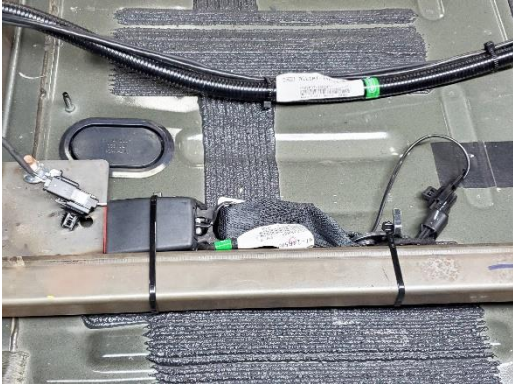

Wire tie the removed seat belts to the OEM cross brace and plug back in.

Note: Make sure to connect back into the original plug. Double check that the pins in plugs did not come loose.

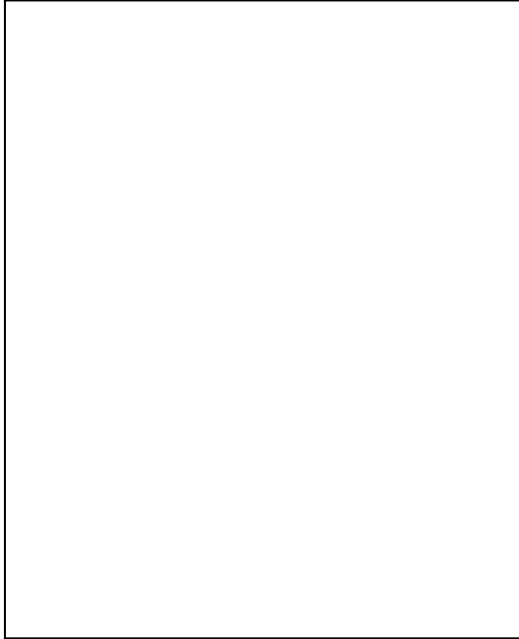

Use OEM seat bolts to attach K9 kit, front floor bracket to OEM seat mount locations.



Use OEM nuts to attach K9 kit middle floor support bracket to OEM cross brace.



Attach rear floor bracket using previously removed T-55 Torx bolts.
NOTE: If using with C-TTP-INUT-1200/1201, make sure to install this bracket as far forward as possible!



If using the optional K9-A-111 bracket, attach Whelen Cencom unit to bracket now.



Attach K9-A-111 to rear floor mounting bracket with supplied mounting hardware.



Prior to installing floor, side floor steps must be attached.



Attach with (3) 1/4" x 3/4" Phillips head bolts and flat washers.



Attach cover plate with supplied hardware.

Note: Run wiring for dome light, rear fan and other equipment prior to installing floor.



Place floor into vehicle and loosely attach to front and middle floor brackets with 1/4" x 3/4" Phillips head bolts and flat washers.



Place rear angled floor section into vehicle. Attach to forward floor, and rear bracket with 1/4" x 3/4" Phillips head bolts and flat washers.

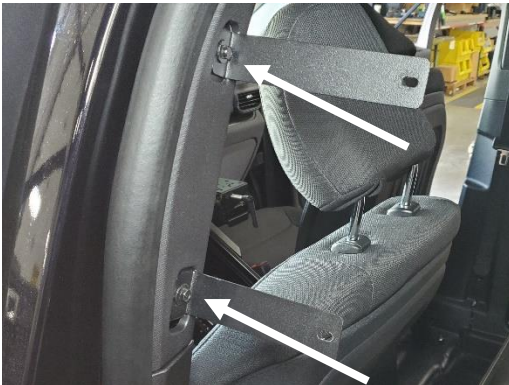

Prior to front bulkhead installation, remove OEM "B" pillar grab handles. Attach upper front bulkhead "L" brackets to "B" pillar with OEM grab handle screws. (Longer bracket on top and "L" flange facing out as shown)



With the help of a second person, carefully place front bulkhead into vehicle. Take care not to scratch floor.



Loosely attach front bulkhead to "B" pillar brackets with 1/4" x 1/2" carriage bolts and serrated flange nuts. Bracket goes on inside of bulkhead flange.



Carefully lay rear bulkhead on flat work surface prior to installation.

Note: Rear bulkhead no longer has removable rear guard.



Place rear support brace on backside of bulkhead.

Flange at bottom of wall should be facing up.



Attach brace with 1/4" x 3/4" carriage bolts and serrated nuts.

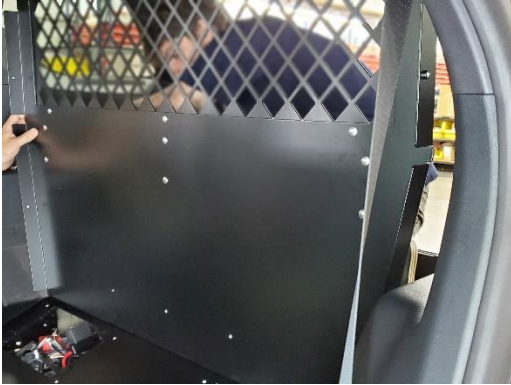

Carefully place rear bulkhead into vehicle and line up to holes in floor.



Attach rear bulkhead to floor and floor bracket with (3) 1/4" x 3/4" carriage bolts and serrated nuts.



Tighten hardware when all three bolts and nuts have been installed.



Attach electrical access covers with 1/4" x 3/4" Phillips head bolts and flat washers.



Place ceiling on top of front and rear bulkheads.
Loosely attach ceiling to rear bulkheads with 1/4" x 3/4" Phillips head bolts and flat washers.

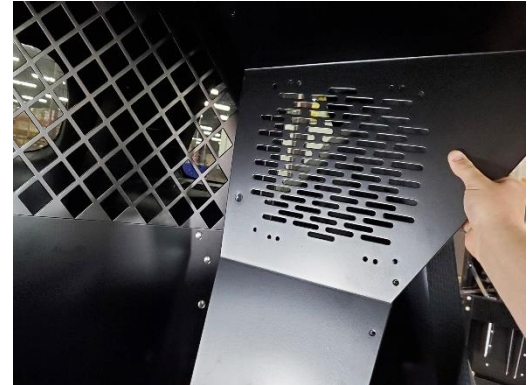

Attach rear side wall into kit with 1/4" x 3/4" Phillips head bolts and flat washers.

Repeat for other side

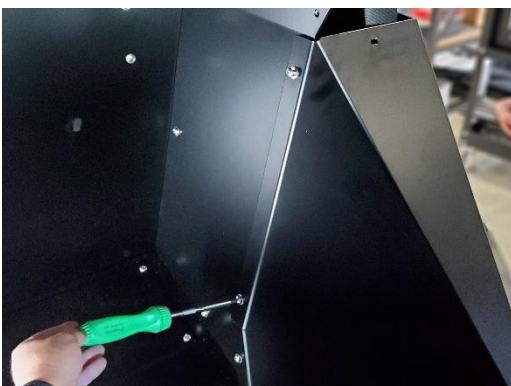

Attach lower trim panel with 1/4" x 3/4" Phillips head bolts and flat washers.

Repeat for other side

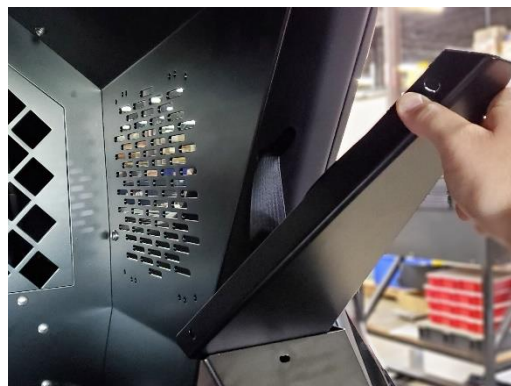

Attach upper rear trim panel to rear side wall and lower trim panel with 1/4" x 3/4" pan head Phillips bolts and flat washers.

Repeat for other side



Attach upper trim panel with 1/4" x 3/4" Phillips head bolts and flat washers.

Repeat for other side



Attach (2) rubber bumpers (CM93084) into the rear trim panel. One on each end with the bumper facing down.



Place rear trim panel onto rear floor mounting bracket and line up to threaded inserts.



Attach with (3) 1/4" x 3/4" Philips head bolts and flat washers.
Do not tighten yet



Place OEM rear floor into vehicle and line up to rear filler. Tabs from floor will insert into bracket. Determine location where floor lines up to rear hatch sill plate.
Tighten hardware



Install optional K9-A-108 divider into kit now. Divider can now be slid in through either side. Once inside the kit, turn divider and line up square to front and rear bulkhead



The divider wall can be placed in three different position using pre-punched mounting holes. Divide 50/50 or 60/40. Once location is determined, attach divider to rear bulkhead with 1/4" x 3/4" Philips head bolts and flat washers.



Attach upper rear section of divider to rear bulkhead with 1/4" x 3/4" Philips head bolts and flat washers.



Attach front of the divider to front bulkhead with 1/4" x 3/4" carriage bolts and serrated nuts.



Repeat for top of divider



Example mounting location for the optional air circulation fan.

K9-A-102



Neatly silicone / caulk the lower seams to shed water out of vehicle.

Note: The floor is designed to minimize the need for sealant. Caulk (sealant) is mostly needed where the floor meets the door sill and lower filler panels.



Driver side window guard with optional 10" fan kit shown.

Fan and window mount kit part number **K9-A-104**

****Kit includes K9-A-301 fan and WGI007335 mount with hardware****

K9-A-104 also works on Passenger side window guard.



Confirm smooth slide and lock function on front egress door.



Installation is now complete.

Insert shown with optional K9-A-108 divider.

Dog sold separately

