

INSTALLATION INSTRUCTIONS:

1. SLIDE PASSENGER SIDE FRONT SEAT FULLY TO THE REAR
2. REMOVE 2 FRONT SEAT MOUNT BOLTS AND FLOORMAT
3. PLACE SPACERS ON TOP OF SEAT FRAME, OVER SEAT BOLT HOLES
4. PLACE MOUNT ONTO SPACERS
5. INSERT TWO M10 X 1.25 BOLTS WITH WASHERS AND TIGHTEN TO MANUFACTURER'S TORQUE SPECIFICATION
6. INSTALL POLE ONTO OFFSET BRACKET USING GENERAL INSTRUCTIONS AND HK PROVIDED WITH POLE
7. USING 1/4-20 BOLTS AND WASHERS FROM HARDWARE KIT, INSTALL OFFSET BRACKET AND TIGHTEN BOLTS

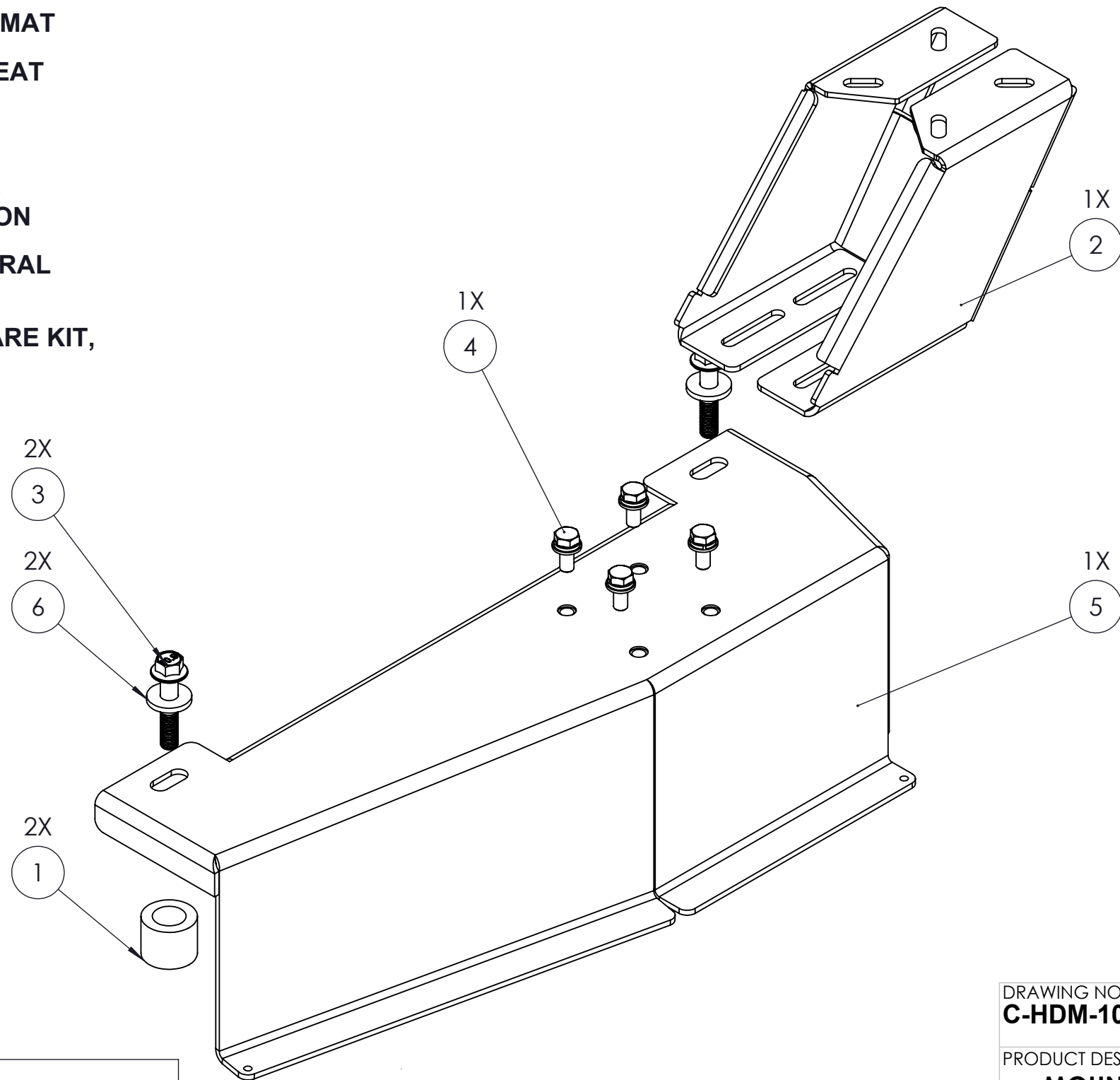

LINE	QTY.	HK	DRAWING NO.	DESCRIPTION
1	2	2	10-003319	SPACER, 1"
2	1	2	10-012991	BRACKET, MOUNT, 45° 3.5" LOWER OFFSET BASE W/SLOTS
3	2	2	56137	JIS High-Strength Steel Flanged Hex Head Screw, Black-Oxide, M10x1.25 mm Thread, 50 mm Long, Partial Threaded
4	1	1	C-HK-102	BASE OFFSET HK (NOT SHOWN)
5	1	1	E101422	BRKT, MOUNT, HDM, TOYOTA GRND HIGHLANDER
6	2	2	GSM31144	WASHER, 3/8" ID, 1" OD

WARNING: ALL HAVIS INC. PRODUCTS ARE DESIGNED WITH SAFETY OF USE AND INSTALLATION IN MIND. HOWEVER, IT IS THE SOLE RESPONSIBILITY OF THE OWNER/OPERATOR OF A VEHICLE USING HAVIS INC. MOUNTING AND DOCKING EQUIPMENT, TO ENSURE THAT THE EQUIPMENT IS INSTALLED SO THAT IT WILL NOT INTERFERE WITH VEHICLE OPERATION, INTERFERE WITH SAFETY DEVICES, OBSTRUCT VIEW OF DRIVING CONDITIONS, OR IN ANY WAY DEGRADE OCCUPANT SAFETY. IMPROPER INSTALLATION CAN CAUSE SERIOUS INJURY IN THE EVENT OF AN ACCIDENT. INSTALLATION SHOULD ONLY BE PERFORMED BY QUALIFIED PROFESSIONALS. COMPUTERS AND MOTION DEVICES MUST BE MOVED TO AND STOWED/SECURED IN THEIR SAFE DRIVING POSITIONS BEFORE OPERATING VEHICLE.

DRAWING NO. C-HDM-1033-INST	REV. A
PRODUCT DESCRIPTION MOUNT, HDM, TOYOTA GRND HIGHLANDER	
 1-800-524-9900 WWW.HAVIS.COM	WEIGHT: (LBS) 12.655
	REV. DATE 05-20-26