

INSTALLATION INSTRUCTIONS:

- 1. Review hardware contents and ensure all items are available for assembly.
- 2. Remove existing side lugs and rear fences (if any).
- 3. Loosely assemble the new kit to the base tray as shown below.
- 4. Adjust tray according to the configuration instructions in the UT-1000/2000 Series Owner's Manual (accessible at [www.havis.com](http://www.havis.com) within the **UT-2002** product page).

LINE	DESCRIPTION	DRAWING NO.	QTY.
1	BRACKET, SIDE LUG	E100109	1
2	BRACKET, SIDE LUG	E100110	1
3	NUT, #10-32, 0.375" SQUARE X 0.130"	GSM30110	5
4	WASHER, BELLEVILLE, SERRATED, #10	GSM31089	8
5	SCREW, BUTTON HEAD, PIN-IN-TORX, #10-32x0.5, CLEAR ZINC W/ PATCH	GSM33327	3
6	SCREW, 10-32X1, TORX SECURITY	GSM33329	5
7	CAP - 0.45" X 0.5", 0.04" THK	GSM41120	4
8	CAP, RECTANGULAR 1.5" x 0.5" x 1/16"	GSM41124	1
9	L-KEY TAMPER RESIST, T25, 2-13/32" L	GSM50261	1
10	BRACKET, FRONT HOLD DOWN	UT-0168-SM	1
11	SPACER, ROUND, 0.438" OD x 0.297" ID x 0.563" LONG	UT-0187-MA	4

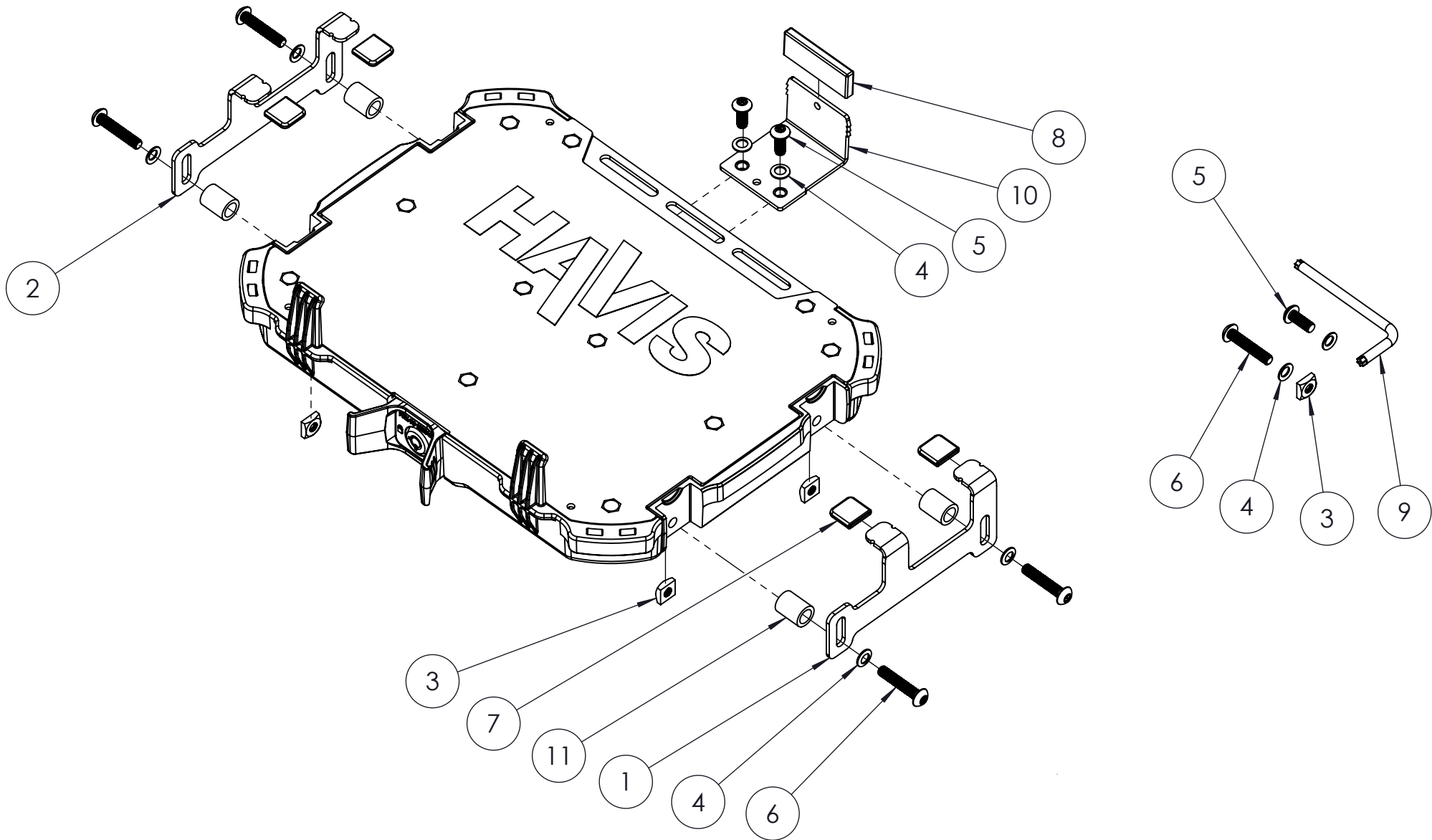

WARNING: ALL HAVIS INC. PRODUCTS ARE DESIGNED WITH SAFETY OF USE AND INSTALLATION IN MIND. HOWEVER, IT IS THE SOLE RESPONSIBILITY OF THE OWNER/OPERATOR OF A VEHICLE USING HAVIS INC. MOUNTING AND DOCKING EQUIPMENT, TO INSURE THAT THE EQUIPMENT IS INSTALLED SO THAT IT WILL NOT INTERFERE WITH VEHICLE OPERATION, INTERFERE WITH SAFETY DEVICES, OBSTRUCT VIEW OF DRIVING CONDITIONS, OR IN ANY WAY DEGRADE OCCUPANT SAFETY. IMPROPER INSTALLATION CAN CAUSE SERIOUS INJURY IN THE EVENT OF AN ACCIDENT. INSTALLATION SHOULD ONLY BE PERFORMED BY QUALIFIED PROFESSIONALS. COMPUTERS AND MOTION DEVICES MUST BE MOVED TO AND STOWED/SECURED IN THEIR SAFE DRIVING POSITIONS BEFORE OPERATING VEHICLE.

DRAWING NO.  
**UT-2024-KIT\_INST**

PRODUCT DESCRIPTION  
**UT-2024, UNIVERSAL TRAY SOLUTION**

  
1-800-524-9900  
WWW.HAVIS.COM

WEIGHT: (LBS)  
**2.429**

REV. DATE  
**12-26-24**