

## INSTALLATION INSTRUCTIONS

### INSTALLATION OF C-FAM-201 PRIOR TO VEHICLE INSTALLATION

#### (PKG-FAM-1XX ONLY):

1. ASSEMBLE FLEX ARM MOUNT (C-FAM-201) ACCORDING TO INSTRUCTIONS PROVIDED WITH FLEX ARM MOUNT.

#### VEHICLE INSTALLATION:

1. DETERMINE WHICH OF THE MOUNTING BRACKETS IS APPROPRIATE FOR THE APPLICATION. LOOSELY ATTACH THE MOUNTING BRACKET TO THE BASE WITH THE INCLUDED HARDWARE.
2. LOOSEN OR REMOVE THE PASSENGER SIDE FRONT SEAT BOLTS.
3. SLIP THE FORKED END OF THE MOUNTING BRACKET AROUND THE BOLT OR UNDER THE SEAT MOUNTING BRACKET AND AROUND THE BOLT.
4. RETIGHTEN THE OEM SEAT BOLTS TO THE MANUFACTURER'S RECOMMENDED TORQUE.
5. ADJUST SWIVEL DISCS AS DESIRED FOR PREFERRED EQUIPMENT POSITIONING.

#### EQUIPMENT INSTALLATION

1. ATTACH EQUIPMENT TO UPPER BALL SWIVEL OF FLEX MOUNT USING EITHER SUPPLIED #8 SCREWS AND/OR NUTS OR HARDWARE SUPPLIED WITH THE EQUIPMENT.
2. POSITION EQUIPMENT AS DESIRED.

#### INSTALLATION TIPS/ NOTES:

1. SWIVEL DISCS CAN BE RECONFIGURED IF DESIRED, BUT NEW CONICAL LOCKING NUTS (PROVIDED) SHOULD BE USED IF ORIGINAL NUTS HAVE BEEN REMOVED,
2. COMPLETELY TIGHTENING THE LOWER DISCS (TO LOCK IN POSITION) IS RECOMMENDED TO MINIMIZE SWIVEL/ HINGE MOVEMENT.
3. BALL MOUNT HOLE PATTERN FITS 1.19 X 1.50 (30MM X 38MM) AMPS HOLE PATTERN.
4. C-FAM-201 CAN ATTACH TO EITHER SIDE OF PLATE (AS DESIRED)

4X GSM33540  
4X GSM30027  
FOR EQUIPMENT  
MOUNTING

3X GSM30160  
ADDITIONAL  
LOCKNUTS

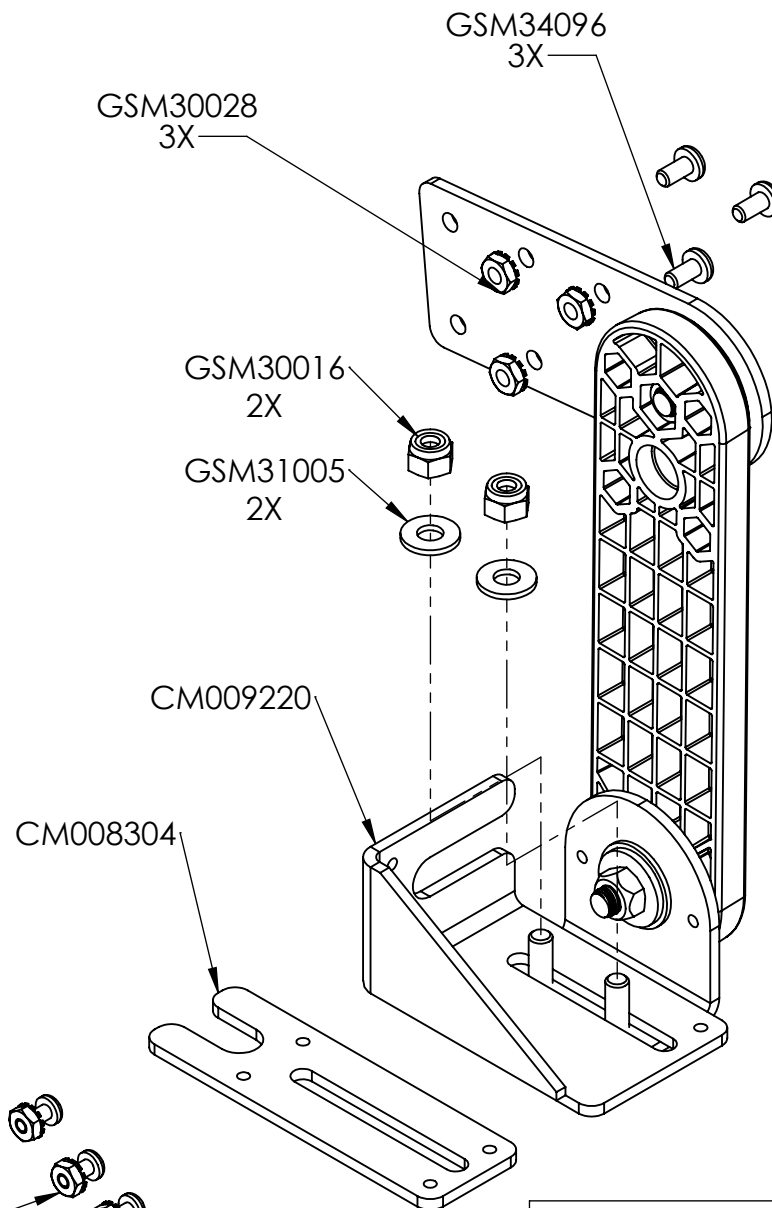

**HAVIS** HAVIS, INC.

75 JACKSONVILLE RD.  
WARMINSTER, PA. 18974  
1-800-524-9900

TITLE:  
INSTALLATION, UNIVERSAL FLEX ARM  
MOUNT

DO NOT SCALE DRAWING

SIZE <b>A</b>	DWG. NO. C-FAM-118-INST	REV 7-25
------------------	----------------------------	-------------

WEIGHT (LB): 2.28

SCALE: 1:2

SHEET 1 OF 1