

INSTALL INSTRUCTIONS C-VS-1800-CHGR-3

18" Vehicle Specific Console for 2021-2023 Dodge Charger

With 12.1-inch large touchscreen display option (order code AV2)

TOOLS NEEDED:

Phillips Screw Driver
Wire Crimping tool

Socket set (Standard & Metric)
T-20 Torx Bit

Wire Cutters
7/16 wrench

<u>QTY</u>	<u>PARTS DESCRIPTION</u>	<u>PART #</u>
1	MPR cover plate	24513
1	Floor mount bracket	24480
1	Passenger side trim panel	24517
1	Driver side trim panel	24516
1	HVAC Support bracket	24518
1	1" Grommet	15840
2	6mm Flange nut	16076
1	O ring for AUX panel	23537
3	1/4" x 3/4" Lag bolt	16359
4	#8-18 x 1/4" screw	16425
2	#10 x 3/4" Sheet metal screw	16437
2	8-32 x 3/8" Machine screws	16495

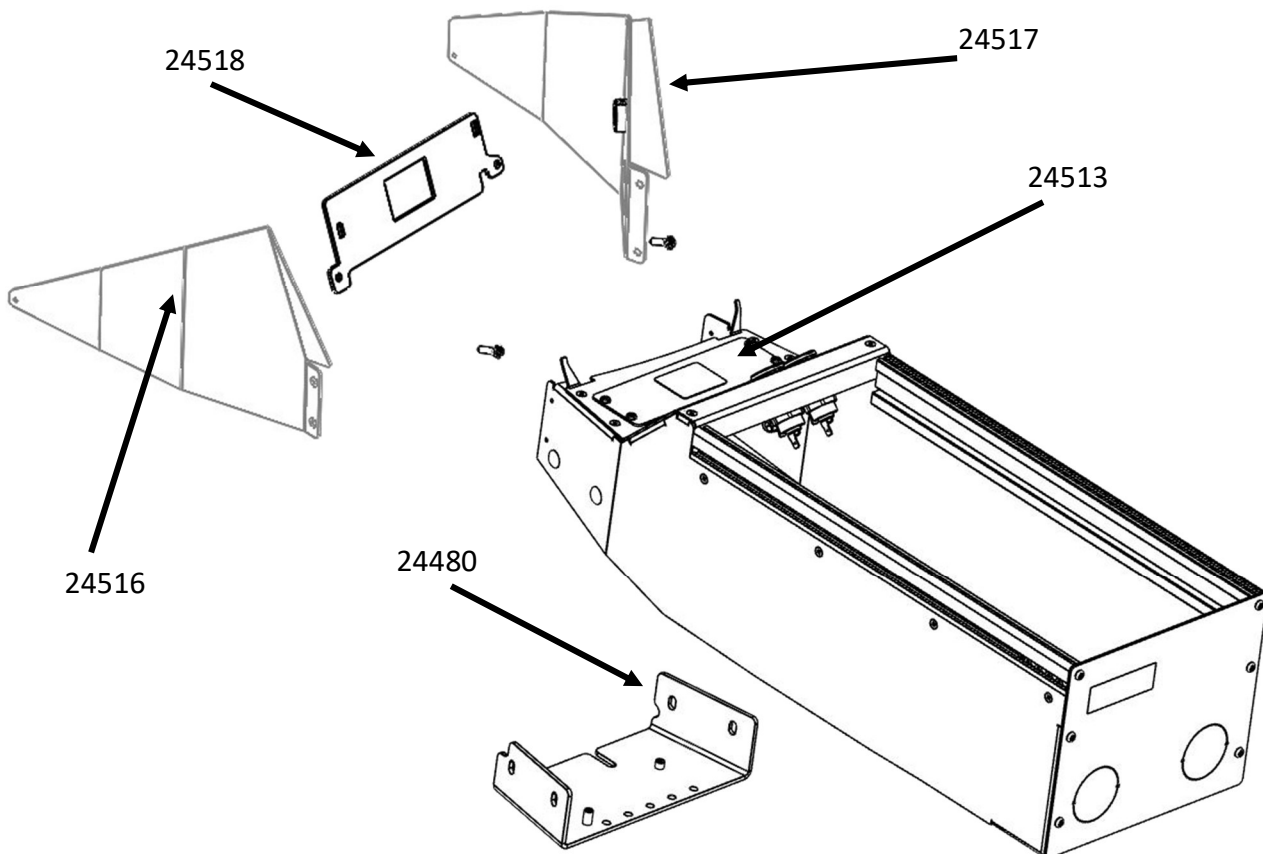



View of Street Appearance Package Charger full length console and Large touch screen display.
(OEM order codes AV2)



Remove cover in front of armrest.



Remove Manual Park Release (MPR) hardware.



Locate two (2) screws under HVAC control.



Remove screws and set aside for future use.



Pull HVAC controller towards rear of vehicle and unplug.



Remove rubber cover inside center console.
Remove four (4) OEM fasteners.



Slide console towards the rear and remove.
Remove vent assembly by lifting and pulling
towards the rear of the vehicle.



Remove dual USB assembly out of the back of the
console.



Remove AUX module from center console.
Remove entire wiring harness from the console.

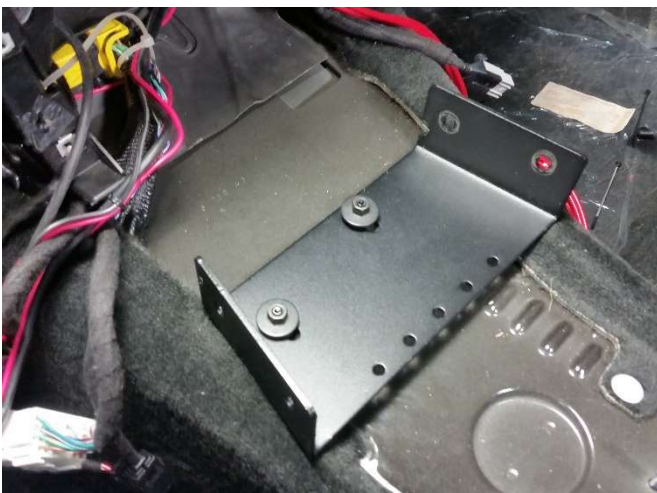

Install front mounting plate to OEM studs with
supplied 6mm flange nuts. Leave loose until later.



Snap HVAC bracket onto the HVAC and radio
controller.



Install the bracket and controller into the dash using #10 x 3/4" sheet metal screws.



Confirm everything is lined up and tighten hardware.



Slide C-VS-1800-CHGR-3 console housing into the vehicle towards the dash.



Line up to front mounting plate and loosely install with 1/4" x 3/4" carriage bolts and serrated nuts.



Install driver side trim panel using #8-18 x 1/4" Phillips flat head screws.



Install the previously removed dual USB assembly into the passenger side trim panel. Install the trim panel using the #8-18 x 1/4" flat head screws.



Attach front panel with eight (8) #8-18 x 1/4" flat head screws.

Tighten all front hardware at this time.



Attach MPR to front mounting plate using supplied 8-32 x 3/8" Screws, split lock washer and flat washer.



Attach cover plate using 8-32 x 3/8" machine screws.



Attach rear of console to floor using 1/4" x 3/4" lag bolts.



Wire and mount control heads as needed.



Installation of C-VS-1800-CHGR-3 console complete.