

Owner's Manual

Havis Rugged USB Keyboard

This owner's manual applies to the following part numbers:

KB-1001

KB-1002

KB-1003



Before Beginning

Havis is pleased to provide this owner's manual to aid in the proper installation and use of the Havis Rugged USB Keyboard.

For questions regarding the set-up of your keyboard, please contact Havis at 1-800-524-9900 or visit www.havis.com for additional product support and information.

WARNING

- NEVER STOW OR MOUNT THE KEYBOARD DIRECTLY IN A VEHICLE AIRBAG DEPLOYMENT ZONE.
- DO NOT USE KEYBOARD WHILE DRIVING.
- DO NOT PLACE METAL OBJECTS OR CONTAINERS OF LIQUID ON TOP OF THE KEYBOARD.
- IF A MALFUNCTION OCCURS, IMMEDIATELY UNPLUG THE KEYBOARD.

CAUTION

- READ ALL INSTRUCTIONS THOROUGHLY BEFORE BEGINNING INSTALLATION.
- DO NOT LEAVE THE KEYBOARD IN A HIGH TEMPERATURE ENVIRONMENT (GREATER THAN 70°C, 158°F).

NOTICE

- FOR DEVICE CONNECTIVITY PURPOSES, THE FOLLOWING SETTINGS ARE RECOMMENDED:
 - "NEVER SLEEP" IS ENABLED IN THE COMPUTER'S POWER OPTIONS.
 - "USB SELECTIVE SUSPEND" IS DISABLED IN THE COMPUTER'S POWER OPTIONS.
 - "POWER SAVING" IS DISABLED IN THE COMPUTER'S POWER OPTIONS.
 - "USB WAKE SUPPORT" IS ENABLED IN THE COMPUTER'S BIOS.

Compatibility

- MAC OS, WINDOWS OS, ANDROID OS
- COMMUNICATION INTERFACE: USB 1.1 OR 2.0

Specifications

| | |
|------------------------------|-----------------------------------|
| Working Voltage | 5V DC (Standard USB) |
| Weight (KB-1001, KB-1002) | 1.7 lbs (0.80 kg) |
| Weight (KB-1003) | 2.0 lbs (0.91 kg) |
| IP Rating (KB-1001, KB-1002) | IP65 |
| IP Rating (KB-1003) | IP54 |
| Operating Environment | -20° C to 70° C (-4° F to 158° F) |
| Storage Environment | -20° C to 70° C (-4° F to 158° F) |

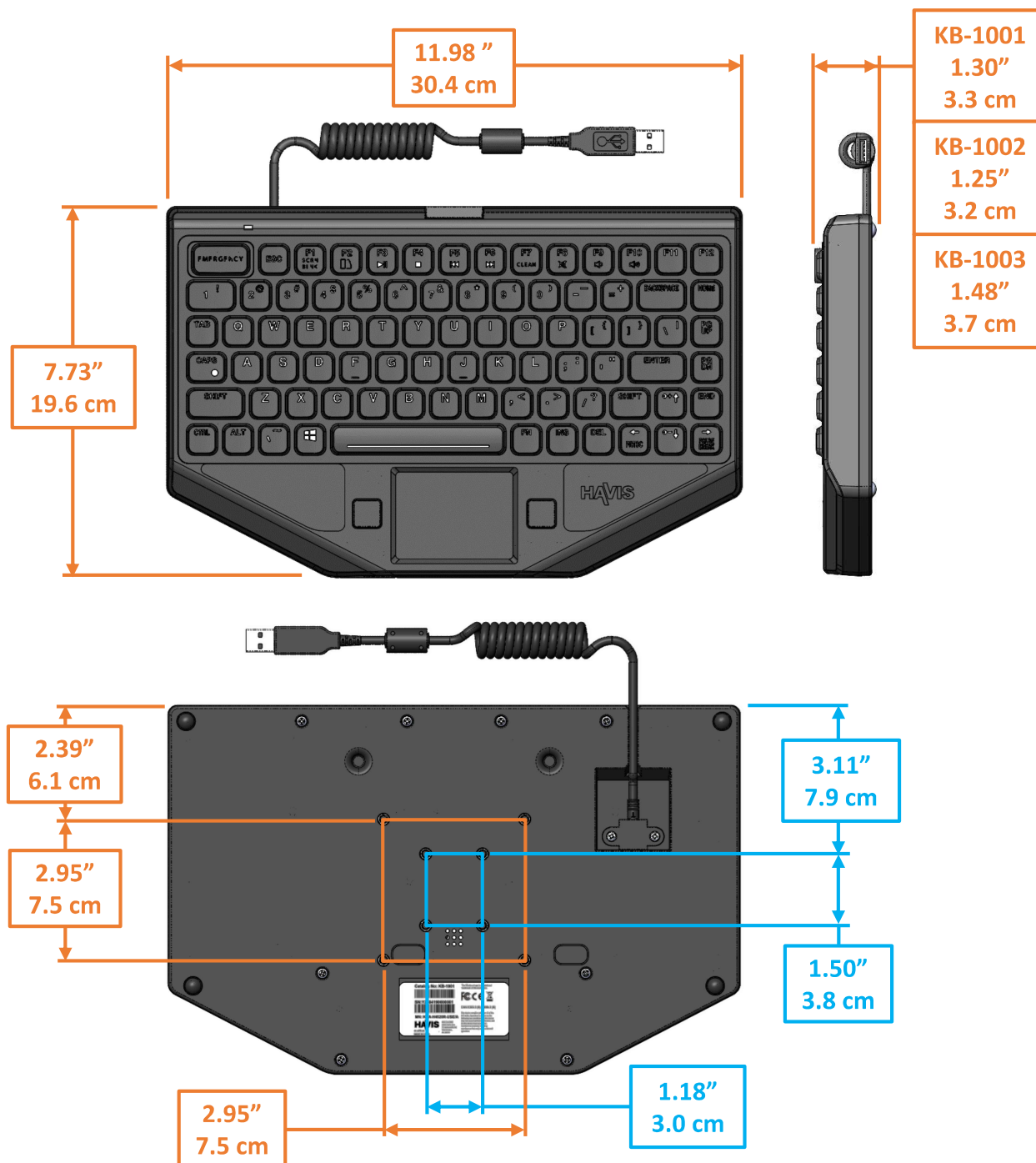

Parts Included

Keyboard

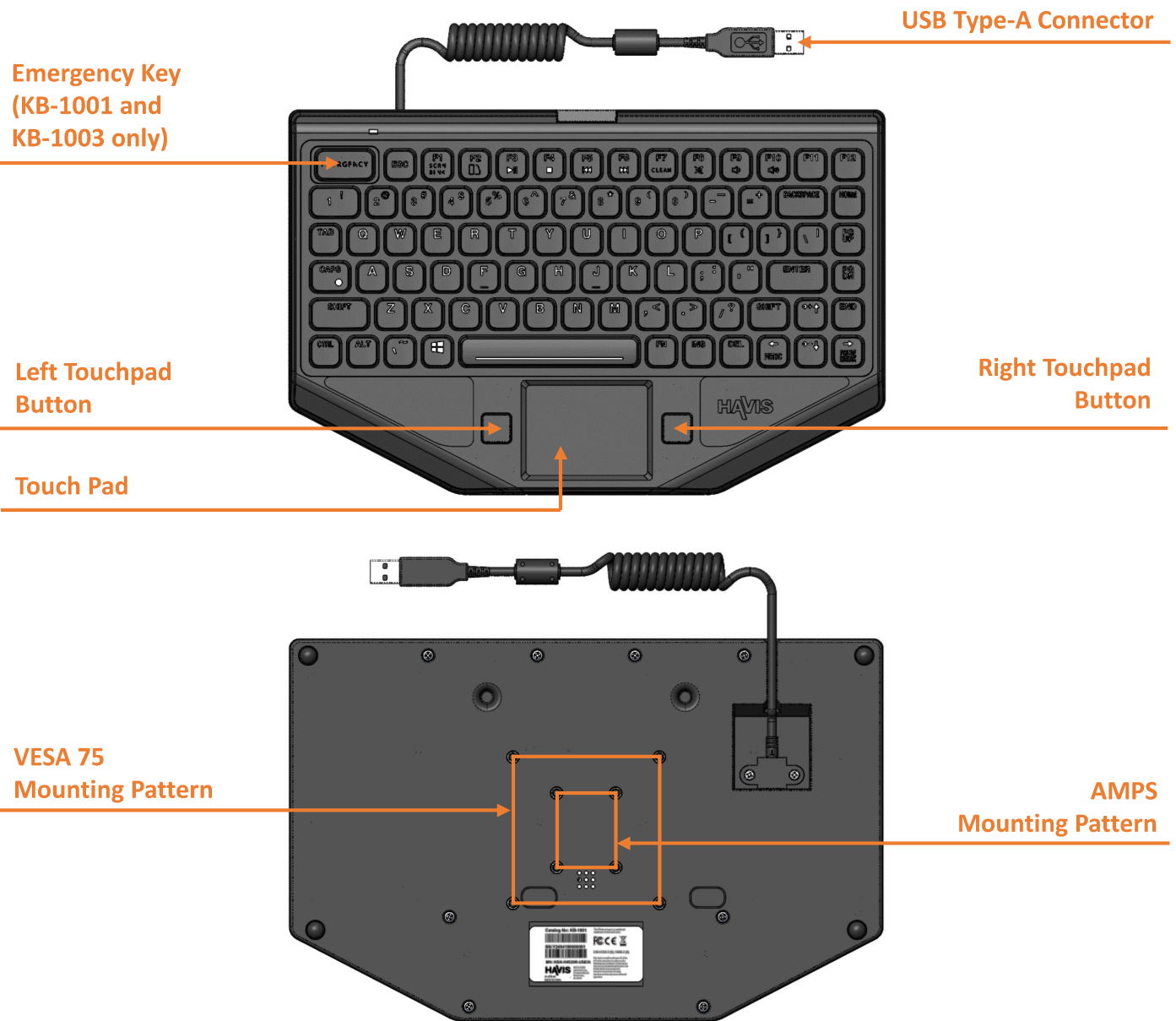

Hardware Kit (HWK-0049)

This hardware kit includes:

1. M4 x 10mm pan head screws (5)
2. Split lock washers (5)
3. Flat washers(5)

Tools required for installation:

- #2 Phillips (to fasten M4 pan head screws)

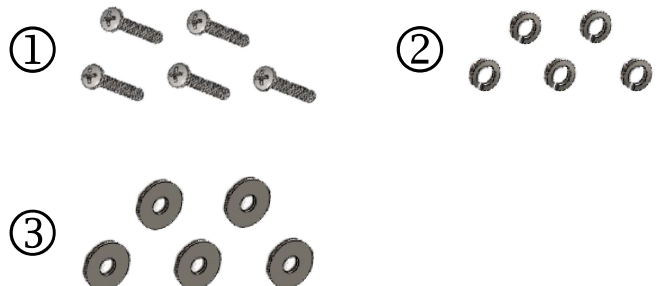

Installation

- 1) It is recommended to use the Havis Rugged USB Keyboard with the Havis Rugged Keyboard Mount (part number C-KBM-201, sold separately). This allows for docking, adjustment, and quick release of the keyboard.
- 2) If not using the Havis Rugged Keyboard Mount, first verify that the mounting location is equipped with either a VESA 75 or AMPS mounting pattern.

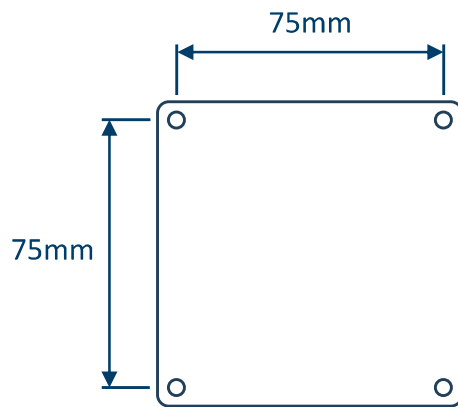

VESA 75

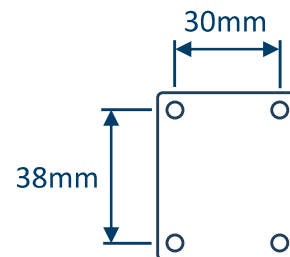

AMPS

- 3) Fasten the keyboard to the mount as per the required mounting pattern. Use the M4 pan head screws (hardware kit item #1). Torque screws to 20 in-lbs (2.3 Nm) \pm 10%.

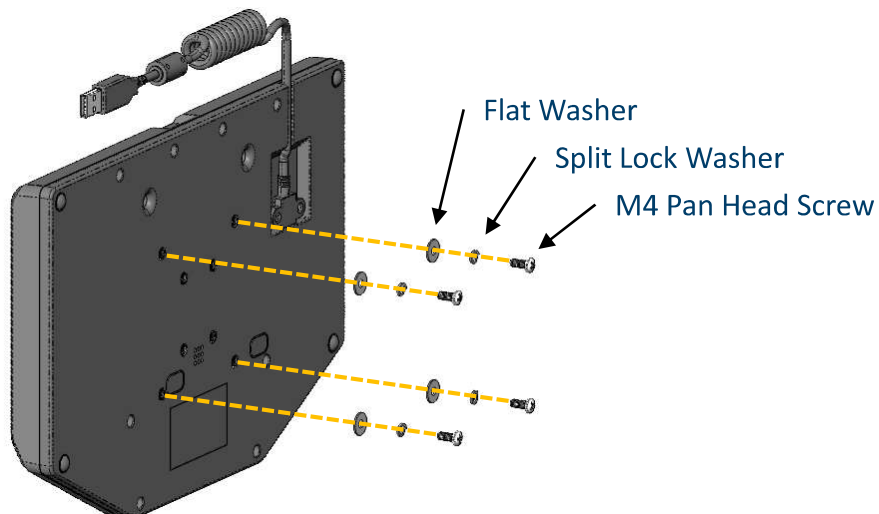

- 3) Plug the keyboard's USB connector to the computer or docking station. Turn the computer on. Computer will automatically detect and install drivers after initiation.

Keyboard Functions

Backlight

- **FN + DOWN ARROW KEY** - Decreases backlight brightness.
- **FN + UP ARROW KEY** - Increases backlight brightness.

Emergency (KB-1001 and KB-1003 only)

- **EMERGENCY KEY** - Sends distress signal to connected computer.
- **SHIFT + F1** - Same command as emergency key. Sends distress signal to connected computer.

Screen Blanking

- **FN + F1** - Turns the screen off. This function is OS and software dependent.

Screen Rotate

- **FN + F2** - Rotates the screen. This function is OS and software dependent.

Cleaning

- **FN + F7** - Temporarily disables the keyboard for 60 seconds. Used for cleaning the keyboard.

Volume

- **FN + F8** - Mutes sound.
- **FN + F9** - Decreases sound volume.
- **FN + F10** - Increases sound volume.

Touch Pad

- **Left mouse click** - Single tap the touchpad OR press the left touchpad button.
- **Left mouse hold** - Double tap and hold the touchpad OR hold down the left touchpad button.
- **Right mouse click** - Press the right touchpad button.
- **Right mouse hold** - Hold down the right touchpad button.
- Touchpad is capacitive.
- Two finger functions are not supported.
- Pinch-to-zoom is not supported.

Cleaning

The Havis Rugged USB Keyboard can be cleaned with a soft cloth and a non-corrosive cleaning solvent. A mild soap and water mix would suffice as well. Before cleaning, hit **FN + F7** to temporarily disable the keyboard for 60 seconds.

NOTICE

- **DO NOT USE A STIFF BRUSH.**
- **AVOID INTENSE SCRUBBING.**
- **DO NOT USE CORROSIVE CLEANING SOLVENTS.**

Regulatory Information

Canada

CAN ICES-3 (B) / NMB-3(B)

Class B equipment

This class B digital apparatus meets all requirements of the Canadian Interference-Causing Equipment Regulations.

Équipement de classe B

Cet appareil numérique de la classe B respecte toutes les exigences du Règlement sur le matériel brouilleur du Canada.

United States of America

FCC Compliance

This device complies with part 15 of the FCC Rules. Operation is subject to the following two conditions: (1) This device may not cause harmful interference, and (2) this device must accept any interference received, including interference that may cause undesired operation.

Note: This equipment has been tested and found to comply with the limits for a Class B digital device, pursuant to part 15 of the FCC Rules. These limits are designed to provide reasonable protection against harmful interference in a residential installation. This equipment generates, uses and can radiate radio frequency energy and, if not installed and used in accordance with the instructions, may cause harmful interference to radio communications. However, there is no guarantee that interference will not occur in a particular installation. If this equipment does cause harmful interference to radio or television reception, which can be determined by turning the equipment off and on, the user is encouraged to try to correct the interference by one or more of the following measures:

- Reorient or relocate the receiving antenna.
- Increase the separation between the equipment and receiver.
- Connect the equipment into an outlet on a circuit different from that to which the receiver is connected.
- Consult the dealer or an experienced radio/TV technician for help.

Changes or modifications not expressly approved by the party responsible for compliance could void the user's authority to operate the equipment.

Responsible party (contact for FCC matters only):

Havis, Inc.
75 Jacksonville Road
Warminster, PA 18974
havis.com/contact-us

Regulatory Information *(continued)*

European Union

Waste Electrical and Electronic Equipment (WEEE)

Electrical and electronic equipment (EEE) contain materials, components and substances that can be hazardous and harmful to human health and the environment when WEEE is not disposed of properly.

Products marked with the "crossed-out wheeled bin" symbol are EEE. The crossed-out wheeled bin symbolizes that WEEE must not be disposed of together with unsorted household waste, but must be collected separately.

For this purpose, all municipalities have established collection schemes where WEEE can be handed in, free of charge, by citizens at recycling stations or other collection points or collected directly from households. Further information should be obtained from the municipality's technical administration.



This symbol on the product or on its packaging indicates that the product must not be disposed of with normal household waste. Instead, it is your responsibility to dispose of your waste equipment by arranging to return it to a designated collection point for the recycling of WEEE. By separating and recycling your waste equipment at the time of disposal, you will help to conserve natural resources and ensure that the equipment is recycled in a manner that protects human health and the environment. This product is EEE and shall not be placed in the municipal waste after end of its life. This device should be handled properly and handed over to appropriate collection places or to authorized companies.

Conformité Européene (CE) Mark



The CE marking on a Havis product indicates conformity to the provisions of applicable European Union (EU) directives. The EU Declaration of Conformity (DoC) is the manufacturer's declaration that the product complies with those directives.

Related Products

Havis offers a wide variety of accessory products specifically for use with our rugged keyboards. For more information or to order, please visit www.havis.com.



C-KBM-201

Rugged Keyboard Mount

Quick dock and undock your Havis Rugged USB Keyboard with this equally rugged mount. No tools or hardware required.



C-MD-204

Low Profile Tilt Swivel Motion Device

Easy-adjust and quick-release handles lock down the desired position and allow for easier operation of your equipment.



MD-ARM-0603

Swivel Arm Mount

Mounts independently to the side of your console for simple positioning of your equipment.



MH-3001

Universal Under Seat Forklift Keyboard Mount

This universal mount clamps securely underneath your forklift seat rail. No drilling required