

INSTALLATION INSTRUCTIONS

C-DMM-3007 Flip up Dash Monitor Mount

2019-2025 Chevrolet Silverado 1500 / GMC Sierra 1500 (Forth generation)

2020-2025 Silverado / Sierra 2500HD and 3500HD Pickup (Forth generation)

Not compatible with interior in vehicle with 13.4" Diagonal Infotainment 3 Premium System

TOOLS REQUIRED:

Ratchet set	Dash panel removal tool	Open end wrench 7/16"
Socket set	Phillips screwdriver	T-15 Torx driver bit

HARDWARE:

<u>QTY</u>	<u>DESCRIPTION</u>	<u>PART#</u>
2	Upper mounting bracket	CM009473
1	Side mounting bracket	CM009474
1	VESA rotation plate	CM010471
1	PVC washer	CM010648
2	1/4" x 3/4" Carriage bolts	GSM32000
3	10-32 x 1/2" Machine screw	GSM33118
3	#10 Flat washer	GSM31003
1	10-32 Keps nut	GSM30028
2	1/4" Flat washer	GSM31005
2	1/4" Nylon washer	CM86600
2	1/4" Nylock nut	GSM30016-1

Notes:

The C-DMM-3000 swivel plate accepts C-MM-301 offset bracket used with C-MM-2XX adaptors. C-MM-2XX series adaptor brackets are not needed for most VESA 75 and other Havis Docking Station mounting applications.

CM010471 VESA rotator plate gives additional positioning options, but is not required depending on mounting preference.

Always!

- Read all instructions before installing any Havis, Inc. products.
- Use hardware provided with install kit

C-DMM-3007

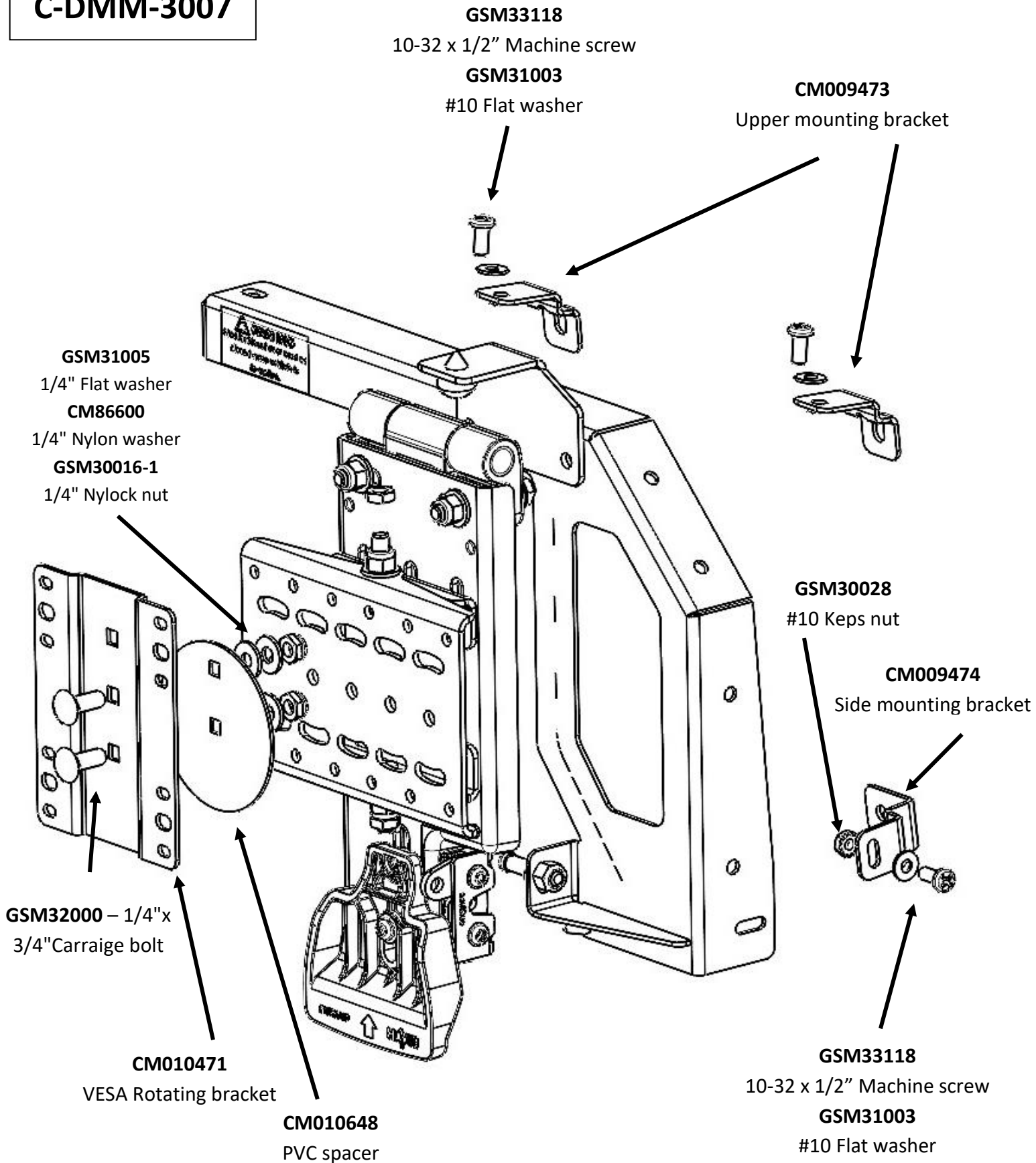



View of Silverado dash prior to installation



Remove trim around radio display and vents.

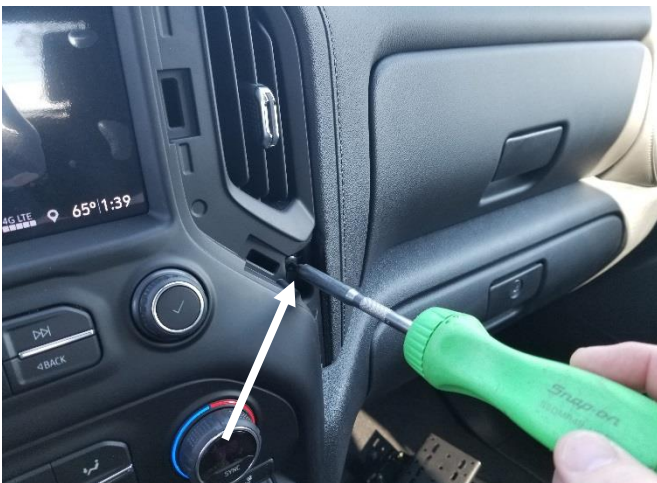

Remove the screw on the passenger side of the dash and two screws at the top of the dash.
(T-15 Torx driver)

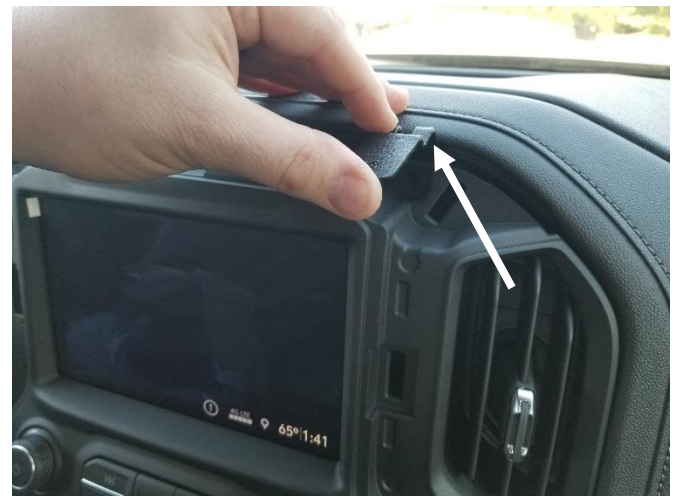

Unclip dash just enough to slide the upper mounting brackets behind the trim.



Repeat process for the side mounting bracket



Snap trim back in and reinstall previously removed OEM screws.



Snap trim back into place.



Attach the DMM-3007 frame to the upper mounting brackets first using 10-32 x 1/2" screws and #10 flat washers.



Loosely start the hardware for the side mounting bracket. Tighten the hardware while pressing the frame against the dash.



Confirm frame is tight to the dash and moves freely up and down.



Determine desired position for your specific computer and attach to DMM swivel plate using 1/4"x 3/4" carriage bolts, PVC spacer, nylon washers, steel washers, and nylock nuts. Tighten so that the dock rotates smoothly. Tighten so dock is snug, but rotates smoothly.



Run and wire tie harness down passenger side of frame to complete Installation.