

K9-F29-XL INSTALLATION INSTRUCTIONS

K9 Kit for 2020-2024 FORD EXPLORER

TOOLS Needed:

Phillips Screw Driver	Trim panel removal tool	Caulk Gun	Drill & drill bits
Standard Socket set	Wire Cutters /Crimpers	Metric Socket set	

PARTS & HARDWARE:

<u>QTY</u>	<u>DESCRIPTION</u>	<u>ITEM #</u>	
1	Front bulkhead with sliding door	18879 – White	18880 - Black
2	Lower “B” pillar bracket	18848	
2	Upper “B” pillar bracket	18849	
1	Rear bulkhead	23102 – White	23384 - Black
1	Rear bulkhead cross support bracket	18846 – White	18847 - Black
1	Rear perforated diamond section	18845	
1	D/S Front floor section	22978 – White	23181 - Black
1	P/S Front floor section	22979 – White	23182 - Black
1	Driver side floor step	18803 – White	18804 - Black
1	Passenger side floor step	18805 – White	18806 - Black
2	Hot-N-Pop gas spring hole cover	18858 – White	18859 - Black
1	Angled rear floor section	23105 – White	23387 - Black
1	Front floor bracket	23099	
1	Middle floor bracket	23100	
1	Rear floor bracket	23101	
1	D/S cargo area floor bracket	23108	
1	P/S cargo area floor bracket	23109	
1	Rear cargo closeout	23110	
1	Rear trim adaptor “L” bracket	23391	
1	Ceiling	18811 – White	18812 - Black
2	Ceiling air duct vents	18517 – White	18518 - Black
1	Passenger side rear wall	23104 – White	23386 - Black
1	Passenger side upper trim panel	18835 – White	18836 - Black
1	Passenger side / side ceiling trim panel	18843 – White	18844 - Black
1	Passenger side lower trim panel	23106 – White	23388 - Black
1	Driver side rear wall	23103 – White	23385 - Black
1	Driver side upper rear trim panel	18831 – White	18832 - Black
1	Driver side / side ceiling trim panel	18839 – White	18840 - Black
1	Driver side lower filler trim panel	23107 – White	23389 - Black
1	Rubber Mat	23393	
2	Electronics access cover	18856 – White	18857 - Black
1	Driver side door panel	14607 – White	14608 - Black
1	Passenger side door panel	14621 – White	14622 - Black
2	Door panel speaker cover	14628	
1	Driver side hinged window guard	21249	
1	Passenger side hinged window guard	21250	
2	Dome Light Kit	K9-A-106	
1	Silicone caulk (sealant)	20011 – White	20012 - Black
<u>23396 Hardware kit (includes the following)</u>			
48	1/4” serrated flange nut	16086	
36	1/4" x 3/4” Carriage bolt – SS	16235	
66	1/4" x 3/4” Phillips pan head bolt - SS	16618	
68	1/4" Flat washer - SS	16154	
12	1/4” x 1/2” Carriage bolt	16233	
24	#10 Sheet metal screws	16655	
1	3/4” Velcro loop	15837	
2	1/4" x 1.25” Fender washer	16131	

K9-F29-XL Assembly

Installation Notes:

- Read all instructions before installing any Havis, Inc. products.
- Use hardware provided with install kit.

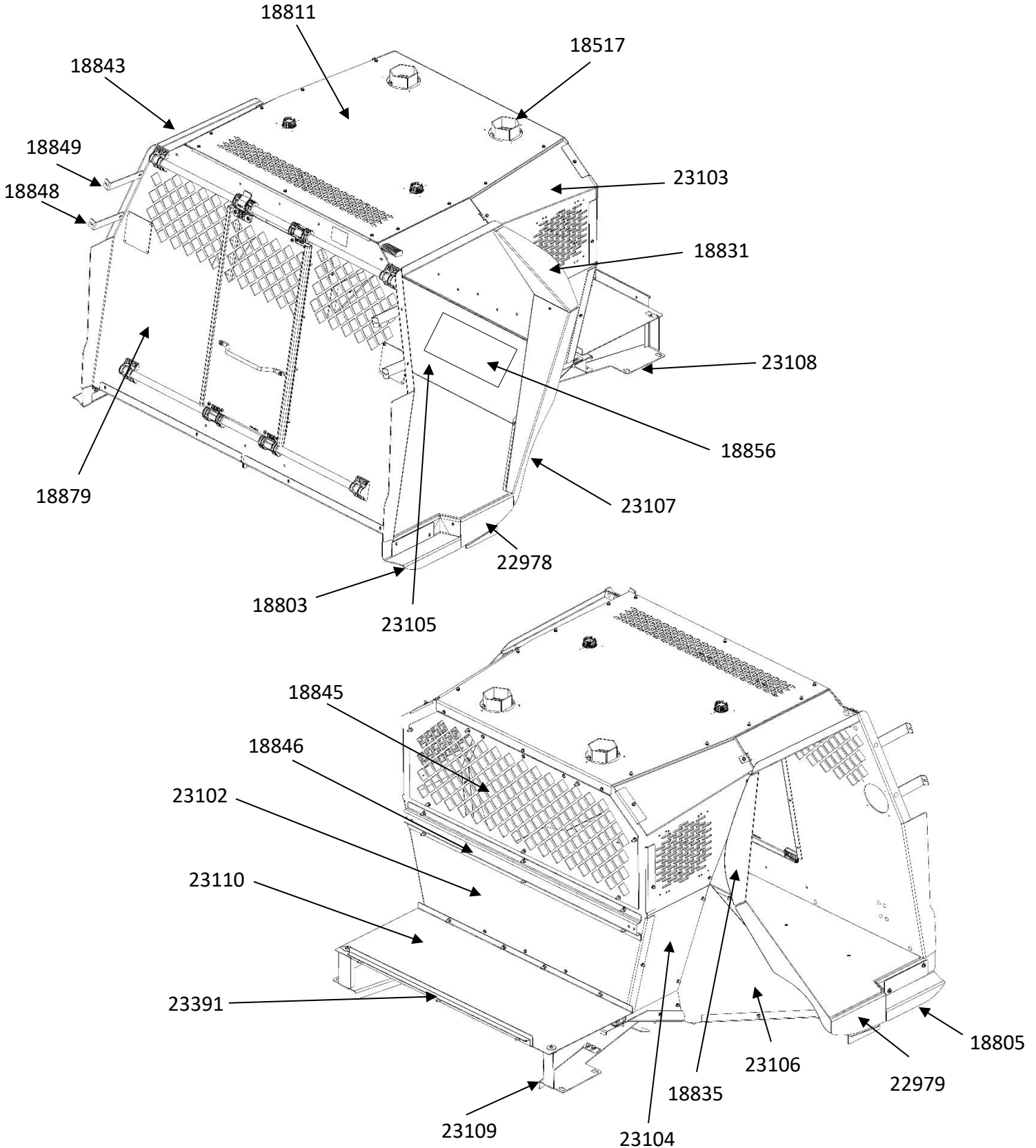



Remove the rear passenger, door panels first. Behind the door open paddle handle and grab handle, remove plastic cover and 10mm head bolts. Remove two 7mm head fasteners from bottom of door.

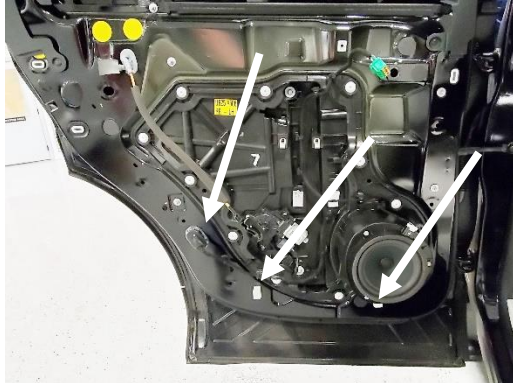

Remove (2) plastic screw retainers from bottom of door. *These will not be reused.*
Note: Push in oval grommet with wire harness so K9 door panel lays more flat when screwed on. Make sure harness does not interfere with internal door parts.



Remove door speaker. (7mm socket)
Prior to next step, attach Speaker cover to door panel with 1/4"x3/4" carriage bolts and serrated nuts.

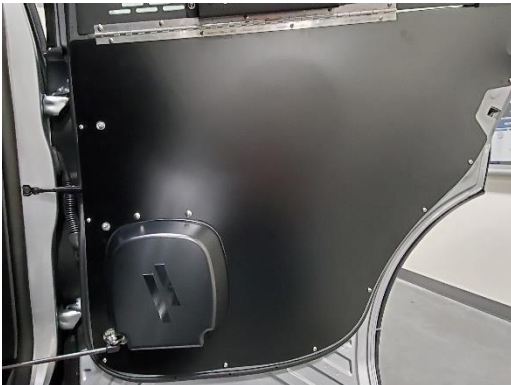

Attach speaker pods to door panels using supplied carriage bolts and serrated nuts. Place K9 kit door panel onto door. The top will hook onto rubber molding.

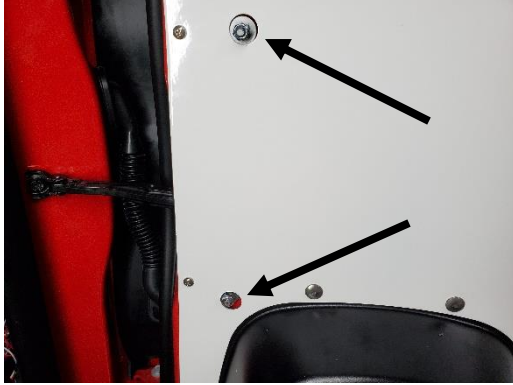

Be sure to center cutouts in door panel over OEM window track studs. Drill mounting holes with 1/8" drill bit. Attach door panels with supplied #10 x 1/2" Phillips pan head sheet metal screws.



If desired, the window studs may be cut off or grinded flush to the OEM nuts.



NOTE: Window guards are shipped flat. On the edge of a work bench, bend a contour in the middle of the guard so it will fit tight against the window frame.



Position window guard with hinge assembly inside window frame and attach hinge to door panel pre-punched holes with supplied # 10 x 1/2 Phillips pan head sheet metal screws.



With upper mount bracket attached to window guard, mark mounting hole locations in upper door / window frame. Drill 5/32 holes. **Note: OEM black trim stays on window frame.**



Attach upper mount bracket to window frame with supplied #10 x 1/2 Phillips flat head sheet metal screws.



Door Panel and Window Guard complete.
See last page of instruction if mounting fan to window guard.



Remove back seats and set aside.
Set hardware aside to use later on.



Remove door sill plates.
These will not be reused.



Remove spare tire access cover.



Unbolt third row seats.



Unplug sensor from driver's side of third row seats. Remove seats and set aside.



The (3) seat belts on the back seats have built in sensors that will turn on an indicator on the dash. These must be removed from the OEM seats.

(T-50 Torx)

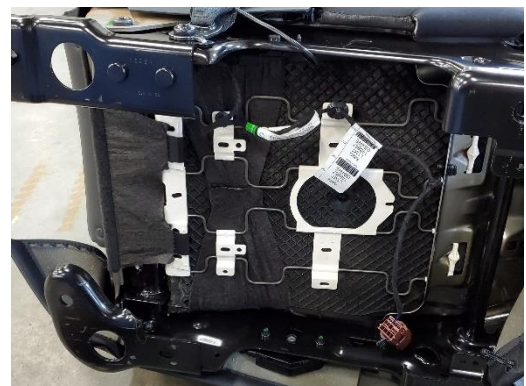

Remove the seat belt harness from the bottom of the seat.

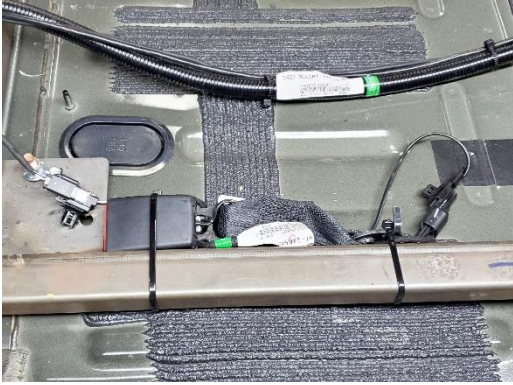

Wire tie the removed seat belts to the OEM cross brace and plug back in.
Note: Make sure to connect back into the original plug. Double check that the pins in plugs did not come loose.



Remove the seat belts from the third row seats. Both seat belts will need to be removed.

T-50 Torx

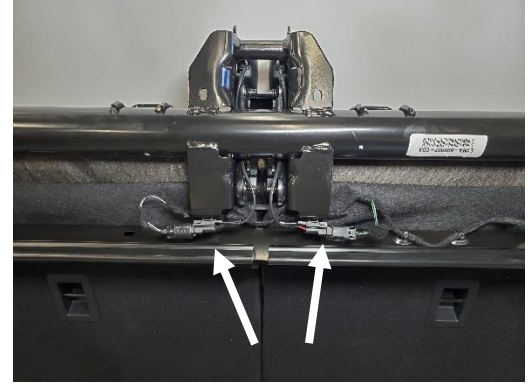

Unplug harness from the underside, middle of the third row seats to remove seat belt receivers.



Remove harness from seats. Plug harness in to plug on driver side of cargo area. Plug seat belts back in.



Attach rear floor bracket using previously removed seat bolts.

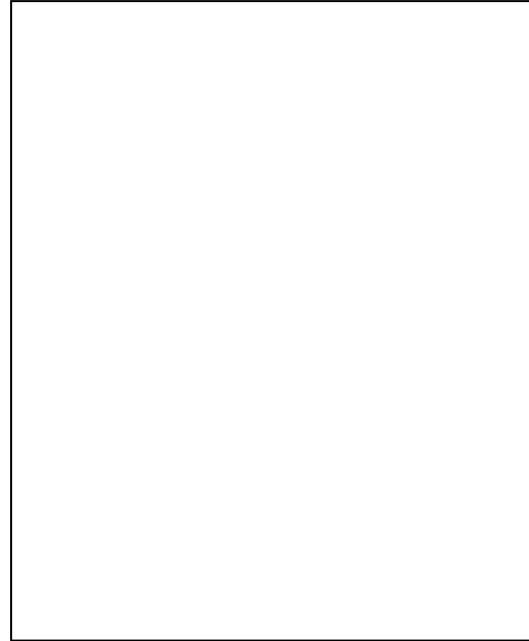

Use OEM seat bolts to attach K9 kit front floor bracket to OEM seat mount locations.



Attach rear floor side mounting brackets in rear of vehicle using holes and hardware from third row seat.

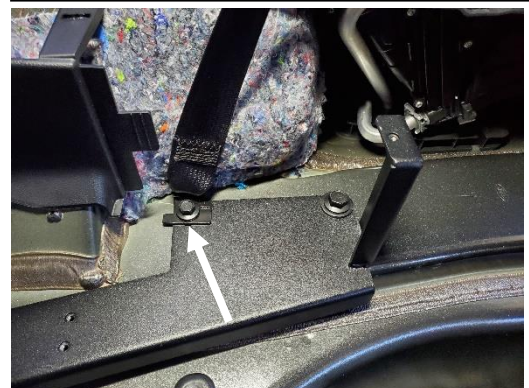

Reattach seat belt to forward hole making sure the belt is not twisted.



Attach rear cross support to both rear floor brackets using (4) 1/4" x 3/4" Phillips head bolts and flat washers.



Before the floor is installed, both sides must be bolted together. Use (4) 1/4" x 3/4" carriage bolts and serrated nuts.



Attach side floor steps.



Attach with (3) 1/4" x 3/4" Phillips head bolts and flat washers.



Attach cover plate with supplied hardware.

Note: Run wiring for dome light, rear fan and other equipment prior to installing floor.



Place floor into vehicle and loosely attach to front and middle floor brackets with 1/4" x 3/4" Phillips head bolts and flat washers.



Place rear angled floor section into vehicle. Attach to forward floor and rear bracket with 1/4" x 3/4" Phillips head bolts and flat washers.

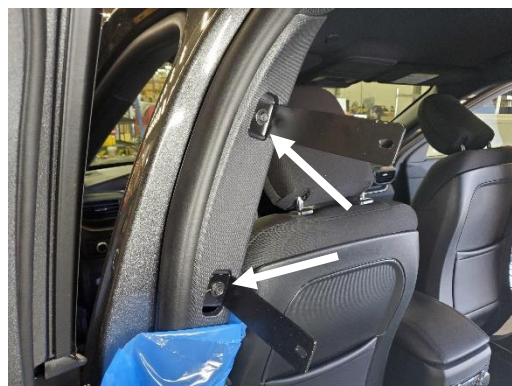

Prior to front bulkhead installation, remove OEM "B" pillar grab handles. Attach upper front bulkhead "L" brackets to "B" pillar with OEM grab handle screws. (Longer bracket on top and "L" flange facing out as shown)



With the help of a second person, carefully place front bulkhead into vehicle.

Take care not to scratch floor.



Attach bulkhead to floor using (4) 1/4" x 3/4" carriage bolts and serrated nuts.



Loosely attach front bulkhead to "B" pillar brackets with 1/4" x 1/2" carriage bolts and serrated flange nuts. Bracket goes on inside of bulkhead flange.



Carefully lay rear bulkhead on flat work surface prior to installation.



Place rear window screen and support brace on backside of bulkhead.

Flange at bottom of bulkhead should be facing up.



Attach screen and brace with 1/4" x 3/4" carriage bolts and serrated nuts. Smooth carriage bolt heads go on dog side of bulkhead.

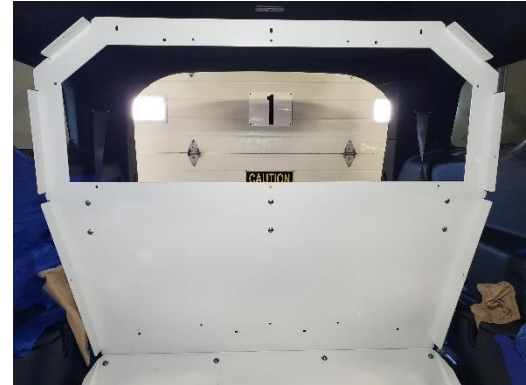

Carefully place rear bulkhead into vehicle and line up to holes in floor.

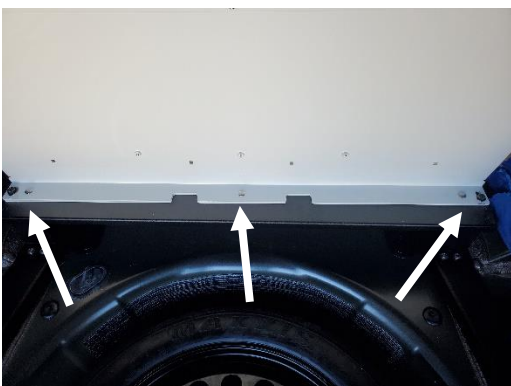

Attach rear bulkhead to floor and floor bracket with (3) 1/4" x 3/4" carriage bolts and serrated nuts.



Attach rear side wall into kit with 1/4" x 3/4" Phillips head bolts and flat washers.

Repeat for other side

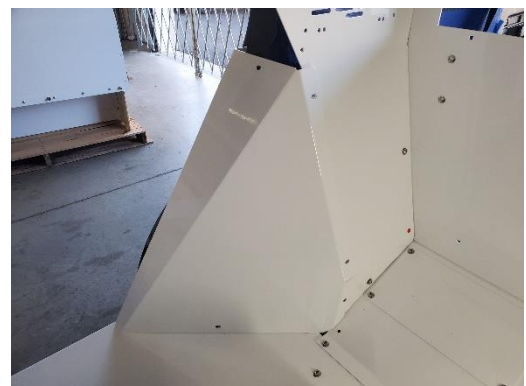

Attach lower trim panel with 1/4" x 3/4" Phillips head bolts and flat washers.

Repeat for other side



Attach upper rear trim panel to rear side wall and lower trim panel with 1/4" x 3/4" pan head Phillips bolts and flat washers.



Attach upper trim panel with 1/4" x 3/4" Phillips head bolts and flat washers. Forward hole through front bulkhead uses a 1/4" x 3/4" carriage bolt and nut.

Repeat for other side



Place rear cargo filler onto rear mounting brackets and line up to rear wall of kit. Attach to rear wall of kit using (4) 1/4" x 3/4" carriage bolts and serrated nuts.

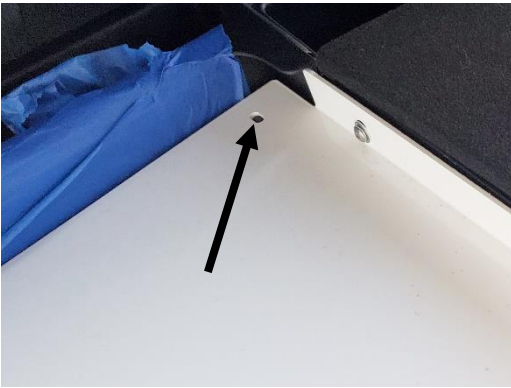

Install 1/4" x 3/4" Phillips head bolts and flat washers in rear corners of cargo filler.



Attach rear cargo floor adaptor bracket to rear cargo filler plate using (3) 1/4" x 3/4" Phillips head bolts, flat washers and serrated nuts.



Add Velcro circles to rear cargo floor adaptor "L" bracket.



Place rear OEM floor in vehicle and line up to bracket. Press to secure to Velcro circles.



Confirm floor is lined up and square.



Tighten all hardware



Example mounting location for the optional air circulation fan.
K9-A-102



Neatly silicone / caulk the lower seams to shed water out of vehicle.

Note: The floor is designed to minimize the need for sealant. Caulk (sealant) is mostly needed where the floor meets the door sill and lower filler panels.



Driver side window guard with optional 10" fan kit shown.

Fan and window mount kit part number **K9-A-104**

****Kit includes K9-A-301 fan and WGI007335 mount with hardware****

K9-A-104 also works on Passenger side window guard.



Confirm smooth slide and lock function on front egress door.



Installation is now complete.
Insert shown with optional K9-A-108 divider.

Dog sold separately