

# INSTALLATION INSTRUCTIONS

## C-DMM-3005 Flip up Dash Monitor Mount

### 2015-2017 Dodge Charger Police Pursuit with mini display

### 2018-2023 Dodge Charger Police Pursuit and Charger SXT with 7-inch display

***\*\*Does NOT work in vehicle with 12.1 inch Integrated Touch Screen display\*\****

#### TOOLS REQUIRED:

Ratchet Wrench	Dash panel removal tool	Open End Wrench - 7/16"
Socket Set	Phillips screwdriver	

#### **HARDWARE and PARTS:**

<u>QTY</u>	<u>DESCRIPTION</u>	<u>PART#</u>
1	Driver side support bracket	CM009445
1	Passenger side support bracket	CM009444
2	Side mounting bracket	CM009446
4	10-32 x 3/8" Machine screw	GSM33117
4	#10 Star washer	GSM31034
4	10-32 Nylock nut	GSM30015
4	#10 Flat washer	GSM31003
1	VESA rotator plate	CM010471
2	1/4" x 3/4" Carriage bolts	GSM32000
1	PVC washer	CM010648
2	1/4" Plastic washer	CM86600
2	1/4" Steel washer	GSM31005
2	1/4" Nylock nut	GSM30016-1

#### **Notes:**

The C-DMM-3000 swivel plate accepts C-MM-301 offset bracket used with C-MM-2XX adaptors. C-MM-2XX series adaptor brackets are not needed for most VESA 75 and other Havis Docking Station mounting applications.

CM010471 VESA rotator plate gives additional positioning options, but is not required depending on mounting preference

#### **Always!**

- Read all instructions before installing any Havis, Inc. products.
- Check for obstructions (Wires, brake lines, fuel tank, etc.) before drilling any holes!
- Use hardware provided with install kit

## C-DMM-3005 Assembly

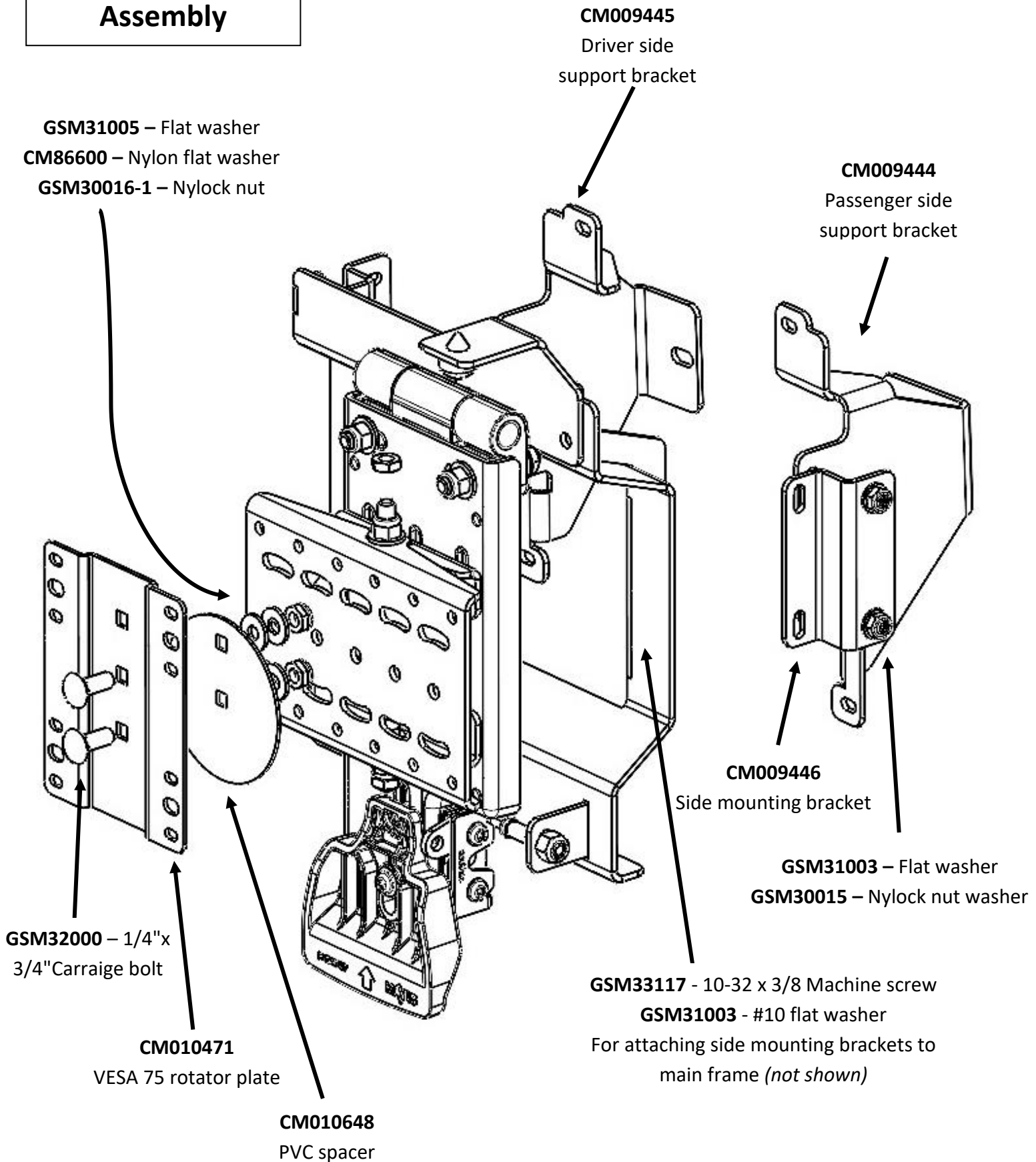





Dodge Charger Dash  
Prior to installation.



Gently pry along the dash with a flat blade panel  
removal tool. Slowly working along the frame.



Dash panel partially removed.



Temporarily remove radio touch screen.

**NOTE:** The touchscreen has a theft deterrent system built  
in so we suggest leaving the main power plugged in.

Phillips screwdriver.



Temporarily remove two (2) OEM screws and  
attach support bracket with OEM screw as shown.  
10mm socket.



Repeat process for both sides.  
Make sure brackets fit around radio snug.





Reinstall the radio touch screen using the previously removed OEM hardware.



Attach side mounting brackets to the side support brackets using 10-32 nylock nuts and flat washers.



Repeat process for driver side and tighten hardware.



Carefully reinstall previously removed dash panel.



Make sure the side mounting brackets are even along the dash and the dash is fully seated back into place.



Attach main C-DMM-3005 frame to the side support brackets using 10-32 x 3/8" screws and star washers.



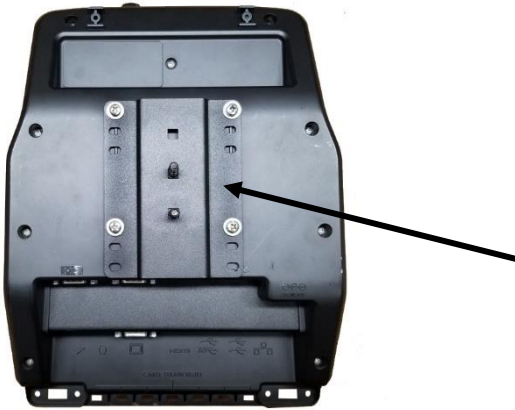

Position VESA plate on back of Device as desired. Attach VESA plate with carriage bolts to the back of the dock. The gray PVC washer will go between this bracket and the DMM swivel plate.



Determine desired position for your specific computer and attach to DMM swivel plate using 1/4"x 3/4" carriage bolts, PVC spacer, nylon washers, steel washers, and nylock nuts. Tighten so that the dock rotates smoothly.



Confirm smooth operation of the C-DMM-3005.



Attach the dock to the mounting bracket (with hardware supplied with dock). Run wires as desired.



Double check all hardware, latching and wire harness clearance.



Installation is now complete.