

INSTALLATION INSTRUCTIONS

SBX-5011 mounting base for SBX-1000 series drawers

2021-2022 Chevrolet Tahoe PPV

(includes SBX-5008 & SBX-4013)

TOOLS REQUIRED:

Standard Socket Set

5/32" Allen Key/hex bit

T50 Torx

Metric Socket Set

PARTS and MOUNTING HARDWARE:

<u>QTY</u>	<u>DESCRIPTION</u>	<u>ITEM#</u>
<u>SBX-5008 Floor mount</u>		
2	Rear Floor Brackets	24807
1	DS Front Floor Bracket	24809
1	PS Front Floor Bracket	24810
1	Base Plate	25356
<u>SBX-4013 (12.6" Risers)</u>		
1	Driver side riser bracket	25358
1	Passenger side riser bracket	25359
1	Tall filler panel	25357
<u>Hardware for both SBX-5008 and SBX-4013</u>		
2	1" Hole Plug	15803
14	1/4-20 x 1/2" Flat head Screw with Patch	25522
2	M10x1.5 x 45mm Hex Bolt	16518
4	1/4 Flat washer	16122
4	1/4 Lock washer	16142
4	1/4-20 X 3/4 PPHMS	16404
4	5/16" Flat washer	16123
4	5/16" Lock washer	16143
4	5/16-18 X 1 HHCS	16336
3	#10 X 1/2 PPHSMS	16655
4	5/16" x 3/4" Thread forming screw	16245

Always!

- Read all instructions before installing any Havis, Inc. products.
- Use hardware provided with install kit

**SBX-5011
Assembly**

Front of
vehicle

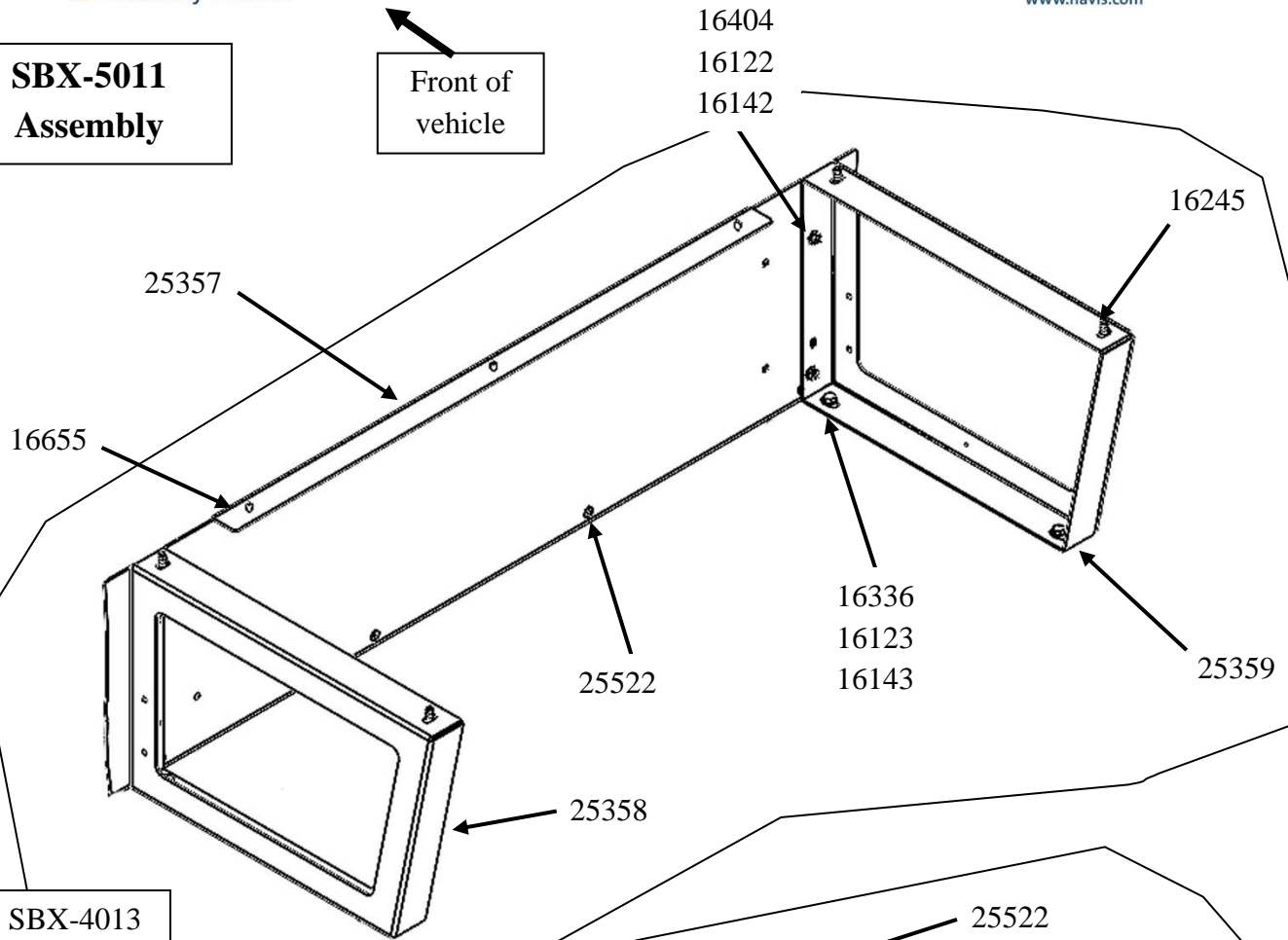

SBX-4013

SBX-5008

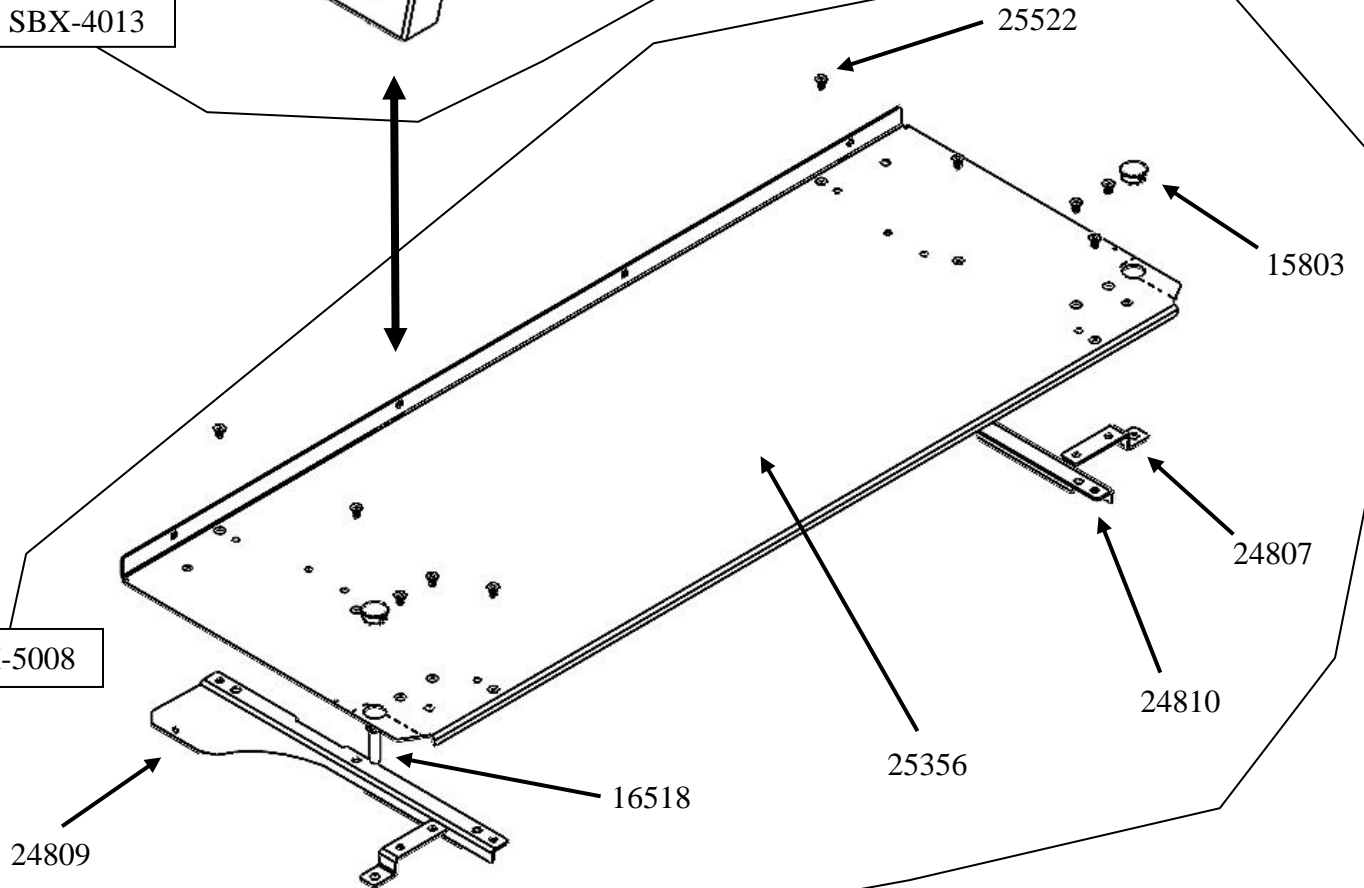



Loosely attach rear floor brackets to both sides of the base plate using supplied 1/4" x 1/2" Flat head bolts.



NOTE: Remove padding if necessary to allow supplied M10 bolt to pass through to OEM threaded hole. Repeat for both sides. Front brackets can sit on the padding.



Loosely attach rear floor brackets to rear seat belt anchors on each side with OEM 12mm Torx bolts. Add 1" hole plug after hardware is tightened.



Determine 3rd row seat bolt locations in floor and loosely attach front floor brackets with supplied M10 bolts. Temporarily remove OEM M12 bolts from the rear seat belt anchor locations. (T50 Torx)

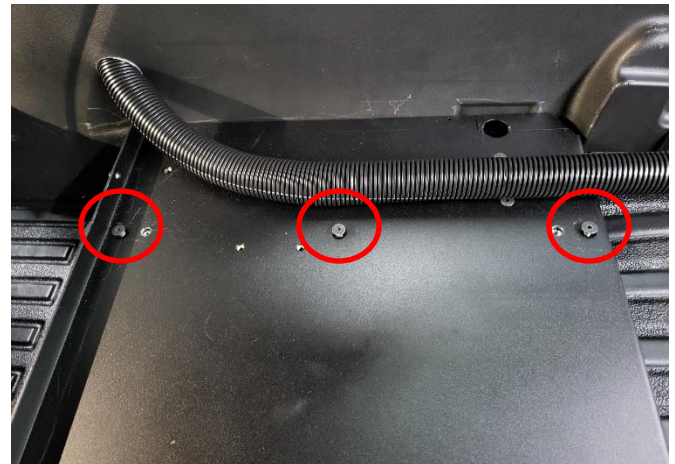

Loosely attach base plate to front floor brackets using supplied 1/4" x 1/2" Flat head bolts. (3 each side)



Attach riser brackets to base plate using 5/16" x 1" bolts and washers. Attach backing plate with 1/4" x 3/4" & 1/4" x 1/2" bolts and washers. Attach SBX-1000 series drawer to risers with 5/16" x 3/4" Thread-Forming Screws.

Tighten all hardware. Installation complete.