

K9-F27-1 INSTALLATION INSTRUCTIONS

K9 Kit for the 2022-2024 Ford Expedition SSV

TOOLS REQUIRED:

Phillips screwdriver	Trim panel removal tool	Caulk gun
Standard socket set	Metric socket set	Wire crimpers/cutters

As of 12/1/20 - Black Powder coat finish is the standard color floor on all White and Black K9 inserts.

PARTS and HARDWARE:

<u>QTY</u>	<u>DESCRIPTION</u>	<u>ITEM#</u>	
1	Front floor mounting bracket	18744	
1	Rear floor mounting bracket	18745	
1	Floor	NA – White	18746 – Black only
1	Rear bulkhead	23635 – White	23636 - Black
1	Ceiling	18749 – White	23955 - Black
1	Driver side lower filler	18750 – White	23956 - Black
1	Passenger side lower filler	18751 – White	23957 - Black
1	Driver side upper trim panel	23637 - White	23638 - Black
1	Passenger side upper trim panel	23641 – White	23642 - Black
1	Driver side upper mounting bracket	18754	
1	Passenger side upper mounting bracket	18755	
2	Side floor trim panel	NA – White	23960 - Black only
1	Rubber floor mat	18763	
1	Dome light kit	17987 (K9-A-106)	
1	Rear storage cover (shelf)	NA – White	18760 – Black only
1	Front bulkhead assembly	18761 – White	18762 - Black
1	Driver side window guard	21246 (WGI-F27-1-K9)	
1	Passenger side window guard	21247 (WGI-F27-6-K9)	
1	Driver side door panel	14669 (DP-F27-1A) White	14670 (DP-F27-1A-B) Black
1	Passenger side door panel	14671 (DP-F27-6A) White	14672 (DP-F27-6A-B) Black

11098 Hardware kit (C-HK-338)

<u>QTY</u>	<u>DESCRIPTION</u>	<u>PART#</u>	
4	.77" Front floor bracket spacer	11415 (CM003216)	
4	1.5" Rear floor bracket spacer	11561 (CM004011)	
1	Head restraint label	12355 (CM007098)	
2	Gas shock cover plate	NA – White	23177 – Black only
18	1/4" Serrated nut	16086 (GSM30170)	
4	7/16" Flat washer for rear floor bracket	16128 (GSM31011)	
33	1/4" Flat washer	16154 (GSM31048)	
22	1/4 x 3/4 Carriage bolt	16235 (GSM32024)	
4	#10 x 1/2" Flat head screw	16413 (GSM33150)	
4	M10 x 70mm bolt for rear floor bracket	16549 (GSM33788)	
18	10-32 x 1/2" Machine screw	16584 (GSM34044)	
18	10-32 Keps nuts	16067 (GSM30123)	
33	1/4" x 3/4" Phillips head bolt	16618 (GSM34102)	
1	Silicone caulk sealant	20011 – White	20012 - Black

K9-F27-1

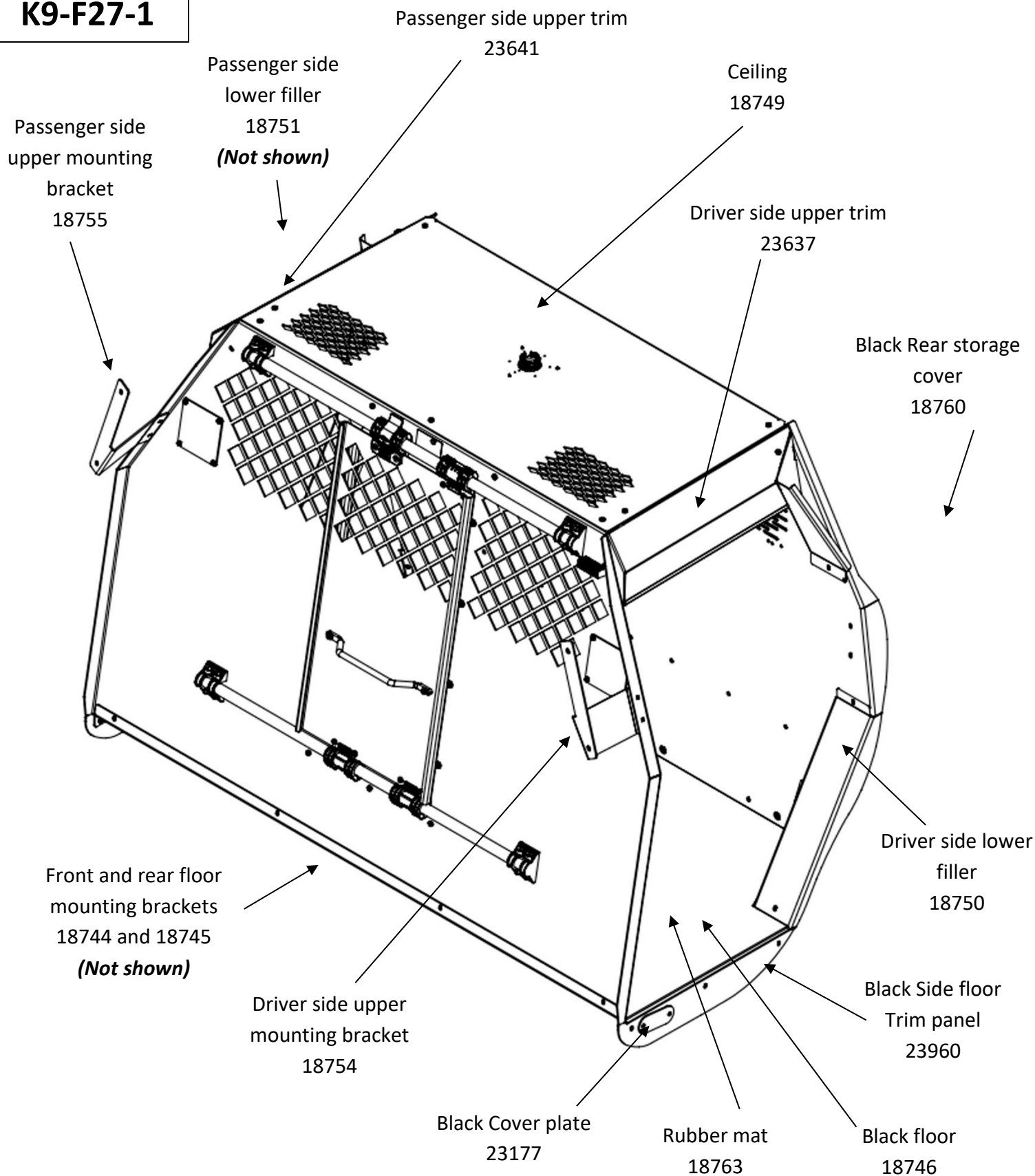

Always!

- Read all instructions before installing any Havis, Inc. products. K9-F27-1_INST_5-25
- Use hardware provided with install kit



Remove rear passenger door panels first.



Remove two (2) bolts behind access cover in middle of door panel.
(8mm socket)



Tape the lock rod and door handle release cables along the upper alcove of the door to keep them clear.

Remove speakers



Remove the window switch from the door and relocate the harness.
The switch should be placed between the moisture barrier and K9 door panel.



Place K9 door panel onto the door. Be sure to route the wires for the optional K9-A-104 window fan at this time.



Attach the K9 door panel using the supplied #10 x 1/2" sheet metal screws.



Attach window screen to door panel using #10 x 1/2" screws.



Attach upper window bracket to door frame using #10 x 1/2" flat head screws.



Attach optional 10" fan and fan mount to window guard with 1/4" hardware and spacers as per the instructions provided in the optional **K9-A-104** kit.



Wire fan with previously run wires and secure harness.



Remove the rear seats from the vehicle.
Set hardware aside for later use.



Place the larger 1.5" spacer over the (4) rear bolt holes corresponding to the rear floor mounting bracket.



Attach the rear floor mounting bracket using supplied M10 x 70mm bolts and 7/16" flat washers.



Place the .77" spacers at the front and attach front bracket using (4) previously removed OEM seat bolts.

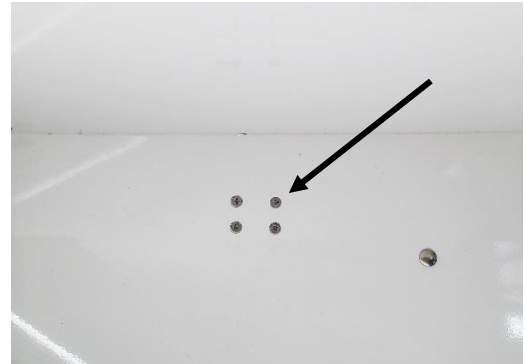

Floor has holes on each side.
Use 10-32 x 1/2" flat head machine screws and nuts for plugging holes.
Note: These holes are no longer recommended for optional gas spring mounting.



Standard floor color black

Place floor in vehicle and loosely attach using 1/4" x 3/4" carriage bolts and serrated nuts on the front bracket and 1/4" x 3/4" Phillips bolts and washers on the back bracket.

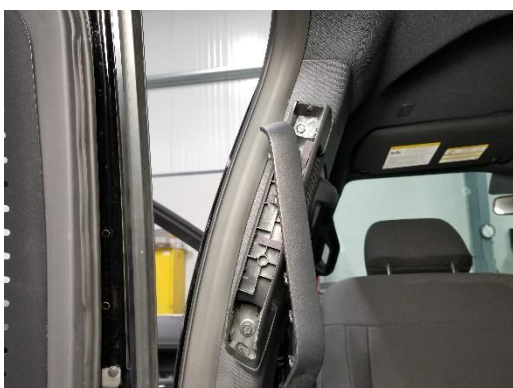

Remove cover from "B" pillar grab handle to expose (2) 10mm head bolts. Remove bolts and set aside.

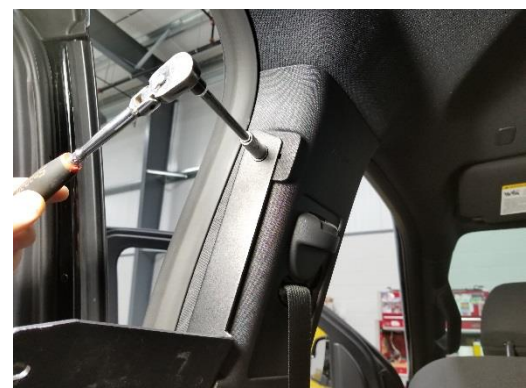

Attach upper mounting brackets using previously removed OEM hardware.

Do the same for both sides



Place front bulkhead floor into vehicle and attach using 1/4" x 3/4" carriage bolts and serrated nuts.
(Bolt heads on K9 side)



Attach to upper mounting brackets 1/4" x 3/4" carriage bolts and serrated nuts.
Optional K9-A-102 fan can also be mounted at this time.



With the help of another tech, attach the rear storage cover hinge to the rear bulkhead using (10) 10/32 x 1/2" flat head machine screws and Keps nuts.



Confirm smooth up and down motion of rear storage cover.



Place rear bulkhead in vehicle keeping tray lifted to prevent damage to vehicle.



Attach rear bulkhead to floor using 1/4" x 3/4" Phillips head bolts and washers.



Place ceiling in kit with the lip hanging over the rear bulkhead. Attach using 1/4" x 3/4" Phillips head bolts and washers.



Attach front using 1/4" x 3/4" Phillips head bolts and washers.

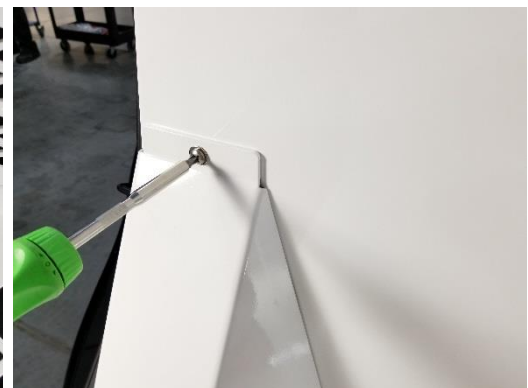

Place lower corner trim panel in and attach using 1/4" x 3/4" Phillips head bolts and washers.



Repeat process for other side.



Repeat process



Place the upper trim panels in the kit and attach using 1/4" x 3/4" Phillips head bolts and washers.

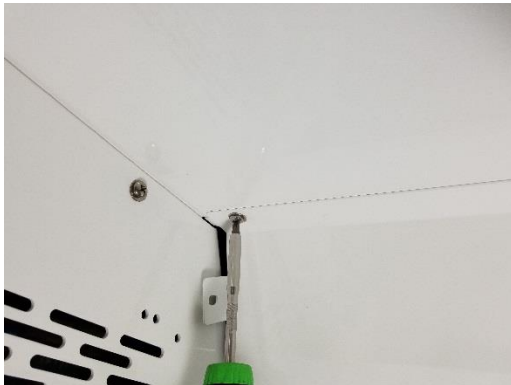

Repeat process



Attach lower side filler trim panels using 1/4" x 3/4" Phillips head bolts and washers.
(Floor parts are black)



Attach 23177 cover over pass through hole in side filler panel with #10 x 1/2" flat head sheet metals screws.

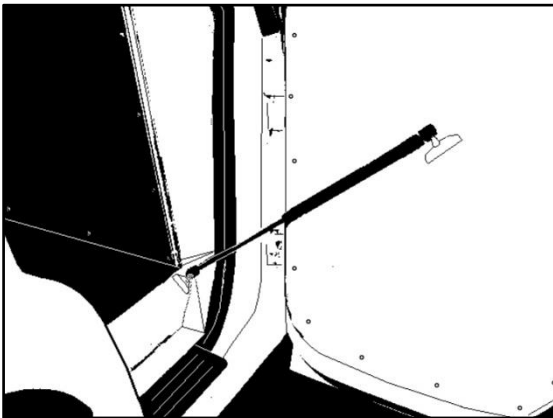

If installing gas spring (shock) for Hot-N-Pop system, install at angle as per AceK9 instructions supplied with Hot-N-Pop.

Image above is an example only. Depending on application, the installer must determine a safe and effective mount location. When attaching bracket to door, make sure that screws go into door panel and OEM sheet metal for maximum strength.



Install dome light in ceiling with #10 x 3/4" flat head sheet metals screws included with dome light kit.



Silicone caulk all lower seams to ensure a watertight seal.



Once caulk is dry. Place the rubber mat in kit.



Confirm smooth functionality of the rear storage cover. Cover is designed to rest under the lid of the OEM forward storage compartment.



Installation is now complete



Installation is now complete

