

INSTALLATION INSTRUCTIONS

PT-A-304 Trim Panel Kit and Vehicle Specific Details

For Ford Transit Medium Roof van with

One (1) or Two (2) compartment Prisoner Transport Insert Models

PT-F04-XXX-1, PT-F04-XXX-2, PT-F06-XXX-1 and PT-F06-XXX-2

Refer to

PT-1-INST or PT-2-INST, General Prisoner Transport Insert Installation Instructions
for main insert basic assembly details

All optional equipment kits include instructions

Read all instructions before starting insert installation.

TOOLS REQUIRED:

- Socket Set
- Open End Wrench - 7/16"
- Phillips Screwdriver
- Drill and Drill bits

TRIM PANEL PARTS:

<u>QTY:</u>	<u>DESCRIPTION:</u>	<u>PART NUMBER</u>
1	Rear sill plate	KKM006910
1	Rear sill diamond plate	KKM006911
1	Rear top filler plate	KKM006629
1	Front top filler plate	KKM008166

HARDWARE and Miscellaneous items:

12	#10 x 1" Sheet metal screw	GSM33183
14	#10 x 1.25" Flat head sheet metal screw	GSM33153
1	1.5" White dome plug	KRM89153



ALWAYS!

- Read all instructions before installing any Havis, Inc products.
 - Use hardware provided with install kit
- Check and double check under floor before drilling mount holes

PT-A-304 parts

KKM006629
Rear top filler plate

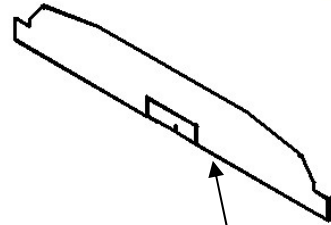

KKM008166
Front top filler plate

KKM006911
Diamond plate rear
floor trim

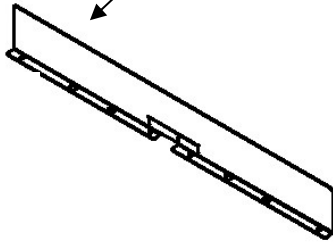

KRM89153
Dome plug

KKM006910
Rear door sill

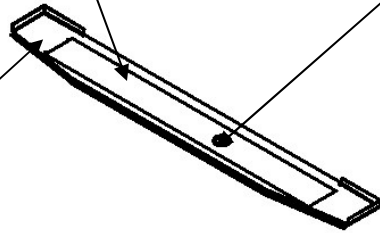

Refer to PT-1-INST or PT-2-INST
General Prisoner Transport Insert
Installation Instructions for main insert
assembly details

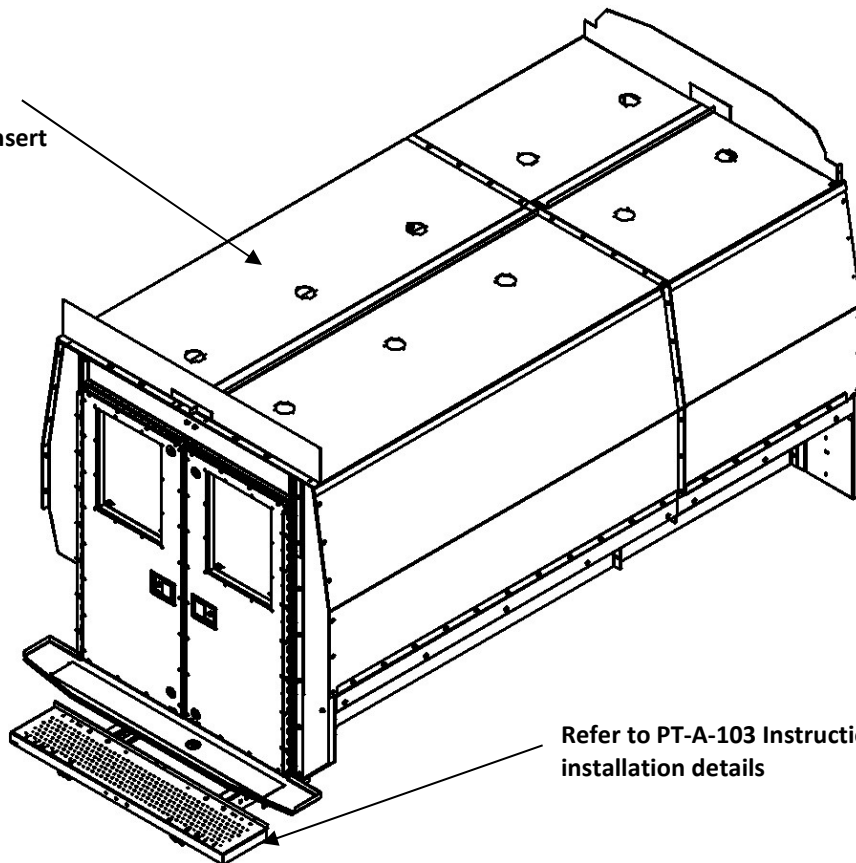

Refer to PT-A-103 Instructions for step
installation details



Remove factory rubber mat and rear floor trim.



Cut and install 1/2" thick plywood subfloor
Approximately (2) 1/2 x 48" x 96" sheets required.
(Plywood and flat head screws not included with kit)



Overall length of plywood should be at least 102" long (for 100" insert) or 122" long (for 120" insert) to match insert length plus rear sill trim. Additional piece needed for side entry area. Cut 4x4" square spacers and install in corners as shown. These prevent the wood from bowing when the kit is bolted down later.



Space plywood 7" forward from rear center of van.



STOP: Refer to General Prisoner Transport Insert Installation Instructions

See General Prisoner Transport Insert Installation Instructions and loosely fit parts before installing any trim or bolting parts to floor.

Rear bulkhead will be 1.5" inches forward from end of plywood.



Line up rear door sill (KKM006910) to the rear bulkhead. Spare tire access hole should be centered over release. Install fourteen (14) #10 screws through pre-punched holes in sill plate. Do not over tighten screws.

NOTE: DO NOT STRIP SCREWS.



Line up diamond plate with hole for spare access and make sure it is even on both sides. Evenly mark and drill twelve (12) 3/16" holes through both aluminum layers. Screw the diamond plate down using twelve (12) #10 x 1" screws.



Snap dome plug into place.



Remove four (4) carriage bolts from upper door frame assembly

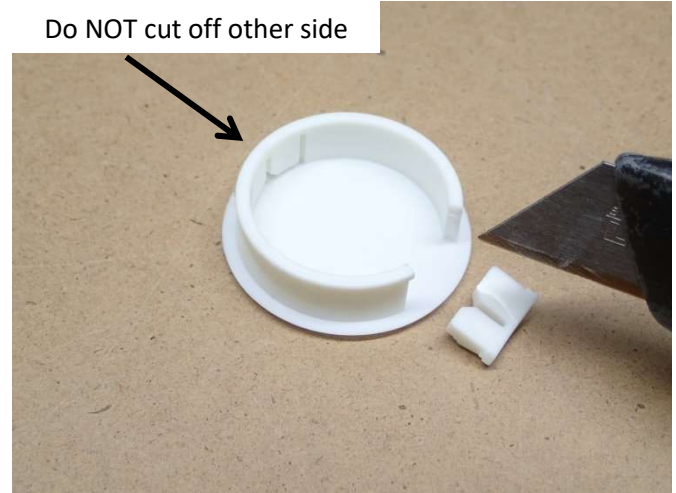

Do NOT cut off other side

Take 1.5" dome plug and cut one side of tabs off. This will allow easy removal in the event of a flat tire.

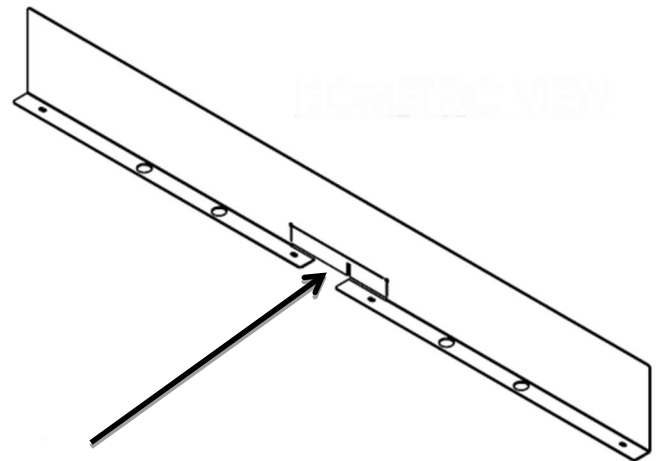

On single compartment inserts you will need to remove the center piece of this filler. Do so by snapping the metal off.



Slide trim into place and re-install previously removed carriage bolts. Make sure trim is even and tighten all hardware.

Repeat process for front filler



When bolting the front bulk head through the floor use the inner hole as shown.

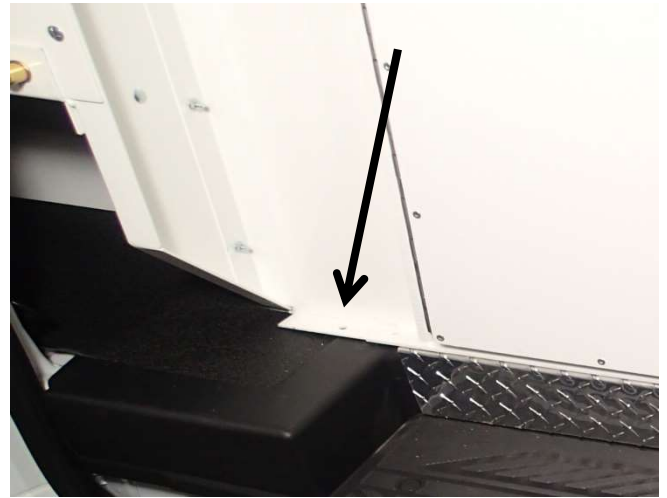

On the three compartment insert the side through bolt will not be used. This is due to obstructions under the van.



Use the outer mounting hole on the rear door frame on the single compartment. This will allow the bolt to drop between two frame supports.



On the double and triple compartments you will use the holes on the outer portion of the door frame.



Be sure to use the fender washer when installing the lock washer and nut.



Installation is now complete.