

INSTALLATION INSTRUCTIONS SBX-4010

SBX 1000 series connector kit

TOOLS REQUIRED:

7/16" socket and ratchet

PARTS and MOUNTING HARDWARE:

<u>QTY</u>	<u>DESCRIPTION</u>	<u>PART#</u>
4	Track connector	CM009795
4	Track nut	CM009796
12	1/4" x 1" Fender washer	GSM31014
12	1/4" Split lock washer	GSM31026
12	1/4" x 1/2" Hex head bolt	GSM33000

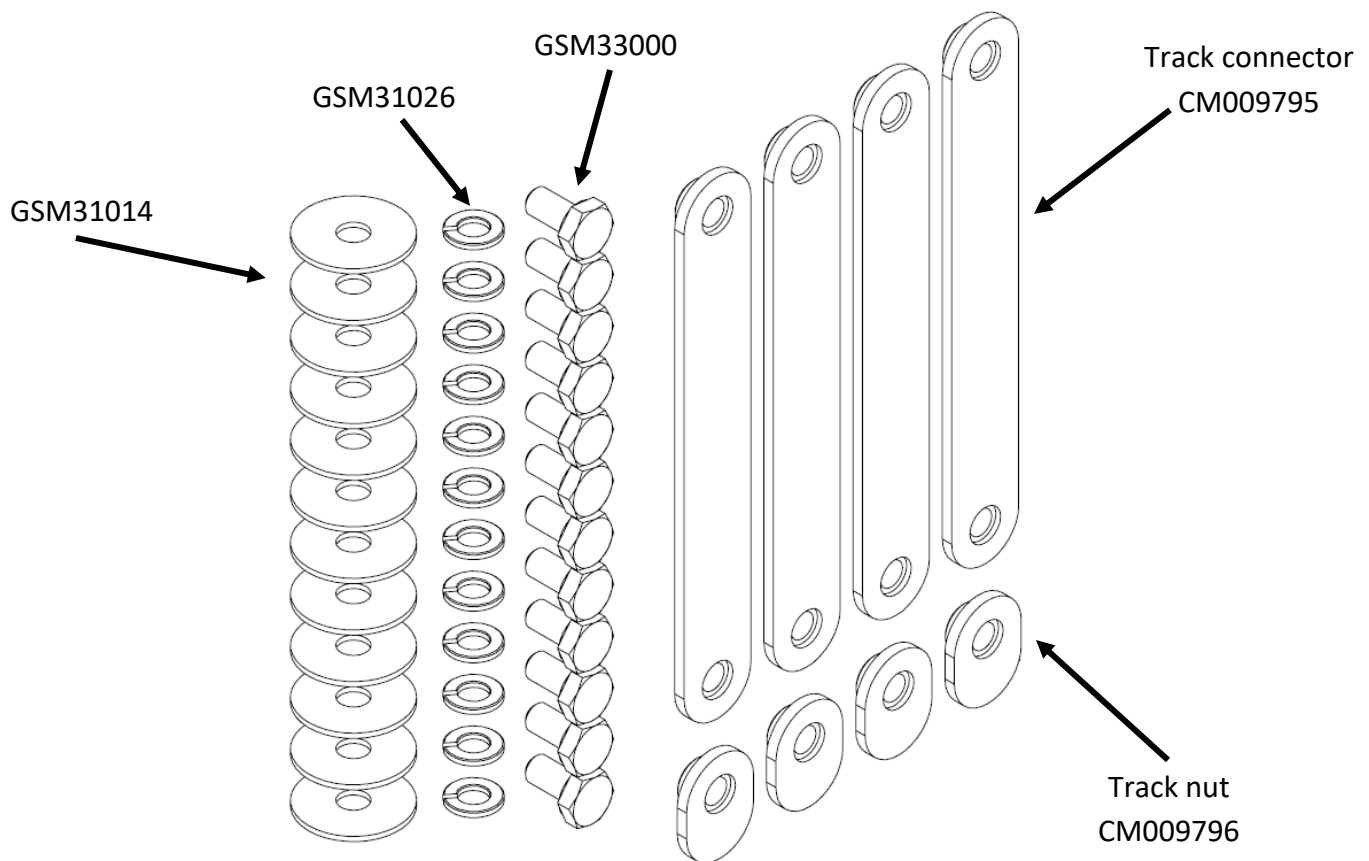

Always!

- Read all instructions before installing any Havis, Inc. products.
- **Check for obstructions (Wires, brake lines, fuel tank, etc.) before drilling any holes!**
- Use hardware provided with install kit



With SBX on its side, locate the slot for the track connector.

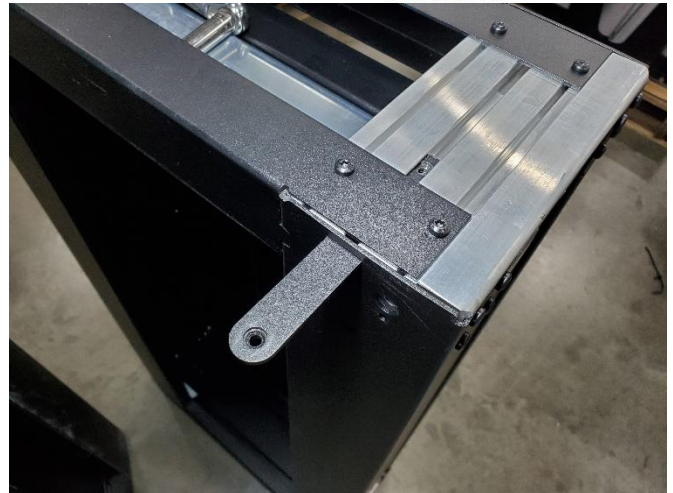

Insert track connector about halfway in to extrusion.



Install the 1/4" bolt, split lock washer, and flat washer.
Do not tighten.

(Repeat this process for the remaining three corners.)



Slide additional SBX-1000 onto the track connector.

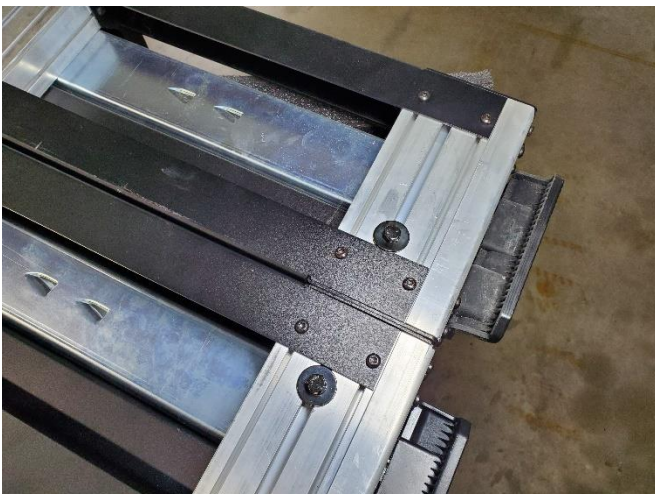

Attach using 1/4" Hex bolt, split lock washer, and flat washer.

Tighten hardware.

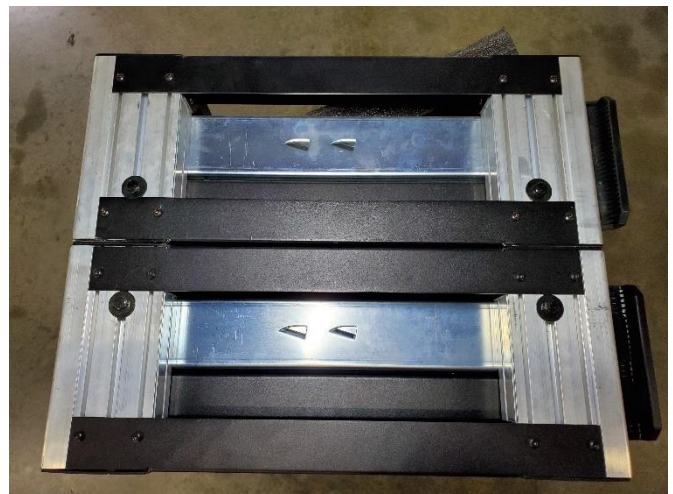

Repeat process for remaining 3 corners.
Installation is now complete.