

C-HDM-176

INSTALLATION INSTRUCTIONS

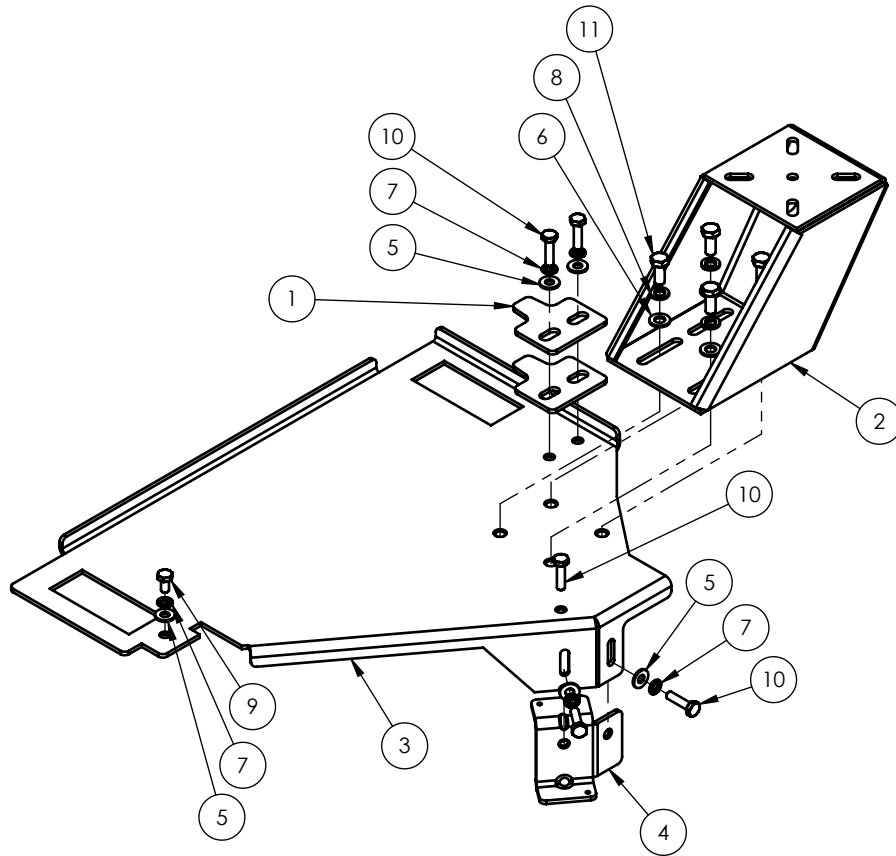

Installation Instructions

- ATTACH SUPPORT FOOT (4) TO MAIN BASE (3) USING (2X) 1/4-20 X 1" HEX HEAD CAP SCREWS (10), LOCK WASHERS (7) AND FLAT WASHERS (5).
- ADJUST SUPPORT FOOT TO ITS HIGHEST POSITION, AND LIGHTLY SECURE IT.
- INSTALL 1/4-20 X 1" HHCS (10), INTO THE THREADED HOLE ON THE MAIN BASE PLATE. DO NOT TIGHTEN.
- REMOVE TRIM AROUND PASSENGER SEAT.
- REMOVE PASSENGER SIDE REAR SEAT BOLTS.
- MANEUVER FRONT SEAT HOOKS OUT OF CORRESPONDING RECTANGULAR FLOOR HOLES.
- POSITION MAIN BASE INTO THE VEHICLE, LARGE RECTANGULAR HOLES SHOULD LINE UP WITH SEAT HOOK HOLES.
- PUT THE PASSENGER SIDE SEAT BACK INTO PLACE POSITIONING THE FRONT SEAT HOOKS FIRST. IT MAY BE NECESSARY TO POSITION THE PLATE AS FAR TO THE REAR AS POSSIBLE TO ALLOW THE SEAT TO BE EASILY TILTED FOR INSTALLATION.
- REPLACE REAR SEAT BOLTS AND FINGER TIGHTEN.
- IF THE BASE WAS SHIFTED TO THE REAR TO INSTALL THE SEAT, PULL IT AS FAR FORWARD AS POSSIBLE.
- IN NON-POWER SEAT APPLICATIONS, THE SINGLE THREADED HOLE ON THE OUTBOARD EDGE OF THE PLATE SHOULD LINE UP WITH A HOLE IN THE SEAT RAIL.
- IF APPLICABLE, INSTALL THE 1/4-20 X 1/2" HHCS (9), LOCK WASHER (7) AND FLAT WASHER (5) THROUGH THE SEAT RAIL INTO THE THREADED HOLE AND TIGHTEN.
- SLIDE TWO COMPRESSION PLATES (1) INTO THE DRIVERS SIDE SEAT RAIL AND SECURE WITH (2X) 1/4-20 X 1" HHCS (10), LOCK WASHERS (7) AND FLAT WASHERS (5).
- ATTACH BASE OFFSET (2) TO BASE USING (4X) 5/16-18 3/4" HHCS (11), (4X) 5/16 SPLIT LOCK WASHER (8) AND (4X) 5/16" FLAT WASHER (6).
- TIGHTEN 1/4-20 X 1" BOLT TO EXTEND SUPPORT FOOT TO THE FLOORING UNTIL SUFFICIENT SUPPORT FOR THE BASE HAS BEEN REACHED.
- TIGHTEN (2X) 1/4 X 1" HHCS TO LOCK SUPPORT FOOT IN PLACE.

ITEM NO.	QTY.	PART NUMBER	DESCRIPTION
1	2	CM002454	COMPRESSION PLATE,
2	1	CM002531	BRACKET, MOUNT, 55 DEG. 5" LOWER OFFSET BASE W/ SLOTS
3	1	CM007406	HDM BASE, 2015-UP TAHOE, 2014-UP SILVERADO 1500, 2015-UP SILVERADO. SIERRA 2500/3500, 2015-UP GM C&C
4	1	CM007408	FOOT, HDM, 2014 GM3500 C&C
5	5	GSM31005	WASHER, 1/4 FLAT ZP, BLACK
6	4	GSM31006	WASHER, 5/16" FLAT, SAE ZP
7	5	GSM31026	WASHER 1/4 LOCK ZP BLK
8	4	GSM31027	WASHER, 5/16" LOCK, ZP
9	1	GSM33000	SCREW 1/4-20 X 1/2 HHCS, BLK, ZP, GRD 5
10	5	GSM33002	SCREW 1/4-20 X 1 HHCS ZP
11	4	GSM33011	SCREW, 5/16-18 X 3/4"

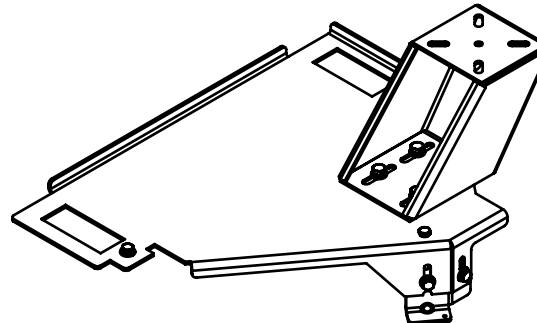

HAVIS HAVIS, INC.		75 JACKSONVILLE RD. WARMINSTER, PA. 18974 1-800-524-9900
TITLE: INSTALLATION, HDM BASE, 2014+ SILVERADO 1500/ 2015+ TAHOE		
DO NOT SCALE DRAWING		
SIZE A	DWG. NO. C-HDM-176-INST	REV 10-15
WEIGHT (LB): 12.93	SCALE: 1:8	SHEET 1 OF 1