

Owner's Manual

Havis Docking Station for Getac V110 Convertible Notebook

DS-GTC-310 Series

DS-GTC-311

DS-GTC-311-3

DS-GTC-312

DS-GTC-312-3

DS-GTC-313

DS-GTC-313-3

DS-GTC-315

DS-GTC-315-3

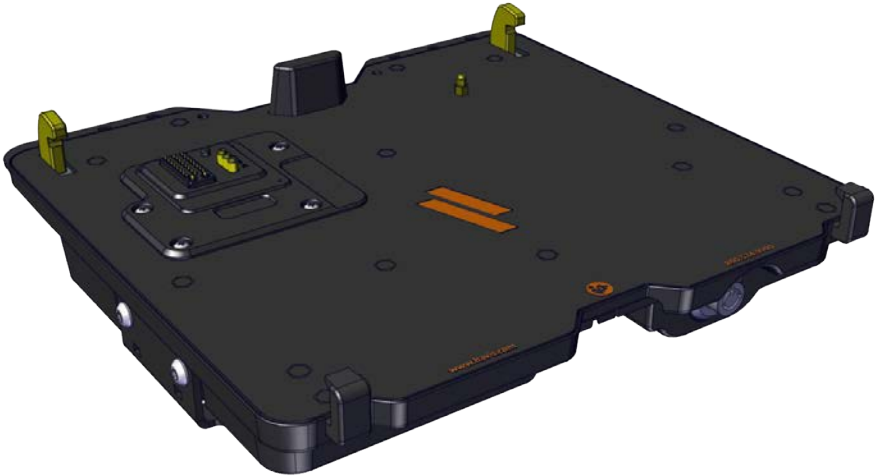

Havis is pleased to provide this Owner's Manual to aid in the proper installation and use of the DS-GTC-310 Series Docking Station for Getac V110 Fully Rugged Convertible Notebooks

For questions regarding the set-up of your DS-GTC-310 Series Docking Station, please contact Havis at 1-800-524-9900 or visit www.havis.com for additional product support and information.

This Owner's Manual applies to the following Part Numbers:

DS-GTC-311	DS-GTC-312	DS-GTC-313	DS-GTC-315
DS-GTC-311-3	DS-GTC-312-3	DS-GTC-313-3	DS-GTC-315-3

WARNING

- **NEVER STOW OR MOUNT THE DOCKING STATION DIRECTLY IN A VEHICLE AIRBAG DEPLOYMENT ZONE.**
- **DO NOT USE COMPUTER WHILE DRIVING.**

CAUTION

- **READ ALL INSTRUCTIONS THOROUGHLY BEFORE BEGINNING INSTALLATION.**
- **DO NOT STORE, INSTALL, OR OPERATE THE DOCKING STATION WHERE WATER, MOISTURE, STEAM, DUST, ETC. ARE PRESENT**
- **DO NOT DOCK OR UNDOCK YOUR COMPUTER UNLESS IT IS POWERED OFF. DOCKING OR UNDOCKING WITH YOUR COMPUTER IN ON, STANDBY, HIBERNATION, OR SLEEP MODES CAN CAUSE PERMANENT DAMAGE.**
- **FOR THE DS-GTC-311, DS-GTC-311-3, DS-GTC-312, & DS-GTC-312-3 DOCKING STATIONS: DO NOT CONNECT DIRECTLY TO VEHICLE VOLTAGE SOURCE:** This product requires a certified, automotive grade, Getac approved 95W power source rated for a continuous, regulated 19VDC output (*Havis Part Number LPS-116 or equivalent*). Failure to comply with this requirement will cause product damage that is NOT repairable and is NOT covered under warranty.
- **FOR THE DS-GTC-313 & DS-GTC-313-3 DOCKING STATION: DO NOT CONNECT DIRECTLY TO VEHICLE VOLTAGE SOURCE:** The Getac V110 notebook requires a certified, Getac approved power source rated for a continuous, regulated 19VDC output. Failure to comply with this requirement will cause product damage that is NOT repairable and is NOT covered under warranty.

NOTICE

- **FOR DOCKING STATION MODELS EQUIPPED WITH A BUNDLED POWER SUPPLY (DS-GTC-312/312-3/315/315-3) REFER TO THE SUPPLIED LIND POWER SUPPLY REFERENCE GUIDE.**
- **WHEN NOTEBOOK IS DOCKED, THE BATTERY WILL ONLY CHARGE BETWEEN 0°C to 50°C (32°F to 122°F).**
PLEASE REFER TO GETAC V110 OWNER'S MANUAL FOR MORE INFORMATION.

Table of Contents

Specifications	3
Parts Included	5
Port Replication Capability	6
Antenna Identification	6
Installation	7
Cable Management	8
Operation - Docking	9
Operation - Undocking	10

Precautions

- Do not place metal objects or containers of liquid on top of the Docking Station
- If a malfunction occurs, immediately unplug the Power Supply and remove the laptop
- Use only the specified Power Supply (Part # LPS-116) with this Docking Station
- Do not connect cables into ports other than what they are specified for
- Do not leave the Docking Station in a high temperature environment (greater than 85°C, 185°F) for a long period of time

Specifications

Power Supply Input	19V DC-In
Dimensions	10.9" (27.7 cm) H x 11.7" (29.8 cm) W x 2.8" (7.1 cm) D
Weight	5.1 lbs (2.3 kg)
Operating Environment	-20° C to 60° C (-4° F to 140°F)
Storage Environment	-40° C to 71° C (-40° F to 160° F)

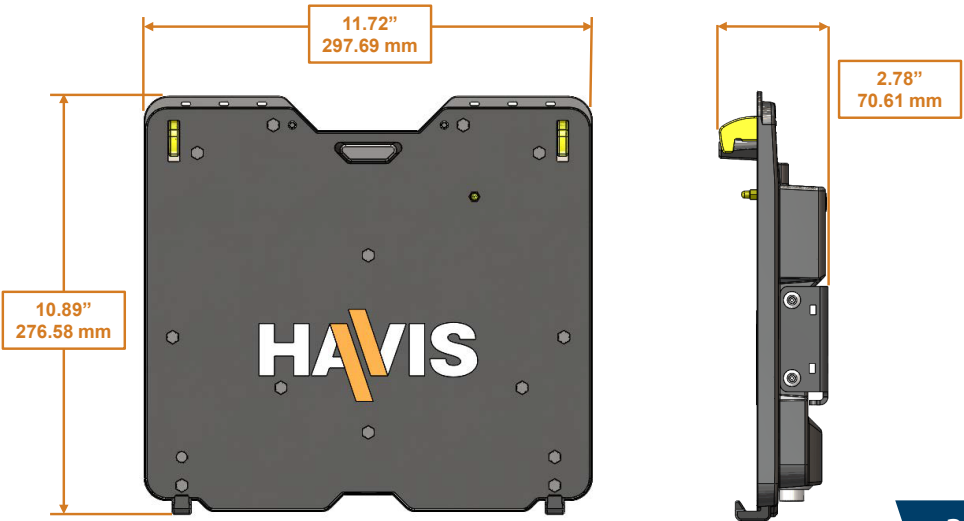

Specifications

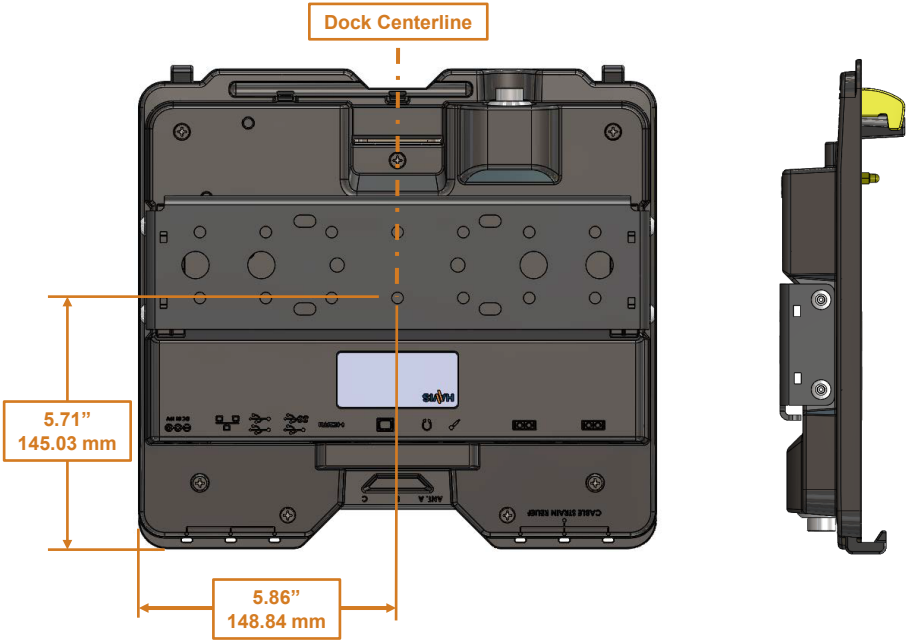

EC DECLARATION OF CONFORMITY in accordance with EN 50498

Manufacturers Name: Havis, Inc.
Manufacturers Address: 75 Jacksonville Road, Warminster, PA 18974 USA

Declares under our sole responsibility that the product:
Product name: Havis Docking Station For Getac V110 Fully Rugged Convertible Notebook
Model: DS-GTC-31X, where 'X' may be any alphanumeric character and which describes product options.
May be followed by any alphanumeric characters which describe product options.
Product Options: This declaration covers all options of the above product which bear the CE Marking.

Is in conformity with the following standards or other normative documents:
Automotive EMC Directive EN 50498:2010, Electromagnetic compatibility (EMC) -
2004/108/EC: Product family standard for aftermarket electronic equipment in vehicles
Directive 2011/65/EU Restriction of the use of certain hazardous substances (RoHS)

Supplementary Information:
The product herewith complies with the requirements of the Automotive EMC Directive 2004/108/EC, Annex I, 6.5, 6.6, 6.8, and 6.9. This product requires the use of a recommended e-Marked automotive power supply when used within vehicles.

Plymouth twp, MI, USA July 30, 2014 Bruce Jonik, Director of Engineering, Havis, Inc.

FCC 47CFR, Part 15 compliance: This is an FCC Class B device. Any changes or modifications to the model DS-GTC-31X not expressly approved by Havis, Inc. could void the user's authority to operate this equipment.

Parts Included

Docking Station

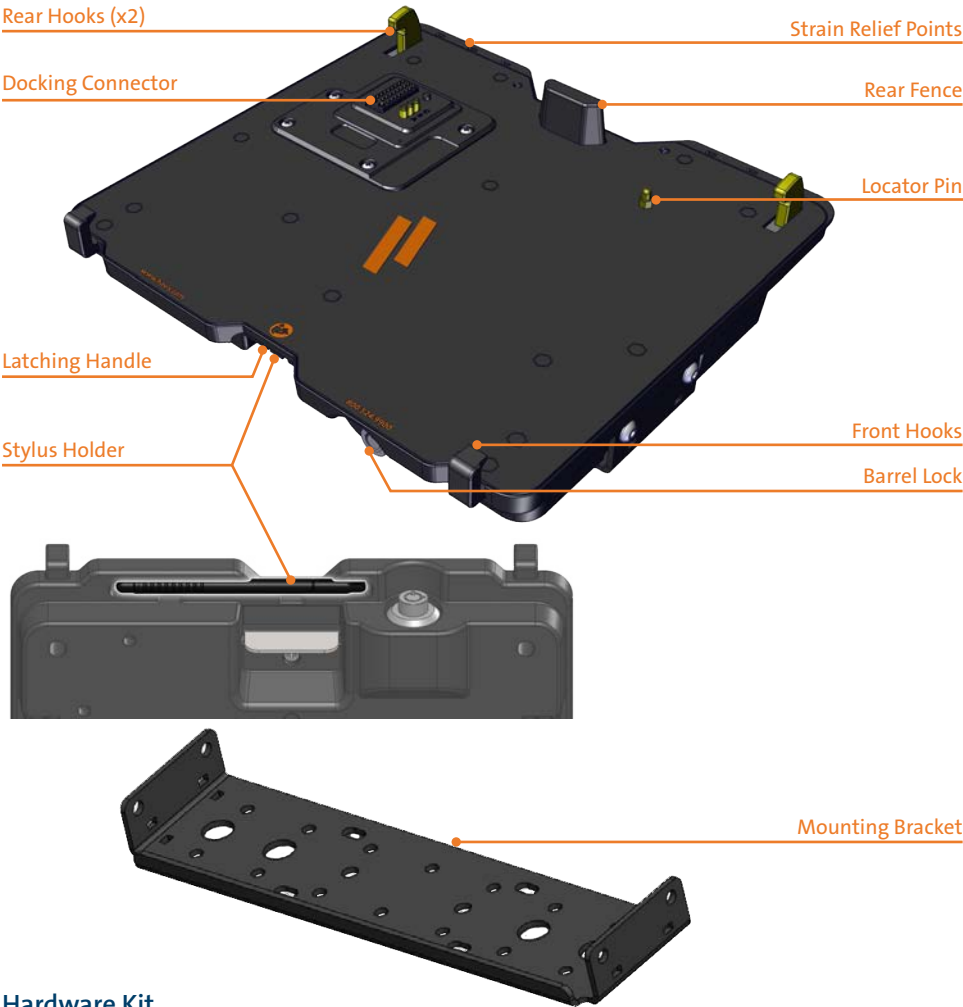

Hardware Kit

This Hardware Kit includes:

- 1. Zip Ties (6)
- 2. Keys (2)
- 3. 1/4"-20 x 5/8" long Button Head Screws (9)

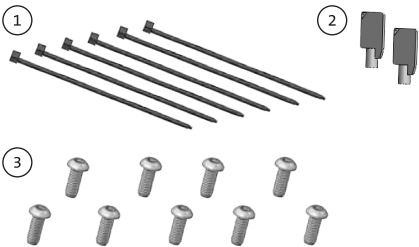

Tools required for installation:

- 5/32" Hex Drive
(For attaching Mounting Bracket to Motion Device with Button Head 1/4"-20 Screws)

Port Replication Capability

Rearward Facing Ports

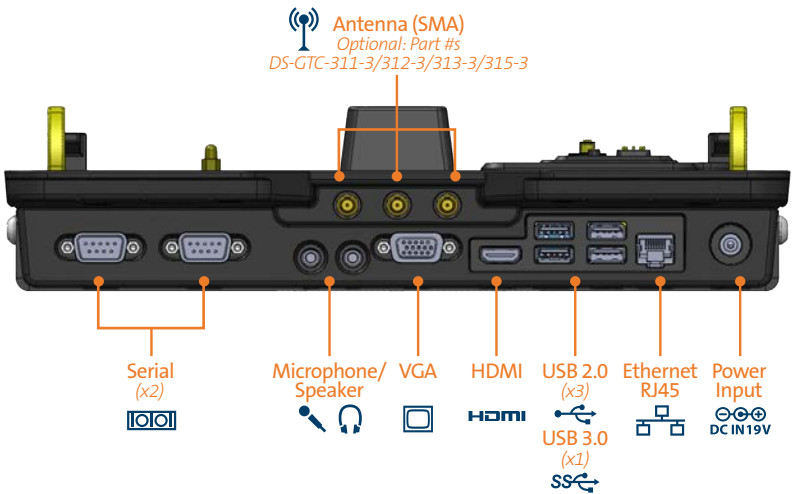

Antenna Identification (DS-GTC-311-3, DS-GTC-312-3, DS-GTC-313-3, DS-GTC-315-3)

- Ⓐ - GPS Ⓑ - WLAN/WIFI Ⓒ - 4G/CELLULAR

Antenna Connectors (SMA)

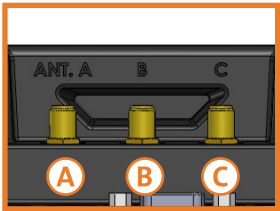

Laptop Interface

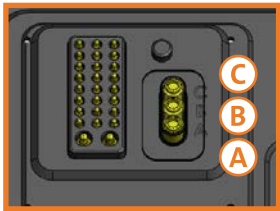

Installation

- 1) Remove the Mounting Bracket from the packaging. Install the Mounting Bracket to the Motion Device using (3) 1/4"-20 x 5/8" long screws (Hardware Kit Item 3). Torque screws to 80 in-lbs (9.0Nm) \pm 10%.

NOTE: Numerous hole patterns present in Mounting Bracket will accomodate Havis Motion Devices as well as most competitors'

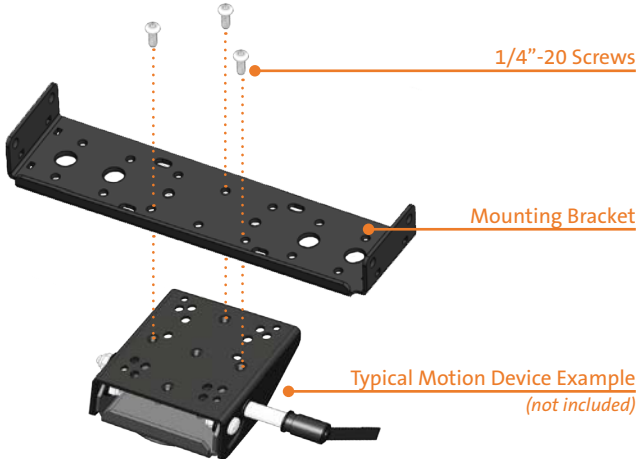

NOTE: We recommend applying a drop of medium strength (blue) thread locking adhesive to the threads of all fasteners.

- 2) Lower the Docking Station to the Mounting Bracket as shown and secure with (4) 1/4"-20 x 5/8" long screws (Hardware Kit Item 3). Torque screws to 80 in-lbs (9.0 Nm) \pm 10%.

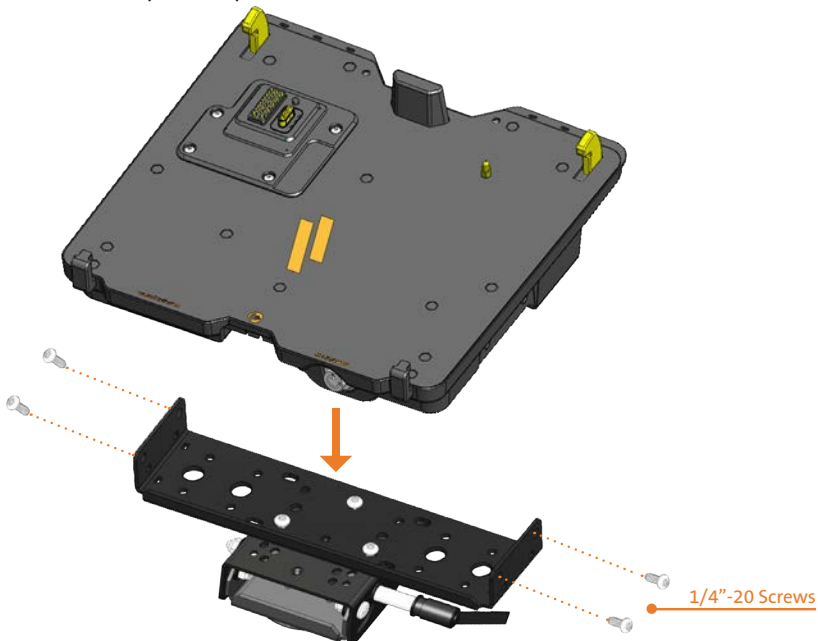

Cable Management

- 1) Orient the Docking Station in a position that is comfortable to work with.
- 2) Install all cables that are necessary for computing needs.
Use Zip Ties (Hardware Kit Item 1) to strain relieve cables to the Strain Relief Points, routing all cables together to the front of the Docking Station.
- 3) Secure cable bundle to the Mounting Bracket with a supplied Zip Tie.
- 4) Create a service loop with cable bundle to ensure that no tension is on the connectors and to enable intended motion.
- 5) Tie off cables onto a stationary part of the mounting system.
(Mounting system not included with Docking Station)

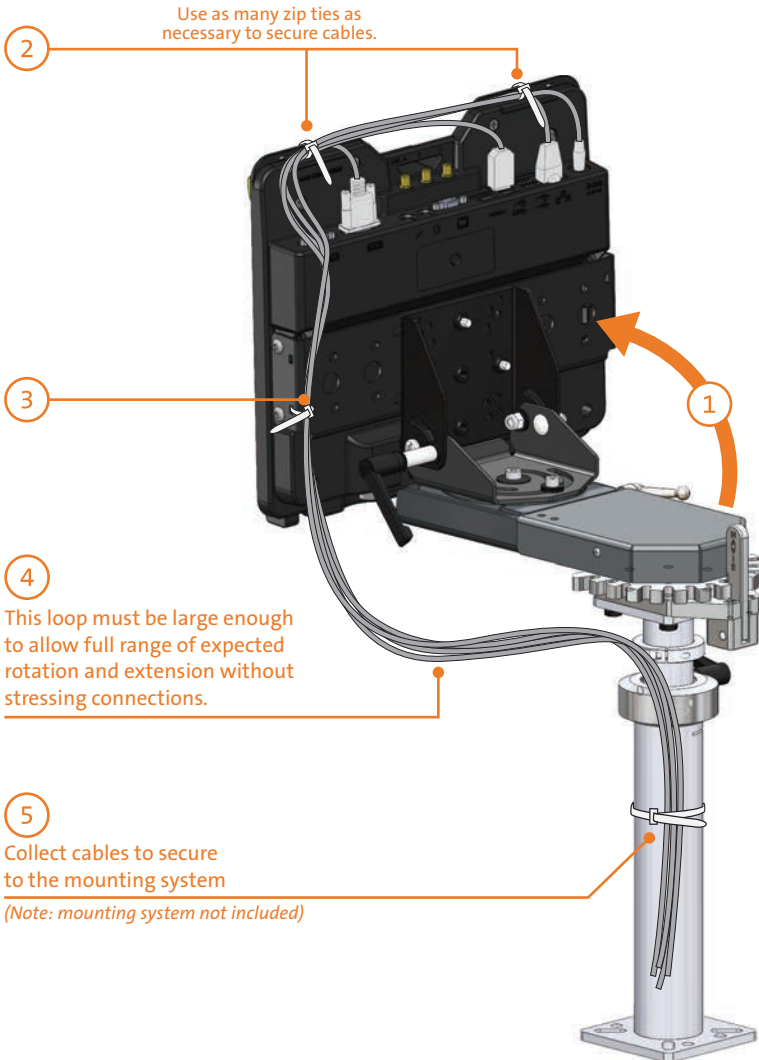

⚠ CAUTION

DO NOT FORCE NOTEBOOK ONTO DOCKING STATION. IF THERE IS RESISTANCE, CHECK THE ALIGNMENT OF NOTEBOOK ON DOCKING STATION.

- 1) Ensure the Docking Station is unlatched by pushing the Lock to release.

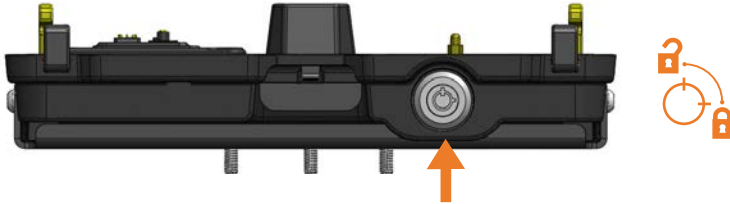

- 2) With rear of computer elevated, load front of computer into Docking Station ensuring the computer's front hook pockets align with the front hooks of the Docking Station as shown.

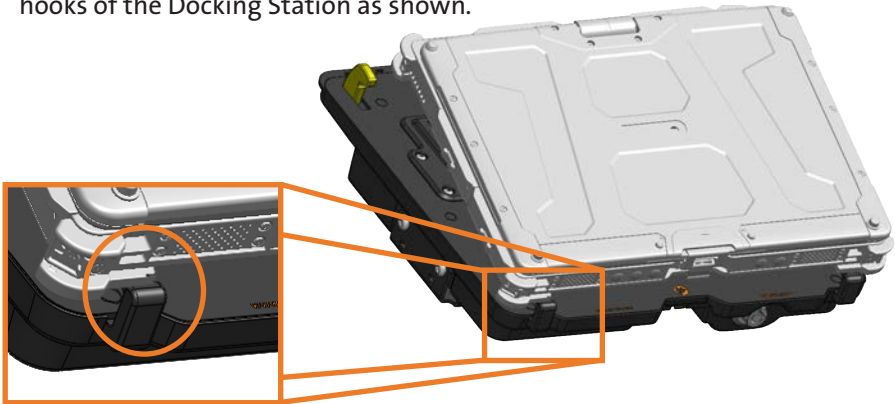

- 3) Lower back of computer onto Docking Station, ensuring computer properly aligns with the Locator Pin on the Docking Station. With computer seated on Docking Station, (a) apply light downward pressure to the rear of computer and, (b) pull the Front Latching Handle forward until latched.

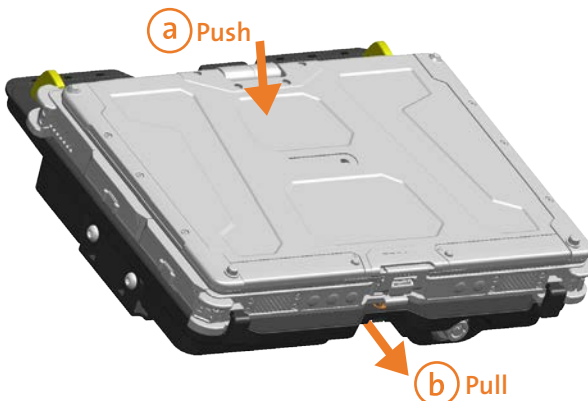

Operation - Docking (continued)

- 4) For theft deterrence, secure computer by locking Docking Station with supplied key (Hardware Kit Item 2).

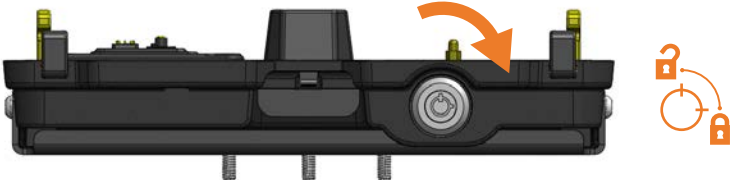

Operation - Undocking

- 1) If previously locked, unlock Docking Station using supplied key.

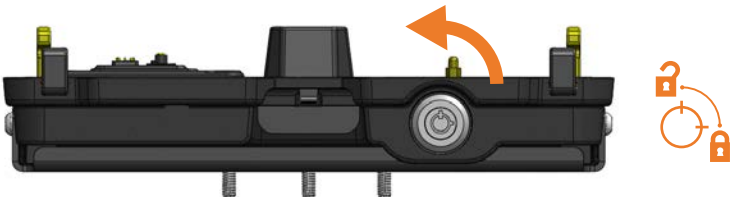

- 2) Depress Barrel Lock to unlatch Docking Station from computer.



Operation - Undocking (*continued*)

- 3) Once unlatched grab both sides of computer and carefully lift out of Docking Station, rear end first.



Related Products

Havis offers a wide variety of accessory products specifically for use with the DS-GTC-310 Series Docking Station. For more information or to order, please visit www.havis.com.



LPS-116
95W Power Supply

External power supply and cable for Getac Notebooks with cigarette lighter adaptor.



DS-DA-102
Night Eyes II

In-vehicle night time viewing from six long lasting, soft true, red LED lights on a flexible steel gooseneck.



DS-DA-413
Screen Stiffener

Secure your laptop screen to prevent excess wear and reduce vibration while in use.



DS-DA-502
Replacement Keys

Set of two (2) replacement keys for DS-GTC-310 Series Docking Stations.



Havis, Inc.
75 Jacksonville Road
Warminster, PA 18974

www.havis.com 1-800-524-9900