

PKG-PMB-408

PKG-PMB-410

Rugged Pole Mount

INSTALLATION GUIDE

Get Started

- A** MD-408, #19147/MD-410, #43679 **E** Clamp bolt 1/4-20 x 4" (4), #38590
B Clamp block (2), #42900 **F** Nut 1/4-20 Nyloc flange (4), #27646
C Clamp bolt 1/4-20 x 6" (4), #38588 **G** Pan head bolt 10-32 x 3/4" (4), #16450
D Clamp bolt 1/4-20 x 5" (4), #38589 **H** Nut 10-32 Nyloc (4), #16006
K Rubber cup 1/4" (4), #47634

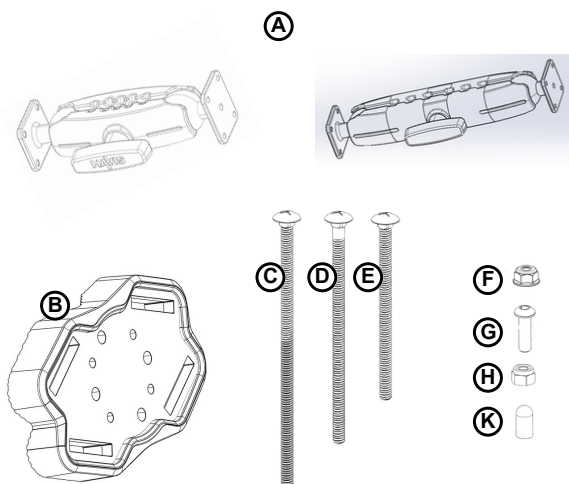

Assembly

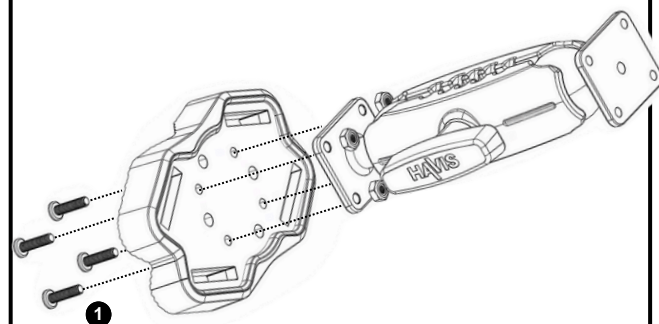

- 1** Attach item A to one of item B as shown using item G and nut H, 4x.

PKG-PMB-408 REV A

Installation

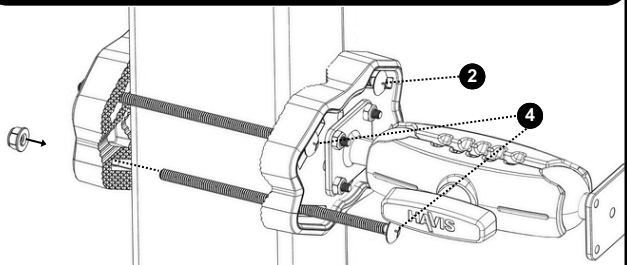

- Select the appropriate size clamp bolt C, D or E ensuring that there is enough length to pass through the column, the two clamp plates B and the nut J.
- Position previous made assembly against the column ensuring the rubber is against the column. If the column is 2-4" wide, the mounting blocks are oriented as shown in the instructions. If the column is 1-2" wide, the mounting blocks should be rotated 90°.
- Slide the appropriate size clamp bolt (C, D or E) through the assembly and the second clamp plate B. Secure with loosely with nut J. Note if the assembly is getting in the way the knob can be loosened to allow some movement of the assembly.
- Attach the other 3 bolts (C, D or E) as above securing with nut J. Ensure bolts are as close to the column as possible before tightening. Once all bolts have been attached, the locknuts can be fully tightened. If extra thread protrudes from nut, cover threads using rubber caps K, 4x.

Adjustments

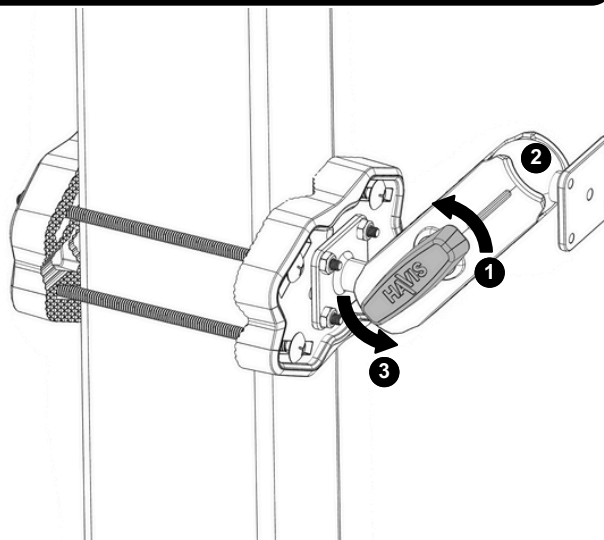

- To move arm, loosen adjustment knob and reposition arm.
- Ball mounts allow for full rotation.
- Once in position, tighten knob.

Attachments

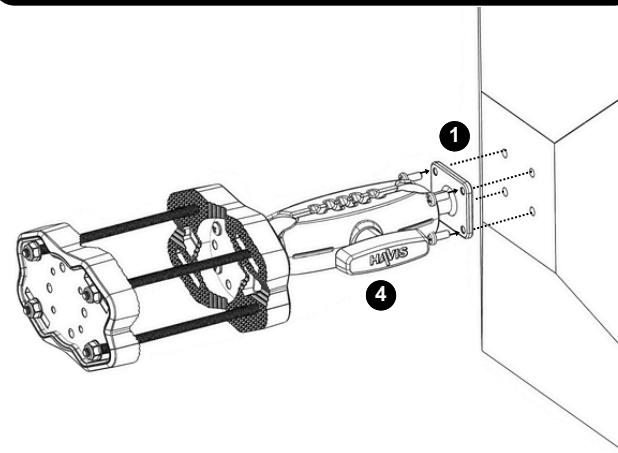

- Thread four screws (not provided) into the device.
- Once all four screws are attached fully tighten.
- Note if the assembly is getting in the way the knob can be loosened to allow some movement of the assembly.
- Once screws are fully tightened readjust the knob and position as desired.

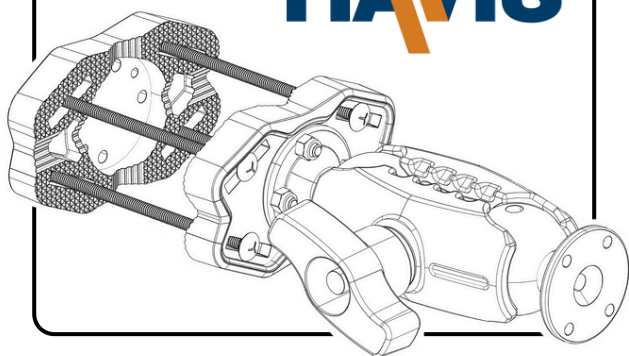

PKG-PMB-409

PKG-PMB-411

Rugged Pole Mount

INSTALLATION GUIDE

Get Started

- A** MD-409, #23830/MD-411, #44282
B Clamp block (2), #42900
C Clamp bolt 1/4-20 x 6" (4), #38588
D Clamp bolt 1/4-20 x 5" (4), #38589
E Clamp bolt 1/4-20 x 4" (4), #38590
F Nut 1/4-20 Nyloc flange (4), #27646
G Button hex bolt 1/4-20 x 7/8" (4), #16668
H Hex head bolt 1/4-20 x 3/4" (4), #16326
J Nut 1/4-20 Nyloc (4), #16008
K Rubber cup 1/4" (4), #47634
L VESA75 AMPS plate, #10351

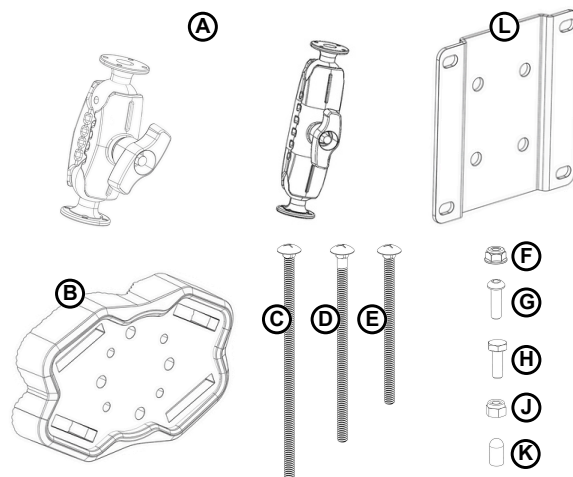

Assembly

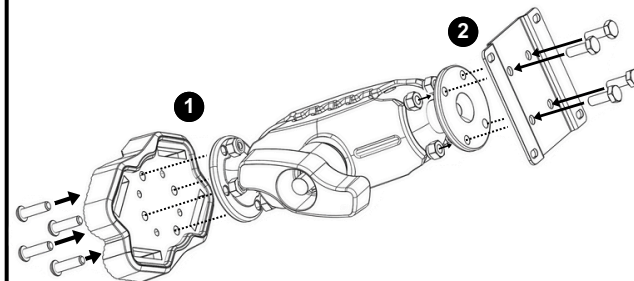

- 1 Attach item A to one of item B as shown using item G and nut J, 4x. Nuts J should be on item A side as shown.
- 2 On the opposite side attach Item A to item L as shown using item H and item J, 4x.

PKG-PMB-409 REV A

Installation

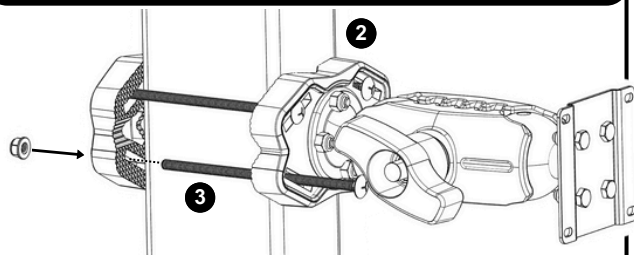

- 1 Select the appropriate size clamp bolt C, D or E ensuring that there is enough length to pass through the column, the two clamp plates B and the nut J.
- 2 Position previous made assembly against the column ensuring the rubber is against the column. If the column is 2-4" wide, the mounting blocks are oriented as shown in the instructions. If the column is 1-2" wide, the mounting blocks should be rotated 90°.
- 3 Slide the appropriate size clamp bolt (C, D or E) through the assembly and the second clamp plate B. Secure with loosely with nut J. Note if the assembly is getting in the way the knob can be loosened to allow some movement of the assembly.
- 4 Attach the other 3 bolts (C, D or E) as above securing with nut J. Ensure bolts are as close to the column as possible before tightening. Once all bolts have been attached, the locknuts can be fully tightened. If extra thread protrudes from nut, cover threads using rubber caps K, 4x.

Adjustments

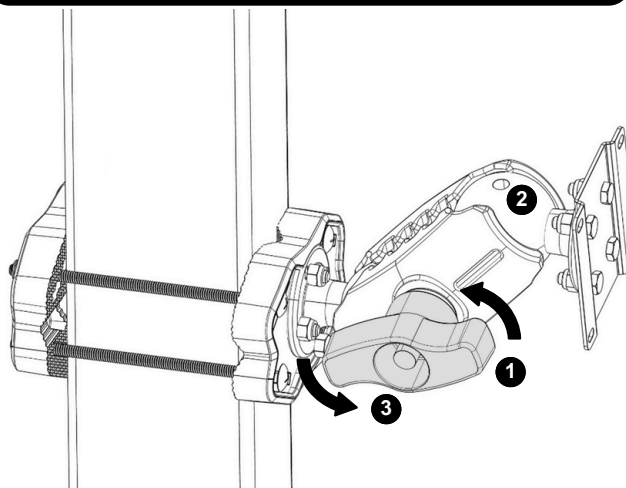

- 1 To move arm, loosen adjustment knob and reposition arm.
- 2 Ball mounts allow for full rotation.
- 3 Once in position, tighten knob.

Attachments

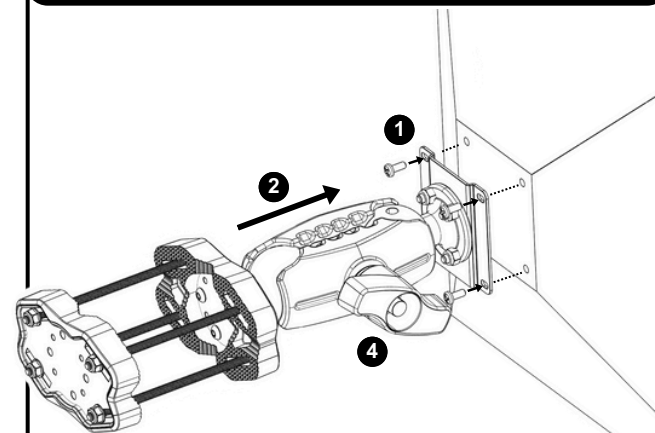

- 1 Thread four screws (not provided) into the device.
- 2 Once all four screws are attached fully tighten.
- 3 Note if the assembly is getting in the way the knob can be loosened to allow some movement of the assembly.
- 4 Once screws are fully tightened readjust the knob and position as desired.