



## Installation Instructions:

# C-VSX-1800-TAH-PM-1

**Wide VSX Console with Front Printer Mount or Integrated Storage Bin for 2025 Chevy Tahoe PPV & SSV**

**NOTE:** Does not work if vehicle is equipped with full size OEM console

### ↳ Look Inside For:

- Information about your VSX Console
- Installation instructions for your VSX Console
- Additional related products of the VSX Console
- Maintenance & troubleshooting of the VSX Console
- Warranty & service information

Havis, Inc.

75 Jacksonville Road Warminster, PA 18974  
Telephone: 1-800-524-9900 Fax: 1-215-957 0729

[www.havis.com](http://www.havis.com)

## About Your Console Page #

Line drawing .....	4
Table highlighting the subcomponents of the VSX console .....	4
Mounting hardware list for the VSX console .....	5

## Installing Your VSX Console Page #

Step by step instructions .....	6
Additional products for the VSX Console .....	39

## Additional Items Page #

Maintenance & troubleshooting .....	43
Warranty & service .....	44



# C-VSX-1800-TAH-PM-1

## TOOLS REQUIRED

Metric & Standard Socket Set

Allen Key Set

Panel Removal Tool

12mm x 1.75 Thread Tap

Torx Driver Set

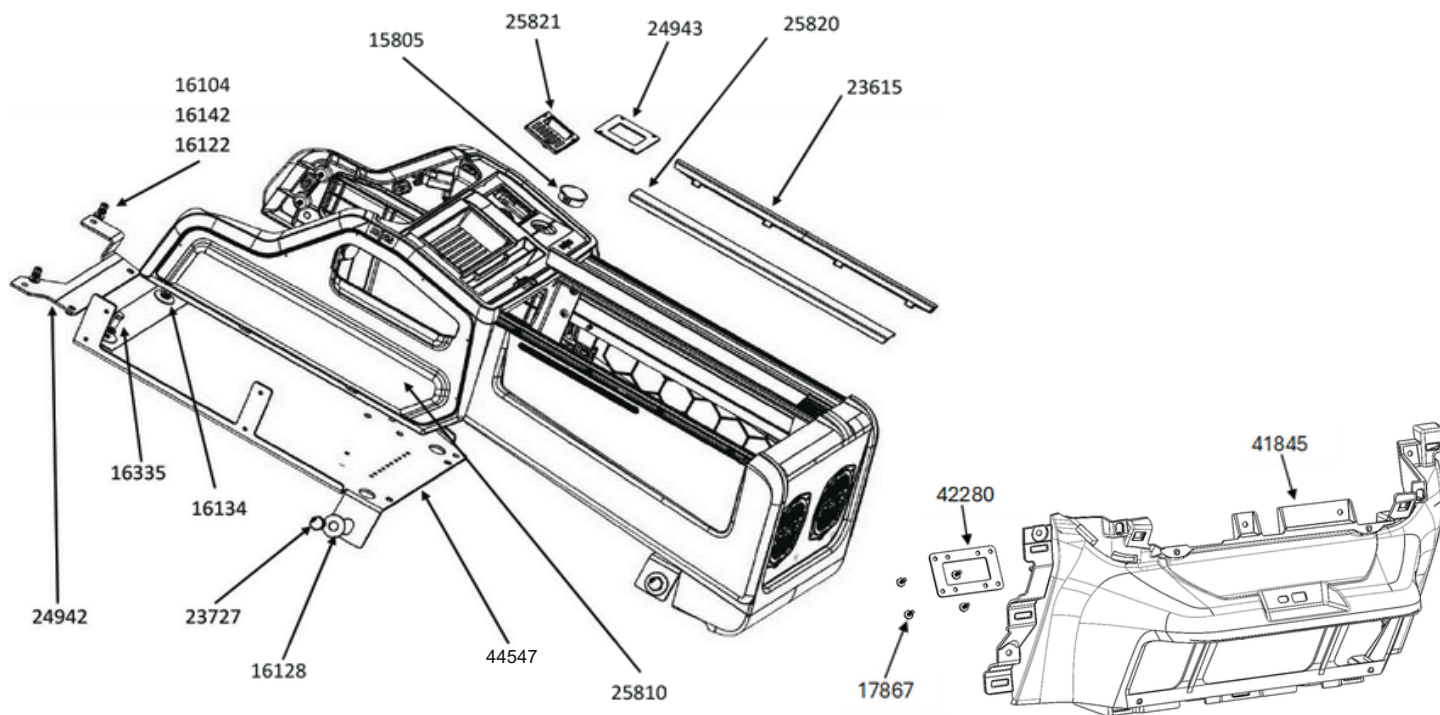

**NOTE:** Suburban rear HVAC controls must remain in vehicle or check engine lights will come on. There is also a key sensor in the center seat. Both HVAC control and sensor need to be relocated in the VSX console. Relocation to be determined by installer.

**CAUTION:** Havis recommends that customers DO NOT relocate the OEM 12V socket from the dash into the console housing, as improper installation may cause an electrical short. (RE: GM Bulletin No. PIT5800)

## Subcomponents of the VSX Console

QTY	DESCRIPTION	PART#
1	Front lower mounting bracket	24942
1	Equipment mounting platform	44547
4	7/16 Fender washer	16128
4	M12 x 20mm Floor mounting bolts	23727
9	Allen head, ¼" button head bolts	17867
1	110v relocation plate	24943
1	Brother printer paper roll holder	23447
1	LH side trim panel	25810
1	RH side trim panel	25811
1	OEM aux panel relocation plate	25817
1	Center trim strip	25820
1	OEM aux panel delete cover	25821
1	Pair of side trim strips	23615
1	Console screws hardware kit	11114
1	1.125" Dome plug	15804
1	1.5" Dome plug	15805
2	M6 hex nut	16104
2	1/4" Flat washer	16122
2	5/16" x 1.25" Fender washer	16134
2	1/4" split lock washer	16142
2	5/16" split lock washer	16143
5	A-clips	16309
2	5/16" x 3/4" hex head bolt	16335
3	M2.6 screw	17805
9	M4 x 12mm Thread forming screw (T20)	17867

## Related Accessory Hardware

### EQUIPMENT BRACKET KIT FOR FRONT TRAY SIREN LIGHT CONTROL – WHELEN

#### C-EBX-WHE-1

QTY	DESCRIPTION	PART#
3	#10-32 x 5/8" L Hex Head Screw	GSM34137
3	#10-32 Nylock Hex Nut	GSM30015
3	Spacer	GSM34624

### EQUIPMENT BRACKET KIT FOR FRONT TRAY SIREN LIGHT CONTROL – FEDERAL SIGNAL

#### C-EBX-FS-1

QTY	DESCRIPTION	PART#
1	EBX Plate, Federal Signal	10-010296
5	M3 x 10mm L Washer Head Screw	HW-PT-0045

### EQUIPMENT BRACKET KIT FOR FRONT TRAY SIREN LIGHT CONTROL – SOUNDOFF

#### C-EBX-SO-1

QTY	DESCRIPTION	PART#
3	M3 X 10mm L Washer Head Screw	HW-PT-0045
5	8-32 x .3125 Machine Screw	HW-MS-2755

### EQUIPMENT BRACKET KIT FOR FRONT TRAY SIREN LIGHT CONTROL – CODE 3 Z3S

#### C-EBX-C3-2

QTY	DESCRIPTION	PART#
5	Thread Forming Screw, Washer Head, M3.0 STS+ Thread, 10mm Long, T10 Drive Black	HW-PT-0045

### EQUIPMENT BRACKET KIT FOR FRONT TRAY FITS MOTOROLA REMOTE RADIO XTL-1500, XTL-2500, XTL-5000-05, APX-6500, APX-7500, & APX-8500

#### C-EBX-MOT-1

QTY	DESCRIPTION	PART#
2	Washer #10 Flat Black	GSM31003
5	Screw, 10-32 X ½ PPHMS, ZP	GSM33118
3	Thread Forming Screw, Washer Head, M3.0 STS + Thread, 10mm Long T10 Drive, Black	HW-PT-0045
2	Spacer, Round, Unthreaded, 0.4375" OD x 0.290" ID x 0.250" Long	UT-0126-MA

### EQUIPMENT BRACKET KIT FOR FRONT TRAY SIREN LIGHT CONTROL – CODE 3

#### C-EBX-C3-1

QTY	DESCRIPTION	PART#
1	EBX Plate, Code 3	10-010297
5	M3 x 10mm L Washer Head Screw	HW-PT-0045



## Step By Step Installation

**View of Tahoe before installation.**



- 1** Remove covers on lower, front sides of OEM center seat.





## Step By Step Installation

### 2 Remove OEM bolts.



### 3 The rear bolts are obstructed by the seat rail.





## Step By Step Installation

- 4** To remove bolts, the driver and passenger seats will need to be unbolted and shifted out of the way. **Repeat process for both sides.**



- 5** After the OEM center seat is removed, the driver and passenger seats can be bolted back in.





## Step By Step Installation

- 6** Remove lower IP trim- there is a 7mm head fastener in the driver's footwell.

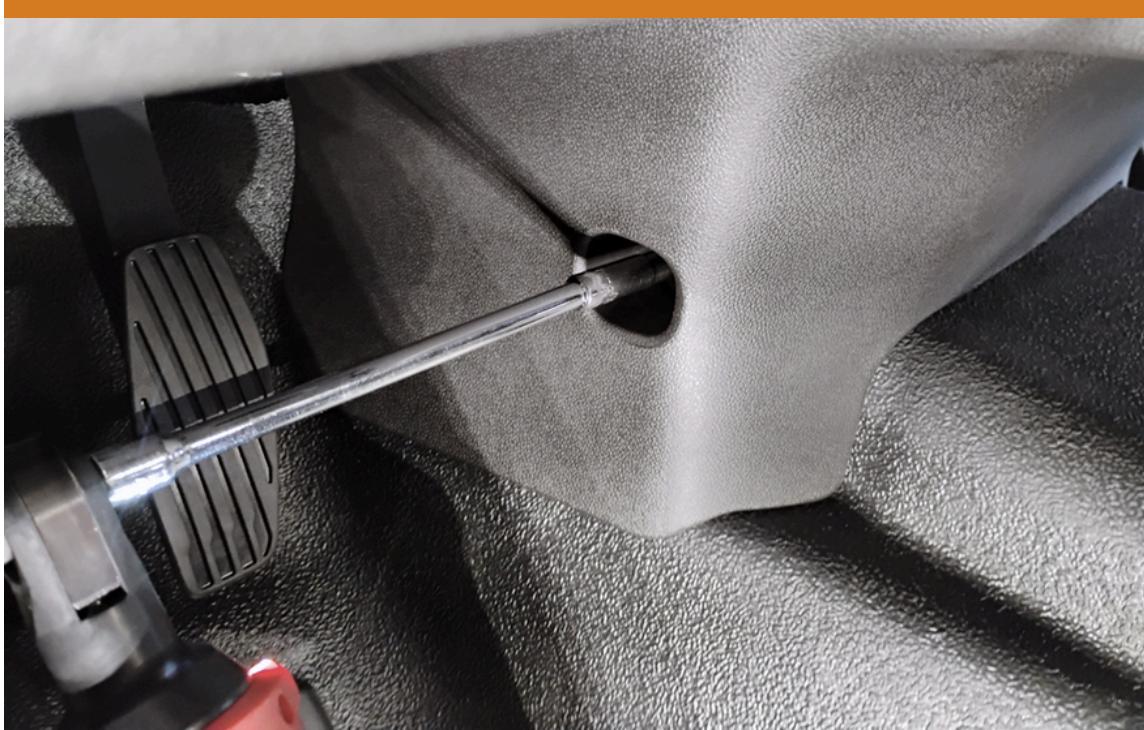

- 7** Loosen (do not need to fully remove) 2x T20 Torx head screws under the center IP.

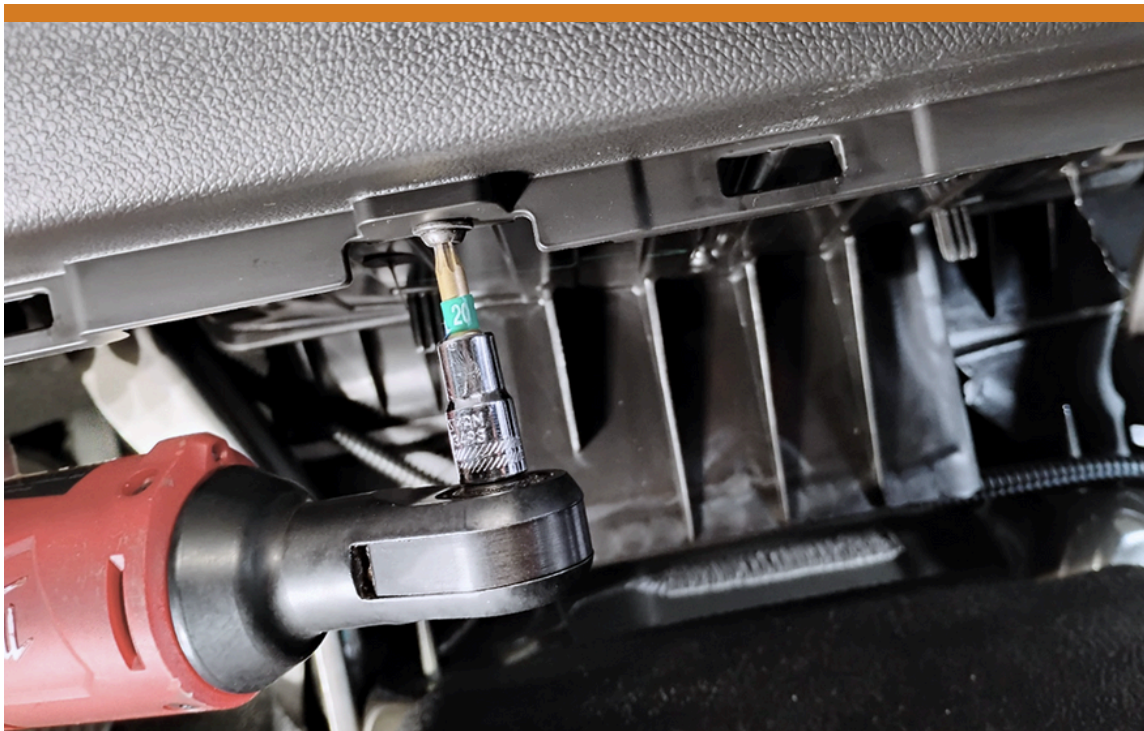



## Step By Step Installation

- 8** Remove passenger side fuse cover.



- 9** Remove 7mm hex head fastener on passenger side of trim.





## Step By Step Installation

- 10** Remove dash trim and unplug start button and key module near steering wheel.



- 11** Remove upper trim- there is a row of 7mm head fasteners across the entire piece.





## Step By Step Installation

- 12** Remove and unplug HVAC controls and center vents- there are 7mm head fasteners hidden under the sides as well as a row at the top.



- 13** Unsnap knee bolster panel under the steering wheel- it does not need to be fully removed, only enough to access the fasteners on the side of the center IP trim.



## Step By Step Installation

- 14** Undo remaining 7mm head fasteners, unsnap center IP trim, and unplug the USB module.

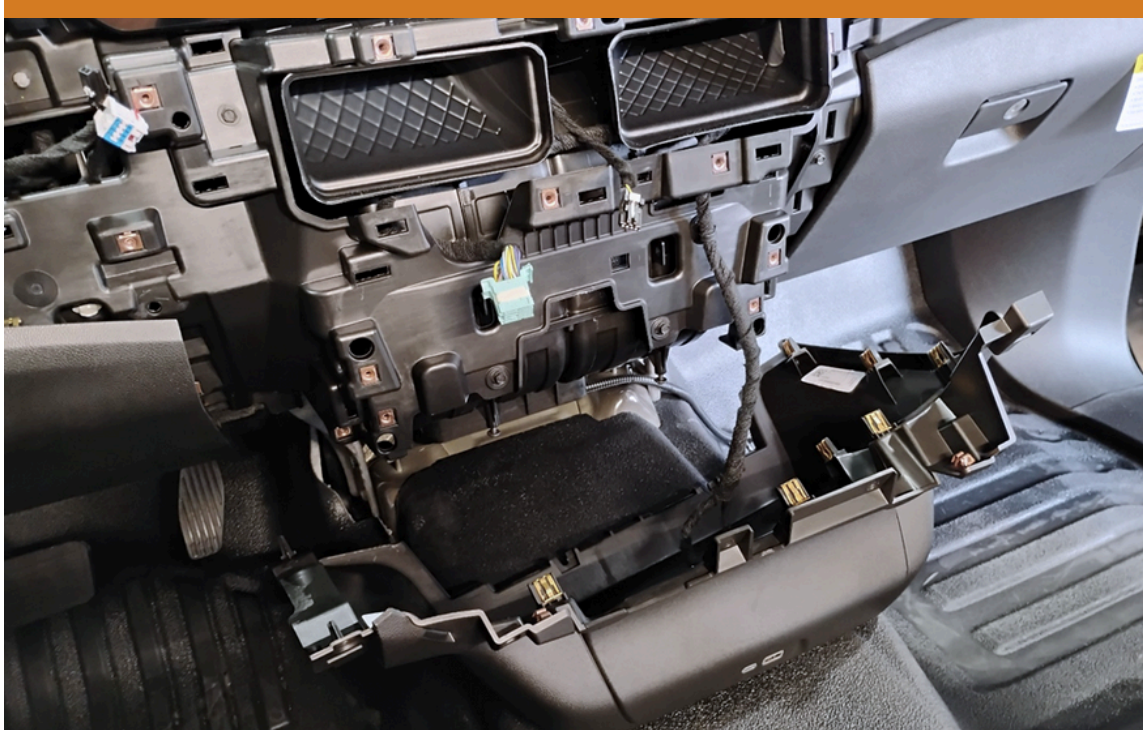

- 15** Remove the USB module from the trim panel- a small trim tool helps, there are snaps on both sides.





## Step By Step Installation

- 16** Remove the two threaded clips from the trim panel- needle nose pliers work best to compress the tabs.



- 17** Install threaded clips into the Havis trim panel.



## Step By Step Installation

**18**

Install the USB module into the Havis trim panel and install the retaining plate behind it- ensure that the USB ports are aligned with the cutouts in the front, and tighten the T20 torx fasteners evenly to ensure good alignment.



**19**

Plug USB module back in and install into vehicle, tightening all 7mm head hardware as well as the two t20 Torx fasteners underneath.





## Step By Step Installation

- 20** Installation is reverse of removal- when the HVAC controls are installed, ensure that the two fasteners shared by the upper trim aren't installed



- 21** Place front, lower mounting bracket over the two OEM studs.

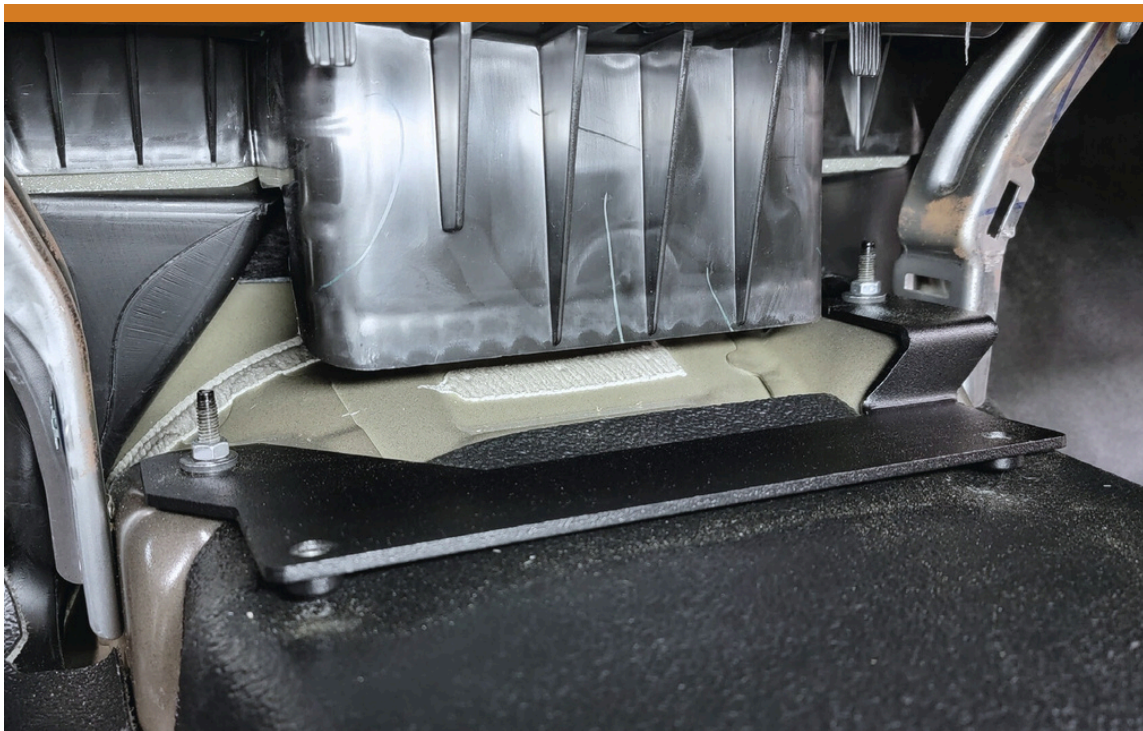



## Step By Step Installation

### 24 Reinstall OEM lower IP.



### 25 Remove (8) Allen head bolts from console housing to equipment tray (4 per side).





## Step By Step Installation

- 26** Lift off console housing from equipment mounting tray.



- 27** Attach optional CMX15600-08-1 fuse block to equipment tray. Mount and wire equipment prior to installing. There are provisions to mount up to (2) fuse block accessories.





## Step By Step Installation

- 28** Place lower equipment mounting tray onto transmission tunnel.



- 29** Line up to front, lower mounting bracket. Loosely attach 5/16" bolt, split lock washer, and flat washer.





## Step By Step Installation

- 30** Loosely install M12 bolt and flat washer into forward seat mounting hole. Repeat for other side.



- 31** Console comes with pre-installed liner. Leave this liner installed if not using a printer.





## Step By Step Installation

- 32** If using Brother PocketJet 7 printer, remove liner and discard. Lid removed to show detail.



- 33** View of mounting holes for Brother PocketJet 7 printer. Lid removed to show detail.

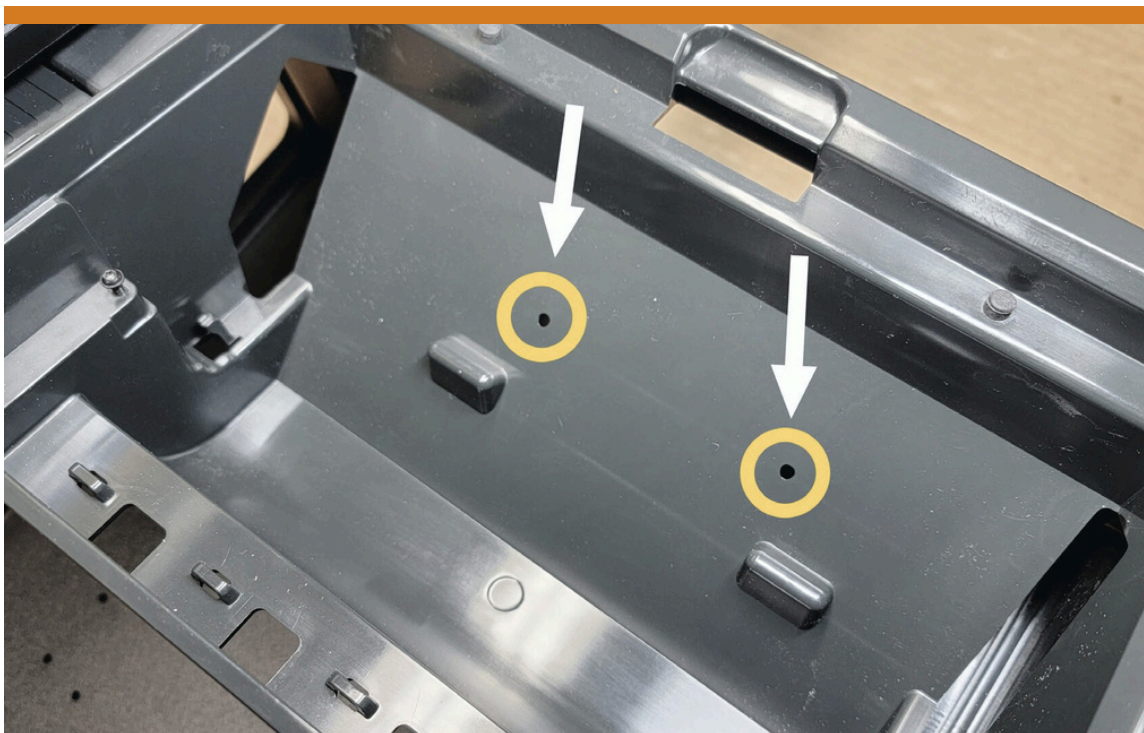



## Step By Step Installation

- 34** Pre-attach power and USB cables to printer and secure to console with supplied M2.6 x 6mm screws.



- 35** View of mounting holes for Brother PocketJet 7 printer. Lid removed to show detail.

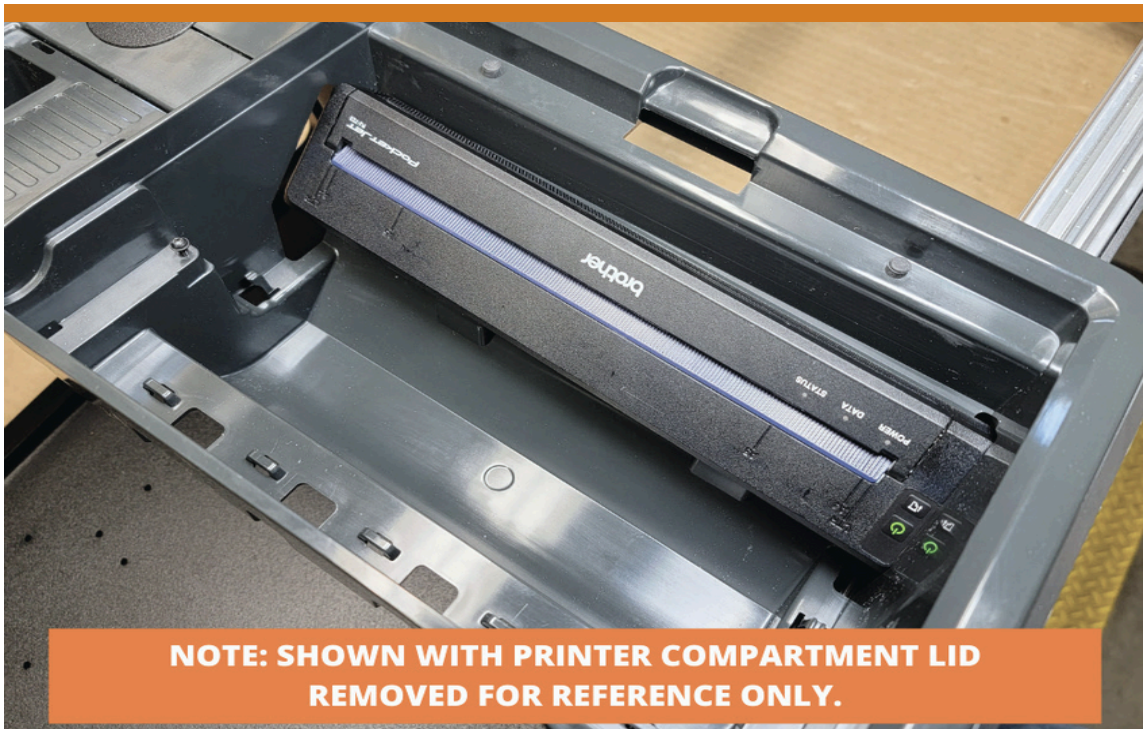



## Step By Step Installation

- 36** Place VSX console housing into vehicle, sliding tight to dash.



- 37** Loosely install M12 bolts and flat washers on rear, passenger seat mounting holes.





## Step By Step Installation

- 38** Loosely install M12 bolts and flat washers on rear, driver seat mounting holes.



- 39** Loosely attach middle console brace to equipment mounting tray using 5/16" x 3/4" bolts, split lock washers, and flat washers.

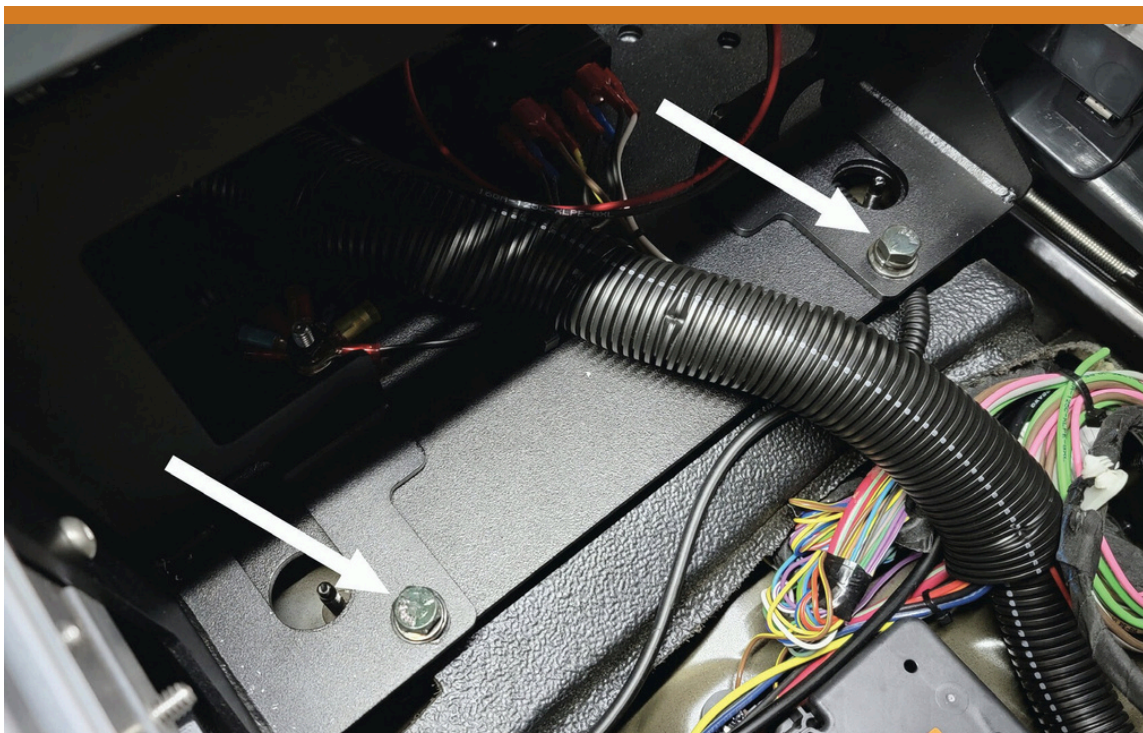



## Step By Step Installation

**40**

Line up holes in sides of console to the sides of the equipment mounting tray. Attach using Allen head bolts. Secure all loose hardware between console, equipment tray and vehicle at this time.



**41**

Use supplied mounting bracket for OEM 110V AC Receptacle.





## Step By Step Installation

- 42** Replace socket with 110V AC Receptacle.



- 43** If not relocating OEM 12v socket and AUX panel, Snap in supplied cover panel into relocation panel.





## Step By Step Installation

- 44** If not installing a C-HDM-224 pole, install the relocation panel assembly into the console and snap the 1.5" dome plug into the resulting hole.



- 45** If using internal C-HDM-224 pole, assemble and install pole parts as shown in next steps prior to installing in OEM 12v socket and/or AUX panel.





## Step By Step Installation

- 46** If installing C-HDM-224 pole, loosely attach shaft collar to pole exactly 4.375" from bottom of pole.



- 47** Position Clamp collar bolt and Shaft collar threaded hole to be square to flat side of pole base.

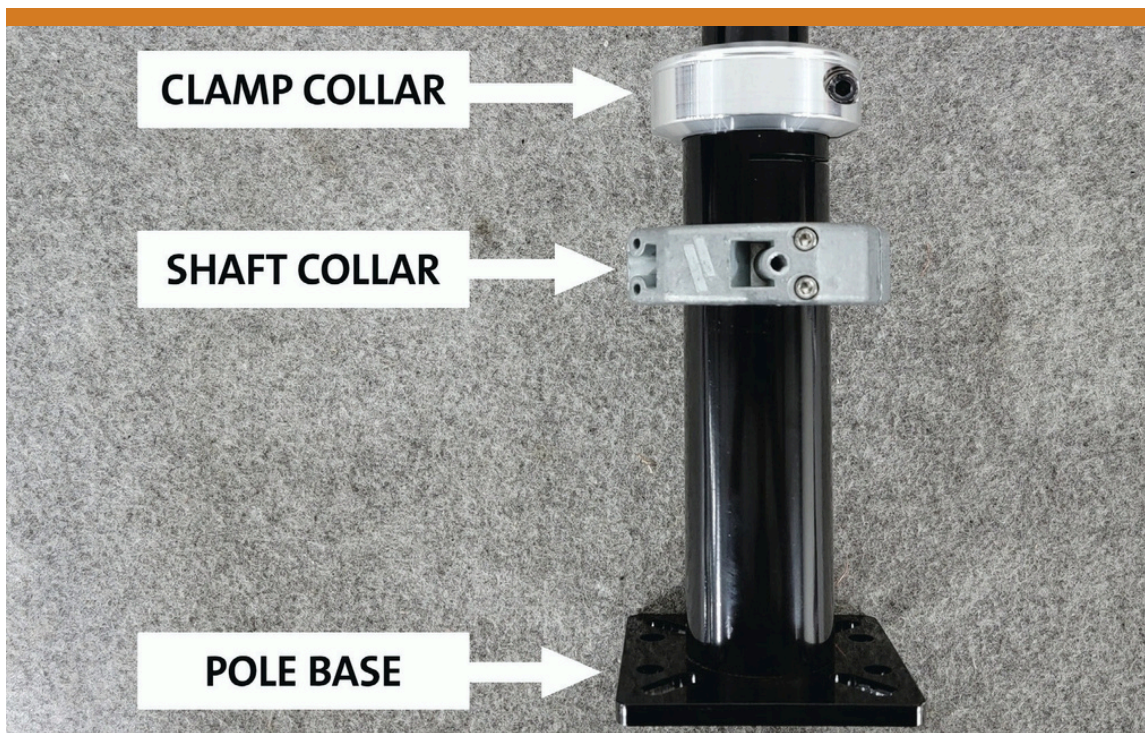



## Step By Step Installation

- 48** Orient HDM pole with Clamp Collar Bolt facing the passenger side and then place HDM pole through top of console onto equipment mounting tray. Loosely attach using 5/16 bolts, split lock washers and flat washers.



- 49** Adjust pole height as desired using a 3/16" Allen wrench on Clamp collar bolt. Access clamp bolt through side of console as shown.



## Step By Step Installation

- 50** Attach Shaft collar to brace with 1/4" x 3/4" bolt, split lock washer, and flat washer. Tighten all pole mount hardware.



- 51** If not using a lighting control head, the accessory pocket may be used in its place.





## Step By Step Installation

- 52** Slide pocket into opening in forward section of console. It should snap into position.



- 53** Attach control head to upper lid. Upper lid removed from console to show detail.





## Step By Step Installation

- 54** Mount control head using supplied hardware and spacers. Whelen control head shown. Assembly may differ depending on manufacturer.

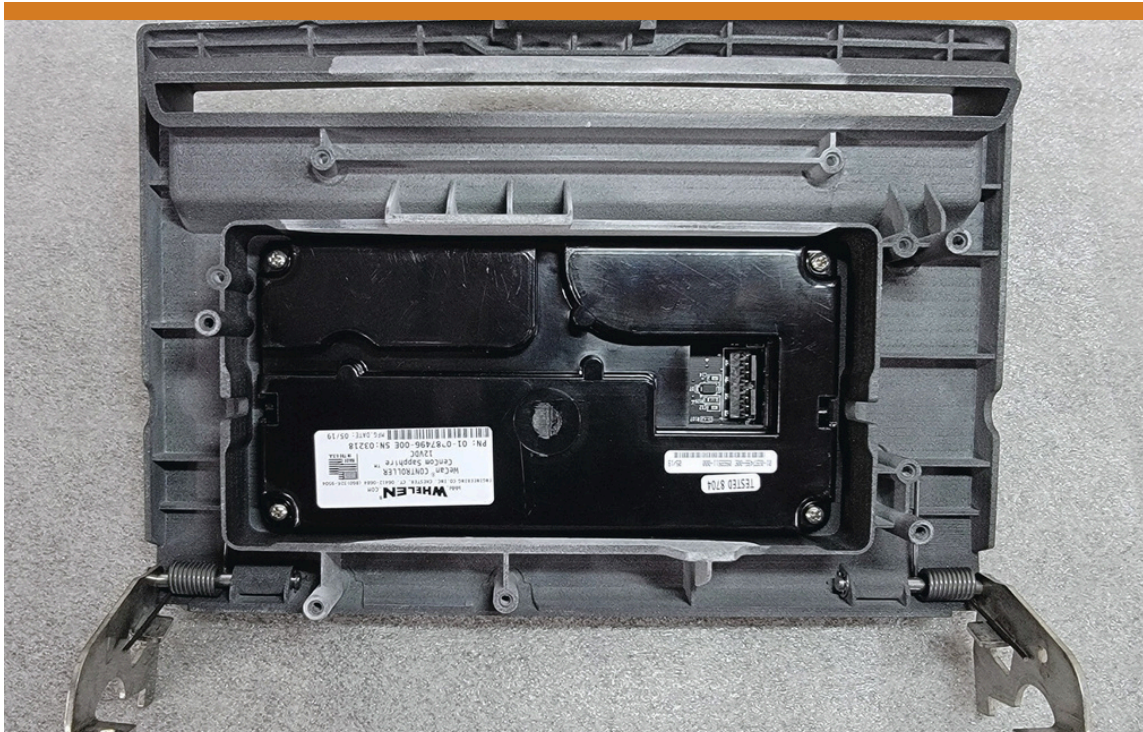

- 55** Console is shipped with rear speaker covers in place. If installing a Motorola speaker, remove speaker from housing and attach each speaker to inside of console housing with (4) M4 x 12mm T20 TORX screws provided.





## Step By Step Installation

**56** Snap side cover panels onto console.



**57** Install 3.3" console accessories at this time.





## Step By Step Installation

**58** Add desired 1/4" nuts to extrusion for mic clip brackets.



**59** Attach center trim strip.





## Step By Step Installation

### 60 Attach side trim strips.



### 61 View of paper feeding through Brother PocketJet 7.



## Step By Step Installation

### Installation Complete





## Additional Products



### REPLACEMENT SIDE TRIM STRIPS

23615



### REPLACEMENT CENTER TRIM STRIP

25820



### INTERNAL FLIP-UP ARMREST

C-ARM-1001

Internal mount armrest with integrated locking storage pocket.



### INTERNAL ARMREST WITH INTEGRATED STORAGE POCKET

C-ARM-109

Internal mount armrest with integrated 3.5" accessory pocket.



### DUAL CUP HOLDER FOR THE VSX CONSOLE

CUP2-1004

Dual internal adjustable cup holder for the VSX console.



### EIGHT POSITION FUSE BLOCK & MOUNTING BRACKET

CMX15600-08-1

Manage power needs with 8-position fuse block. Uses standard automotive ATO fuses.



### CHARGE GUARD AUTO SHUT-OFF TIMER

CG-X

Automatic power management system. Automatically turns mobile equipment on when you start the engine.



### DUAL USB CHARGER

C-USB-2

Dual 2.4 amp USB charger.



### FLASHLIGHT MOUNT

C-FLW-3555-STR

Fits Streamlight Stinger & charger (sold separately) up to 8.85"L. Positions flashlight for easy access and wire routing.



### PASSENGER SIDE ARM REST

C-ARM-110

Improves comfort for dual occupancy vehicles and height is adjustable up to 6."



**Havis, Inc.**  
75 Jacksonville Road Warminster, PA 18974  
Telephone: 1-800-524-9900 Fax: 1-215-957 0729  
[www.havis.com](http://www.havis.com)

## Troubleshooting, Maintenance, Warranty & Service

Throughout this install instructions document there have been tips and tricks on what to watch for as you assemble your solution. If you still need help with an issue, feel free to contact our Tech Support team at (800) 524-9900.

Visit our website for more details on the warranty coverage Havis offers for these products.

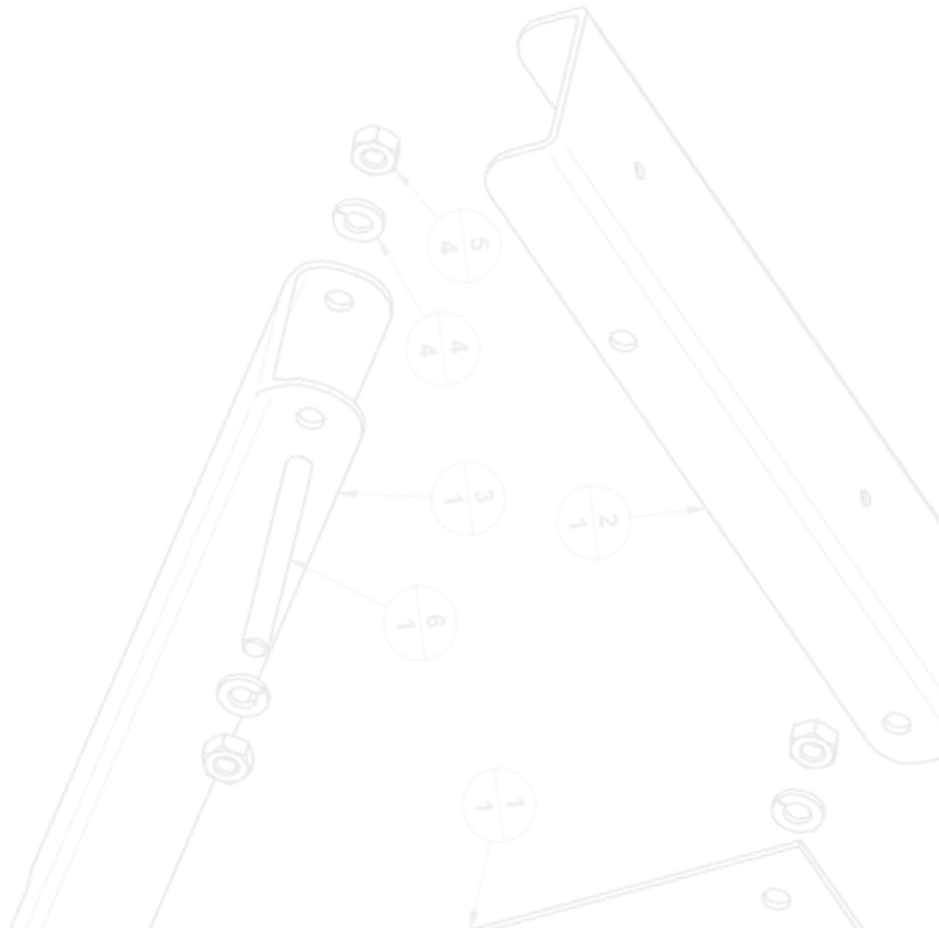
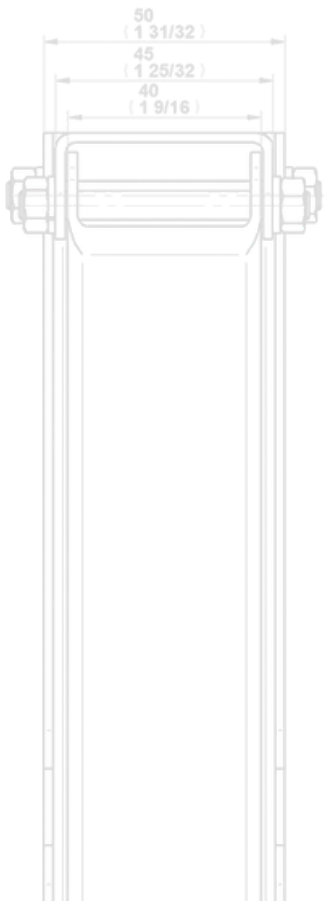

Havis, Inc.  
75 Jacksonville Road  
Warminster, PA 18974  
Telephone: 1-800-524-9900 Fax: 1-215-957 0729  
[www.havis.com](http://www.havis.com)