

Owner's Manual Havis Docking Station For Zebra TC73/TC78



DS-ZEB-700 Series

This owner's manual applies to the following part numbers:

DS-ZEB-701



DS-ZEB-700-SERIES_OMN_10-24

Before Beginning

Havis is pleased to provide this owner's manual to aid in the proper installation and use of the DS-ZEB-700 Series Docking Station for the Zebra TC73/TC78 Mobile Computer.

For questions regarding the set-up of your DS-ZEB-700 Series Docking Station, please contact Havis at 1-800-524-9900 or visit www.havis.com for additional product support and information.

WARNING

- NEVER STOW OR MOUNT THE DOCKING STATION DIRECTLY IN A VEHICLE AIRBAG DEPLOYMENT ZONE.
- DO NOT USE COMPUTER WHILE DRIVING.
- DO NOT PLACE METAL OBJECTS OR CONTAINERS OF LIQUID ON TOP OF THE DOCKING STATION.

CAUTION

- READ ALL INSTRUCTIONS THOROUGHLY BEFORE BEGINNING INSTALLATION.
- THIS DOCKING STATION IS NOT CLASSIFIED WITH AN IP (INGRESS PROTECTION) RATING. DO NOT STORE, INSTALL, OR WHERE WATER, MOISTURE, STEAM, DUST, ETC. ARE PRESENT.
- DO NOT CONNECT CABLES INTO PORTS OTHER THAN WHAT THEY ARE SPECIFIED FOR.
- DO NOT LEAVE THE DOCKING STATION IN A HIGH TEMPERATURE ENVIRONMENT (GREATER THAN 85°C, 185°F).
- DO NOT LEAVE THE ZEBRA TC73/TC78 IN A HIGH TEMPERATURE ENVIRONMENT (GREATER THAN 70°C, 158°F).

Specifications

Power Input	Standard USB-C Power Delivery
Dimensions	9.06" (23.0 cm) H x 4.20" (10.7 cm) W x 2.19" (5.6 cm) D
Weight	0.65 lbs. (0.29 kg)
Operating Environment	-20°C to 50°C (-4°F to 122°F)
Storage Environment¹	-40°C to 85°C (-40°F to 185°F)

¹ The Zebra TC73/TC78 has a storage environment of -40°C to 70°C (-40°F to 158°F).

² The Zebra TC73/TC78 will only charge when the environment temperature is between 0°C and 50°C (-32°F to 122°F).



Parts Included

Docking Station

Latch Handle

USB-C
Cable

AMPS
Mounting
Holes



Hardware Kit (30-010825)

This hardware kit includes:

1. M4 x 0.7 x 12mm pan head screws (5)
2. Split lock washers (5)
3. M4 washers (5)

Tools required for installation:

- #2 Phillips (for M4 pan head screws)

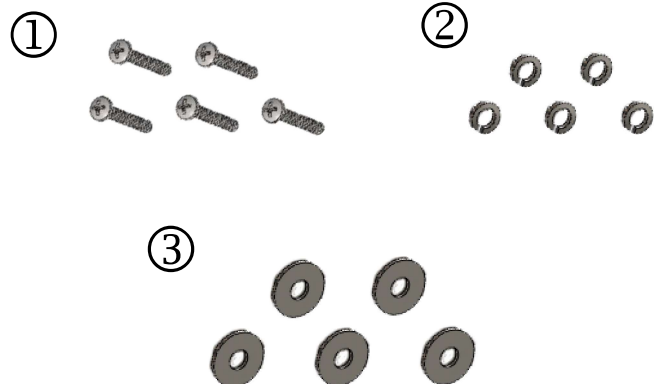

Installation

- 1) Align the docking station mounting holes with the hole pattern on the mounting device. Use the provided hardware kit to secure the docking station to the mounting device. Torque the screws to 20 in-lbs (2.3Nm) \pm 10%

Note that the specified screws are for 0.070" - 0.220" thick mounting plates. Please switch to an appropriate length screw if your installation is outside that range.

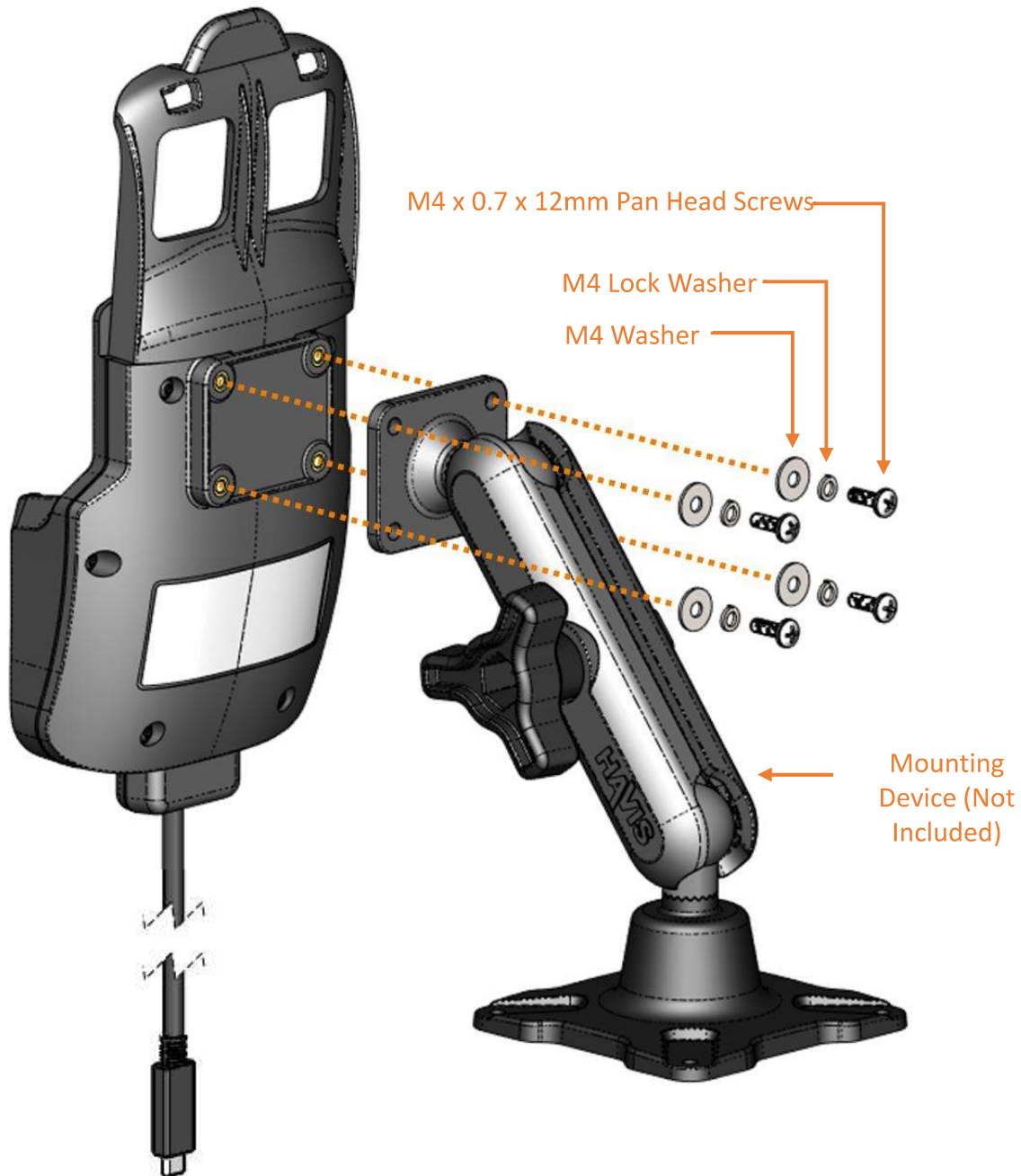

Installation *(continued)*

- 2) Connect the USB-C cable to an appropriate USB charging port or USB charger.

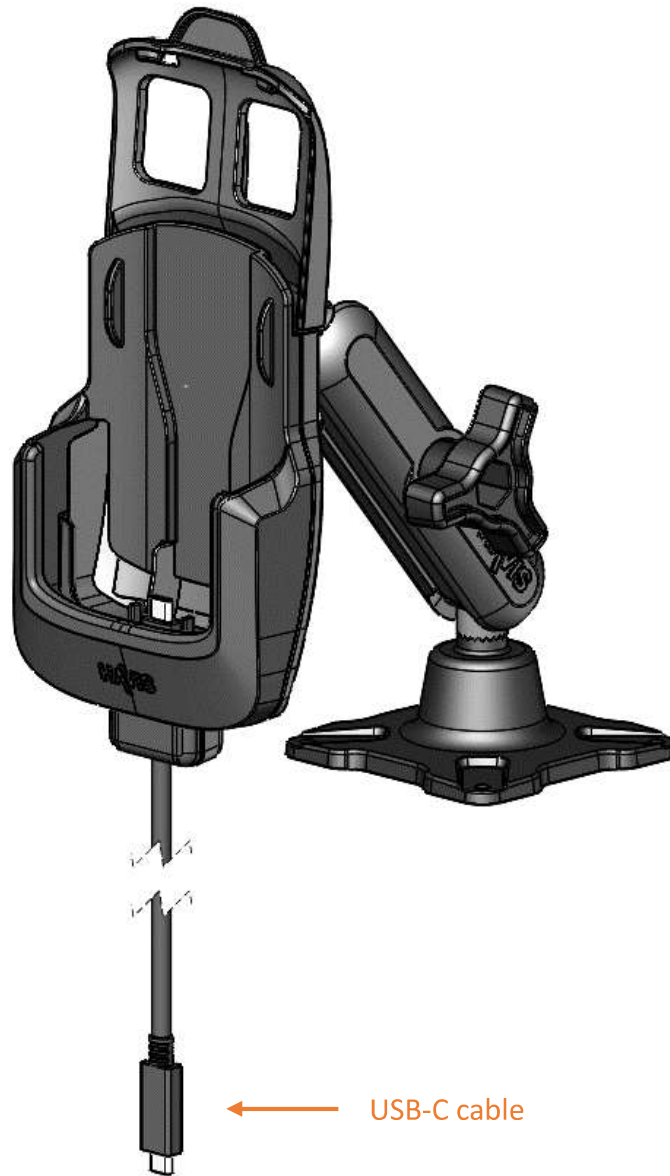

Cable Management

After installation, tie off cable to the mounting system by using zip ties or other means. Ensure there is sufficient cable slack near the docking station to avoid tension on the USB cable throughout the mounting device's full range of motion.

Operation - Docking

1. Insert the mobile device into the docking station, as shown below.

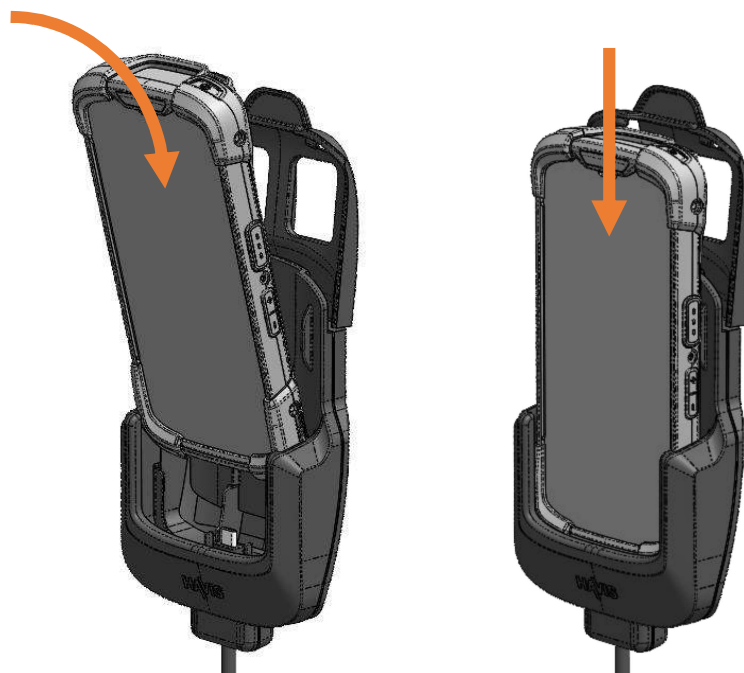

2. To latch the device, squeeze the top of the device and docking station together until a click is heard.

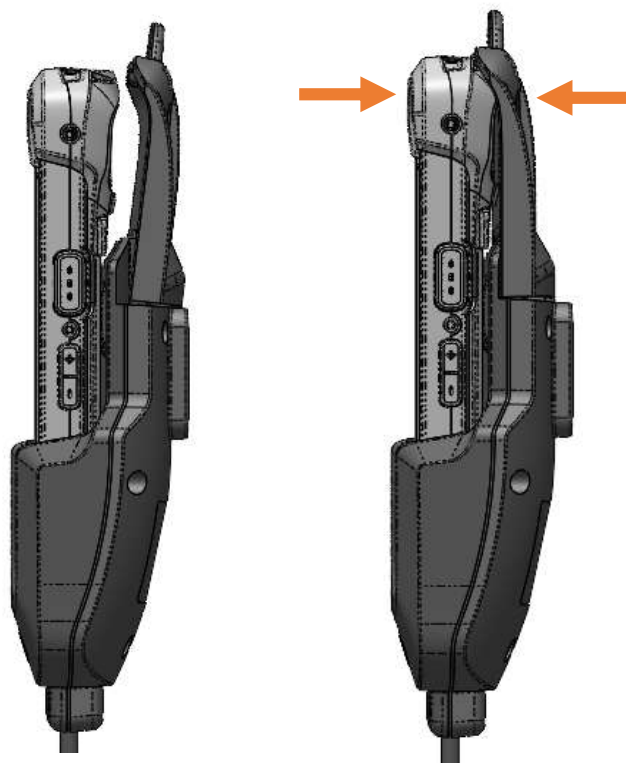

Operation - Docking



DO NOT FORCE DEVICE INTO DOCKING STATION. IF THERE IS RESISTANCE, ENSURE THAT THE DEVICE IS ORIENTED RIGHT SIDE UP (WITH THE USB PORT FACING DOWN).

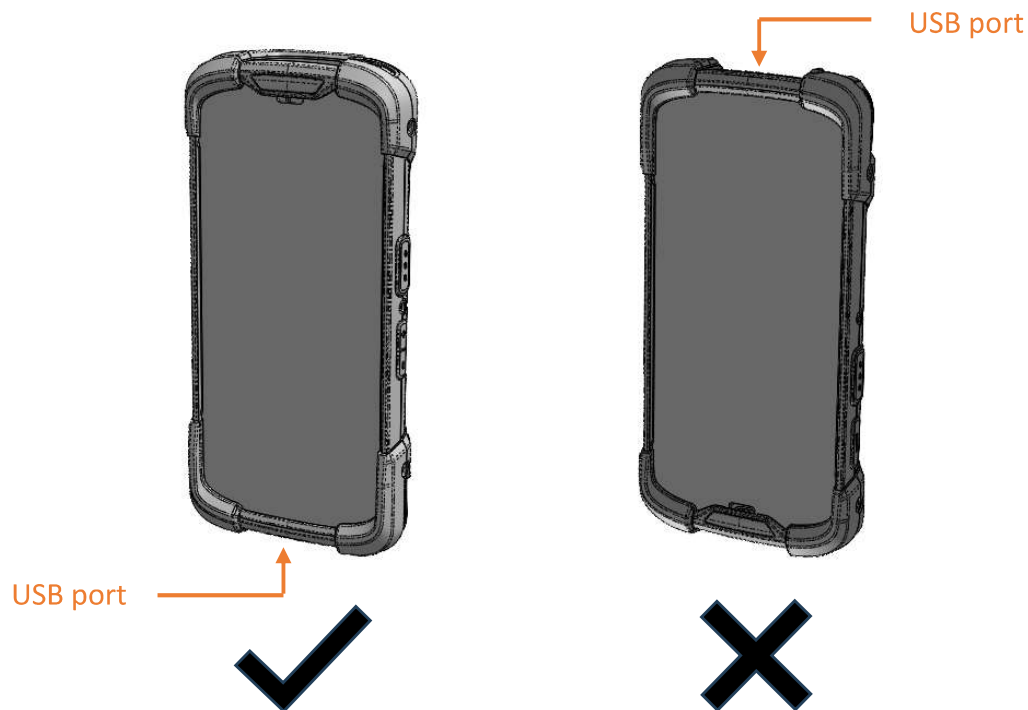

Operation - Undocking

1. To unlatch the device, push on the tab at the top of the docking station until a click is heard.

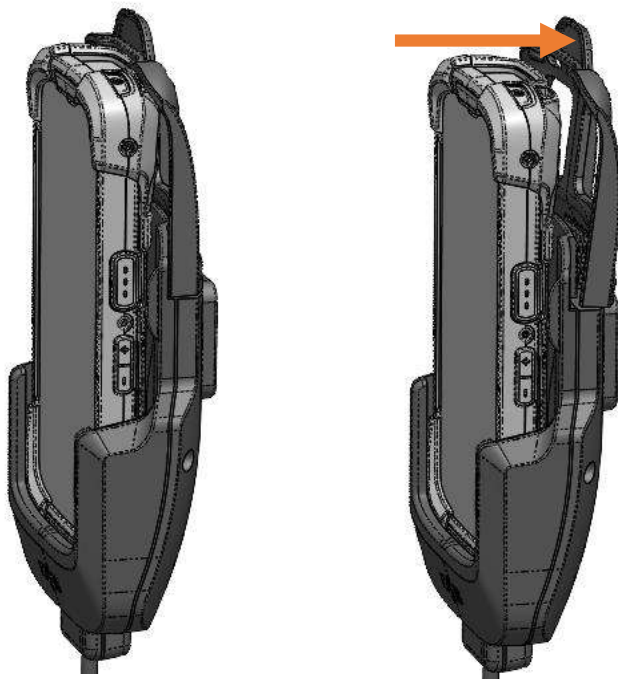

2. Remove the device from the docking station, as shown below.



Cable Replacement

The DS-ZEB-700's USB-C cable can be easily replaced should it be damaged. The replacement cable (DS-DA-331) is sold separately.

1. To begin cable replacement, use a T10 screwdriver to remove the 6 screws on the back of the dock and take out the rear cover.

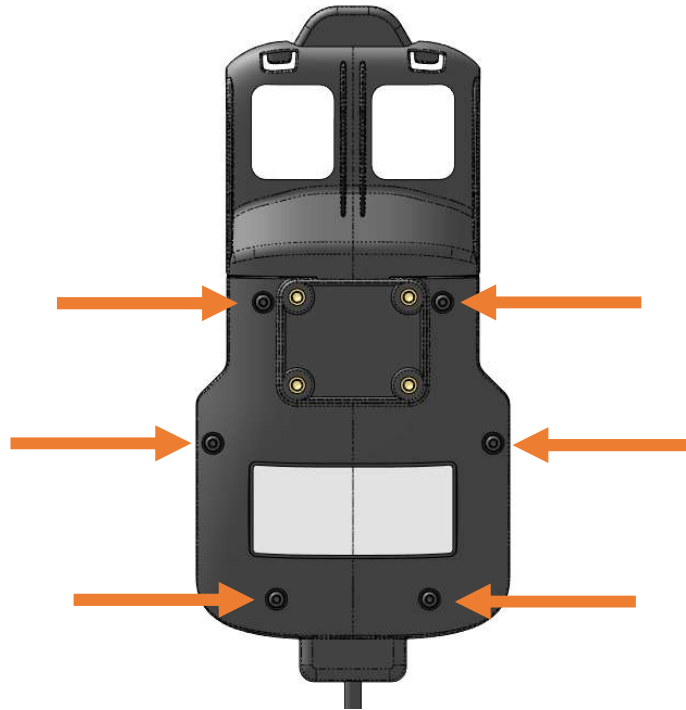

3. Remove the hook piece and cable from the assembly, as shown below.

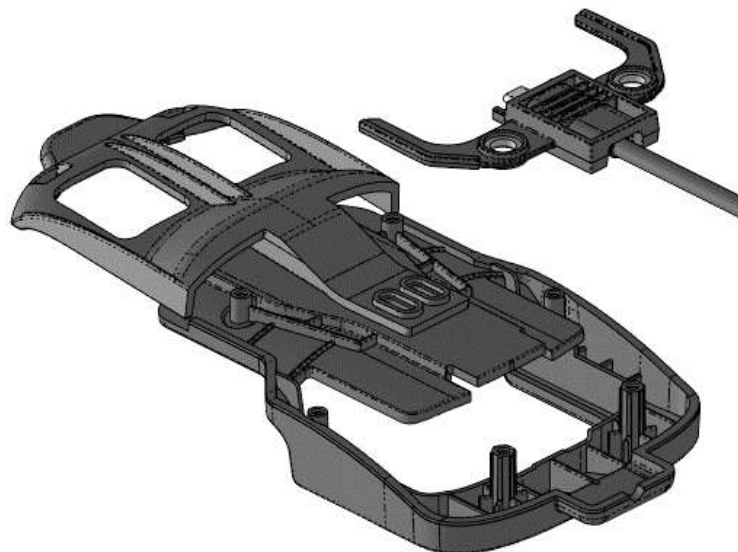

Cable Replacement (*continued*)

3. Switch out the cable from the hook piece with the replacement cable. Make sure the cable is snug within the hook piece.

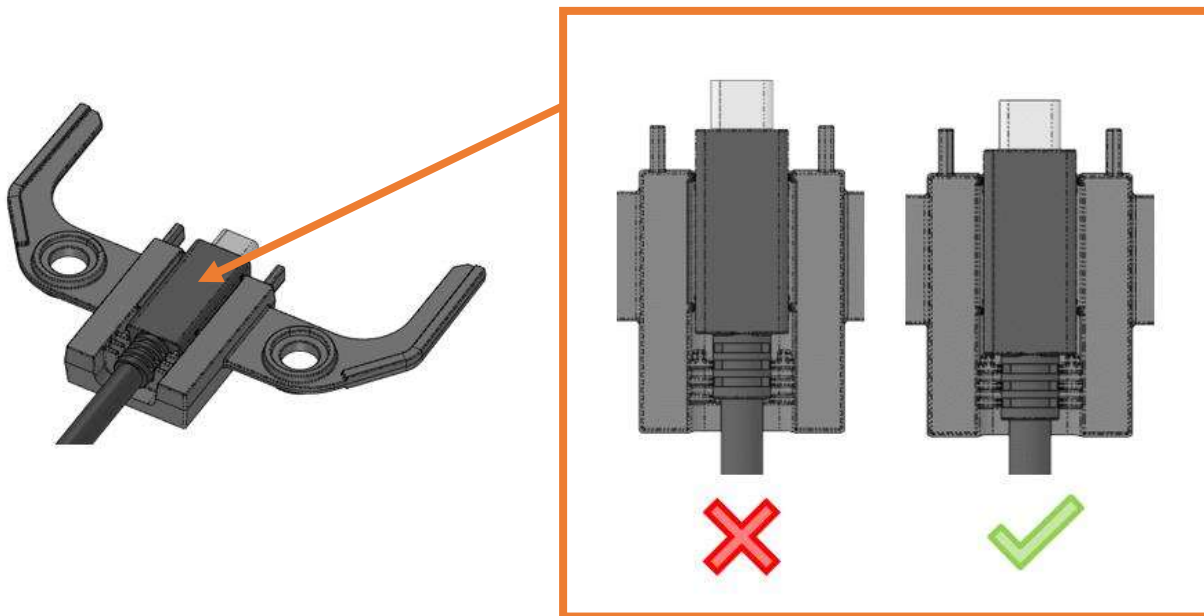

4. Put the hook piece and cable back onto the assembly by lining it up with the two posts shown below. Make sure the cable is trapped between the assembly and hook piece.

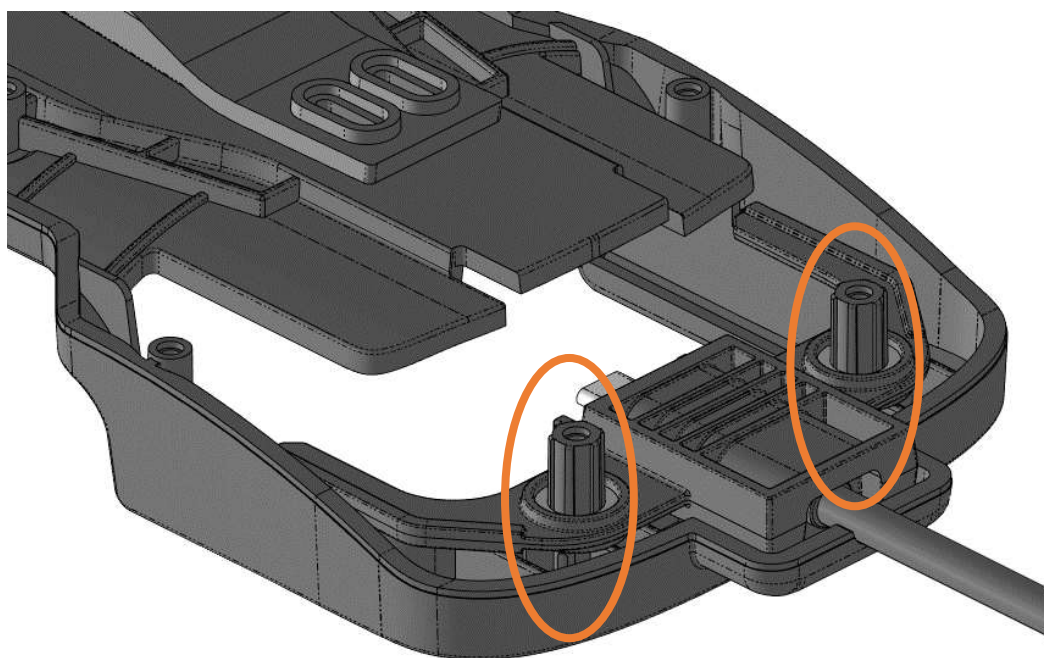

Cable Replacement *(continued)*

3. Make sure the obrounds between the latch piece and front housing are lined up.

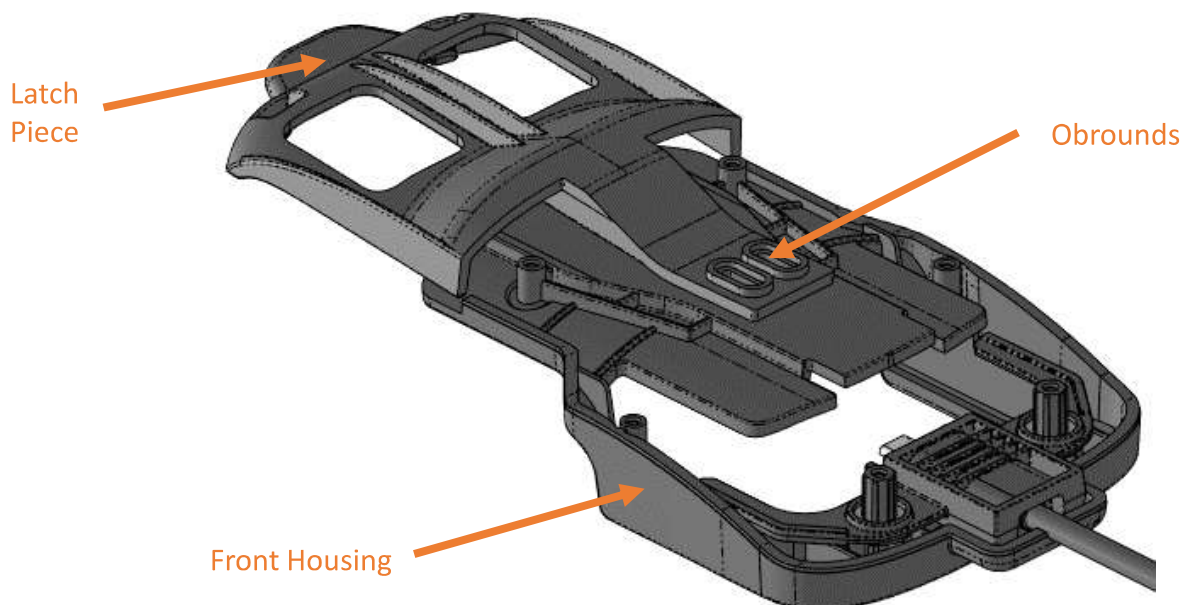

4. Place the rear cover back on and fasten with the 6 screws. Torque screws to 8 in-lbs. DO NOT OVER TORQUE.

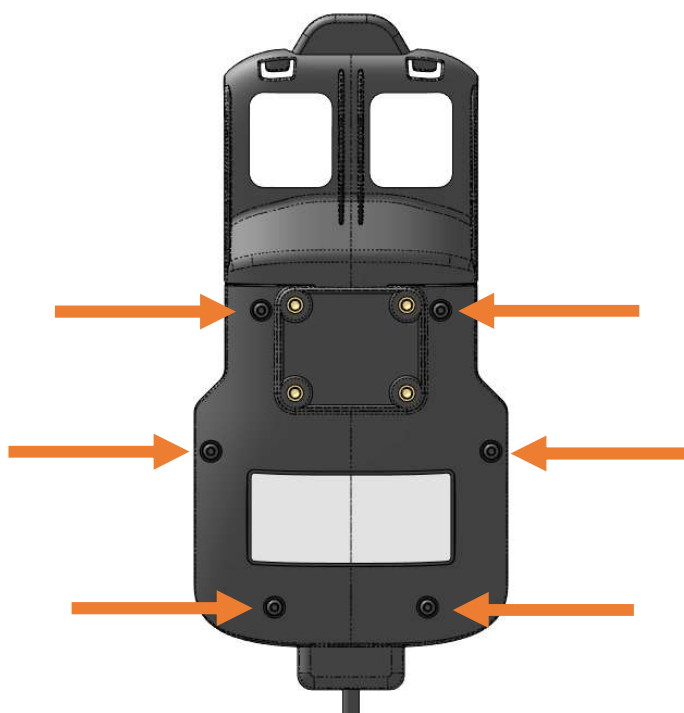

Regulatory Information

European Union

Waste Electrical and Electronic Equipment (WEEE)

Electrical and electronic equipment (EEE) contain materials, components and substances that can be hazardous and harmful to human health and the environment when WEEE is not disposed of properly.

Products marked with the "crossed-out wheeled bin" symbol are EEE. The crossed-out wheeled bin symbolizes that WEEE must not be disposed of together with unsorted household waste, but must be collected separately.

For this purpose, all municipalities have established collection schemes where WEEE can be handed in, free of charge, by citizens at recycling stations or other collection points or collected directly from households. Further information should be obtained from the municipality's technical administration.



This symbol on the product or on its packaging indicates that the product must not be disposed of with normal household waste. Instead, it is your responsibility to dispose of your waste equipment by arranging to return it to a designated collection point for the recycling of WEEE. By separating and recycling your waste equipment at the time of disposal, you will help to conserve natural resources and ensure that the equipment is recycled in a manner that protects human health and the environment. This product is EEE and shall not be placed in the municipal waste after end of its life. This device should be handled properly and handed over to appropriate collection places or to authorized companies.

Conformité Européene (CE) Mark



The CE marking on a Havis product indicates conformity to the provisions of applicable European Union (EU) directives. The EU Declaration of Conformity (DoC) is the manufacturer's declaration that the product complies with those directives.

Related Products

Havis offers a wide variety of accessory products specifically for use with your Docking Station. For more information or to order, please visit www.havis.com.



C-USB-4

USB-C CAR FAST CHARGER

Tested and certified to provide a safe, fast charge to your USB-C device.



C-USB-3

USB-C AND USB-A DUAL PORT CHARGER

Flexible charging for both USB-C and USB-A devices.



DS-DA-331

USB-C MALE TO MALE CABLE

Replacement cable for Havis USB-C devices.