

INSTALLATION INSTRUCTIONS:

ASSEMBLE DEVICE ONTO MULTIPURPOSE BRACKET

Determine which device will be assembled onto the Adapter Bracket.

Configuration #1

1. Use the 2X Machine Screws to fasten the Havis Power Supply to the LPS-211 Multipurpose Bracket as shown. Torque to 8 in-lbs. ±10%.
2. Follow the remaining installation instructions supplied with Power Supply.

Configuration #2

1. Feed the hard wired Output Cable of the Getac Power Supply through the front face of the LPS-208 Getac Power Supply Mounting Bracket, then settle the bracket over top of Getac Power Supply as shown.
2. Use the 2X Machine Screws and 2X Nylon Lock Nuts to fasten the Getac Power Supply Mounting Bracket to the LPS-211 Multipurpose Bracket, as shown. Torque to 8 in-lbs. ±10%.
3. Plug Input Power Cable into Power Supply as shown. Follow the remaining installation instructions supplied with Getac Power Supply.

Configuration #3

1. Insert the input and output cables into the Lind Power Supply Adapter. See installation instructions supplied with Power Supply for more details.
2. Take care to properly align grooves in the power supply cables with the strain relief tabs of the Strain Relief Bracket (this will help prevent accidental disconnects).
3. Ensure that the 4X Flat Washers (provided with Power Supply) are positioned as shown during installation.
4. Install the 2X #6-32 X 1-1/4" Machine Screws through the holes on the other side of the mounting surface and attach power supply with the 2X #6-32 Lock Nuts (provided with Power Supply) and tighten. Fasten the remaining 2X #6-32 X 1-3/8" Machine Screws into the thru holes on the Strain Relief Bracket. Torque nuts to 8 in-lbs. ±10%.
5. Follow the remaining installation instructions supplied with your Power Supply.

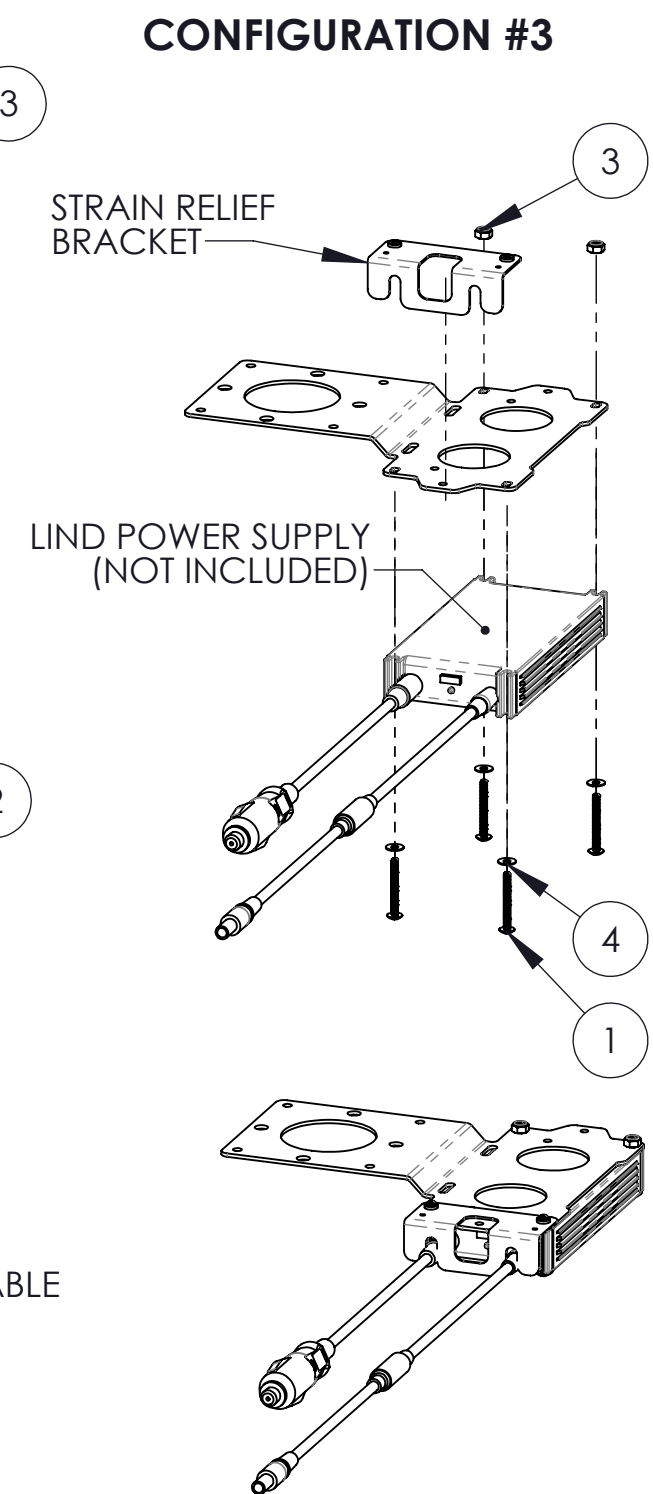
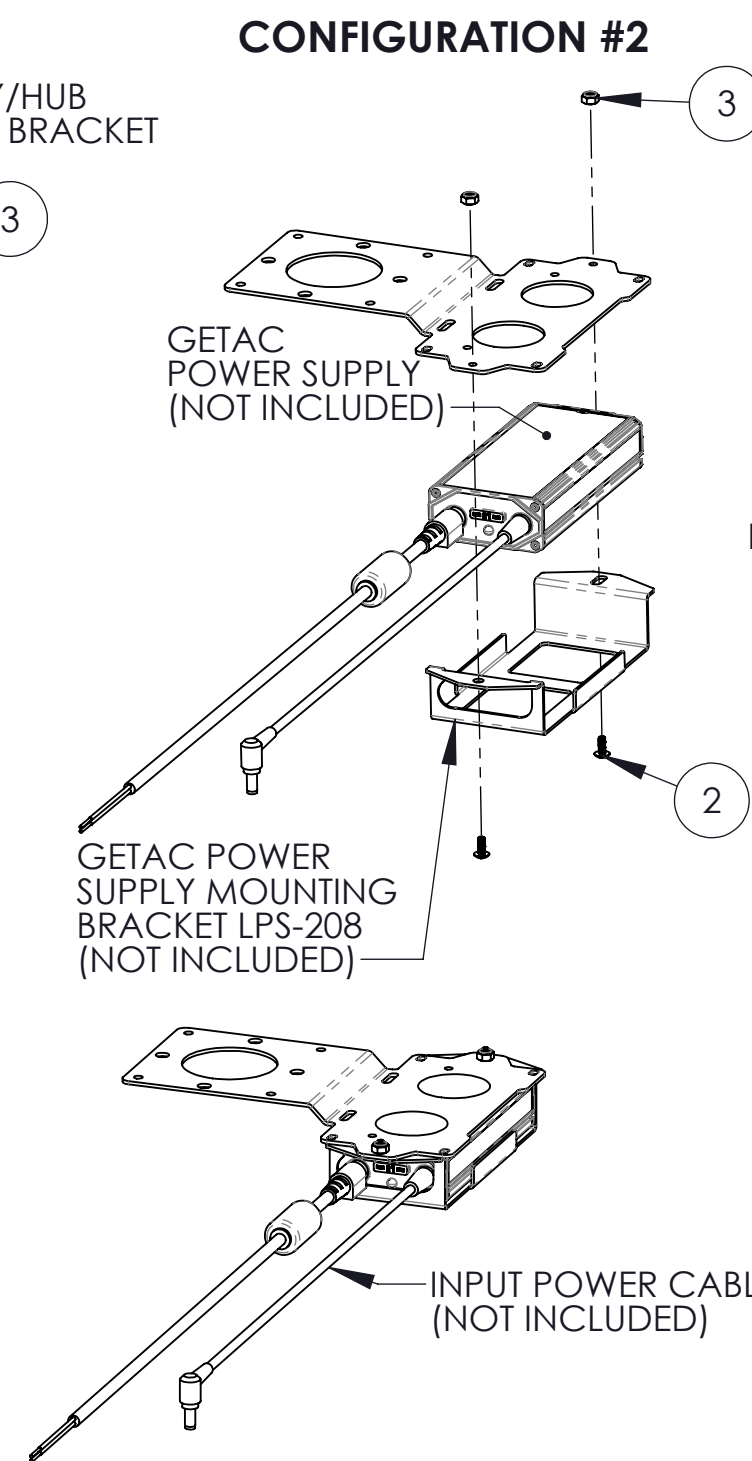
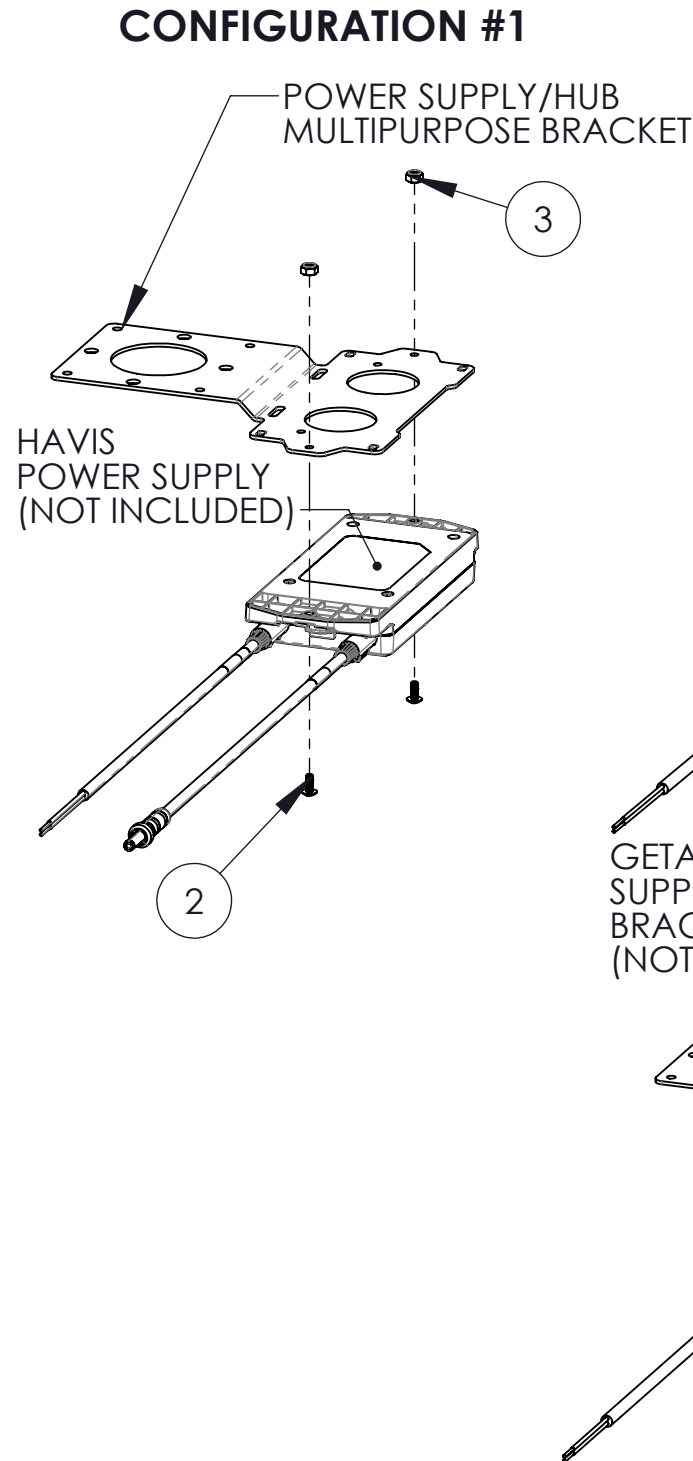

HARDWARE KIT CONTENTS

ITEM #	DESCRIPTION	QTY.	DRIVE STYLE/SIZE
1	MACHINE SCREW, TRUSS HEAD, #6-32 x 1-1/4" LONG	4	PH2
2	MACHINE SCREW, TRUSS HEAD, #6-32 x 3/8" LONG	2	PH2
3	NUT, #6-32 NYLON INSERT	2	5/16 SOCKET
4	FLAT WASHER, #6	4	N/A

⚠ WARNING: ALL HAVIS INC. PRODUCTS ARE DESIGNED WITH SAFETY OF USE AND INSTALLATION IN MIND. HOWEVER, IT IS THE SOLE RESPONSIBILITY OF THE OWNER/OPERATOR OF A VEHICLE USING HAVIS INC. MOUNTING AND DOCKING EQUIPMENT, TO ENSURE THAT THE EQUIPMENT IS INSTALLED SO THAT IT WILL NOT INTERFERE WITH VEHICLE OPERATION, INTERFERE WITH SAFETY DEVICES, OBSTRUCT VIEW OF DRIVING CONDITIONS, OR IN ANY WAY DEGRADE OCCUPANT SAFETY. IMPROPER INSTALLATION CAN CAUSE SERIOUS INJURY IN THE EVENT OF AN ACCIDENT. INSTALLATION SHOULD ONLY BE PERFORMED BY QUALIFIED PROFESSIONALS. COMPUTERS AND MOTION DEVICES MUST BE MOVED TO AND STOWED/SECURED IN THEIR SAFE DRIVING POSITIONS BEFORE OPERATING VEHICLE.

⚠ AVERTISSEMENT : TOUS LES PRODUITS HAVIS INC. SONT CONÇUS EN TENANT COMPTE DES EXIGENCES EN MATIÈRE DE SÉCURITÉ D'UTILISATION ET D'INSTALLATION. CEPENDANT, IL EST DE LA SEULE RESPONSABILITÉ DU PROPRIÉTAIRE/OPÉRATEUR D'UN VÉHICULE UTILISANT L'ÉQUIPEMENT DE MONTAGE ET D'AMARRAGE DE HAVIS INC. DE S'ASSURER QUE L'ÉQUIPEMENT EST INSTALLÉ DE MANIÈRE À NE PAS INTERFÉRER AVEC LE FONCTIONNEMENT DU VÉHICULE, À NE PAS GÊNER LES DISPOSITIFS DE SÉCURITÉ, À NE PAS ENTRAVER LA VISIBILITÉ DES CONDITIONS DE CONDUITE OU À NE PAS COMPROMETTRE DE QUELQUE MANIÈRE QUE CE SOIT LA SÉCURITÉ DES OCCUPANTS. UNE INSTALLATION INCORRECTE PEUT PROVOQUER DES BLESSURES GRAVES EN CAS D'ACCIDENT. L'INSTALLATION NE DOIT ÊTRE EFFECTUÉE QUE PAR DES PROFESSIONNELS QUALIFIÉS. LES ORDINATEURS ET LES ÉQUIPEMENTS DE TRANSPORT DOIVENT ÊTRE DÉPLACÉS ET RANGÉS DE MANIÈRE ADÉQUATE ET EN TOUTE SÉCURITÉ AVANT UTILISATION DU VÉHICULE.

DRAWING NO.
E102454

REV.
A

PRODUCT DESCRIPTION
**INSTALLATION INSTRUCTIONS,
LPS-211**

HAVIS

1-800-524-9900
WWW.HAVIS.COM

WEIGHT: (LBS)

-

REV. DATE

05-12-26

INSTALLATION INSTRUCTIONS (CONTINUED): ASSEMBLE MULTIPURPOSE BRACKET W/DEVICE TO DOCKING STATION AND MOTION DEVICE

1. Align mounting holes in LPS-211 Multipurpose Bracket to mounting holes in the Docking Station and Motion/Mounting Device. Fasten using mounting hardware included with respective Docking Station hardware kits.
2. Make sure the Multipurpose Bracket is assembled and mounted in a way where the Power Supply/HUB/Device is oriented away from the Handle on the Motion/Mounting Device. See configurations 1 thru 3.

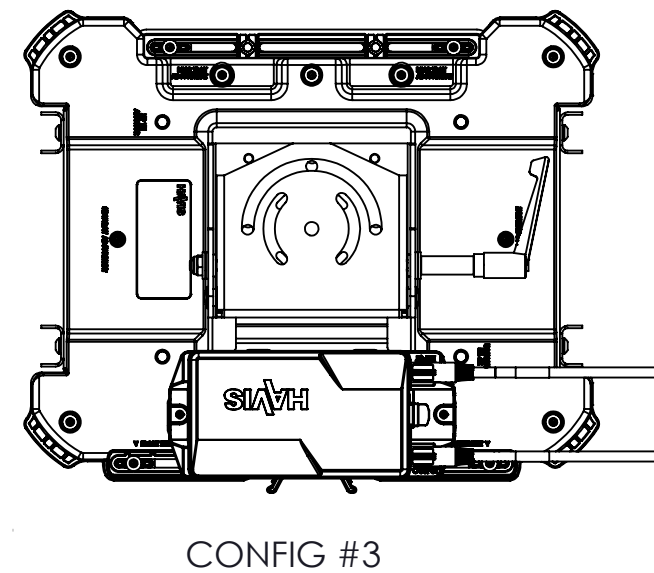
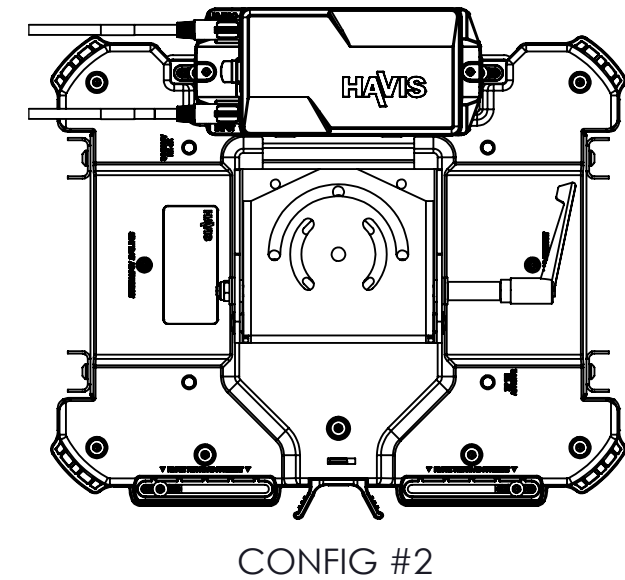
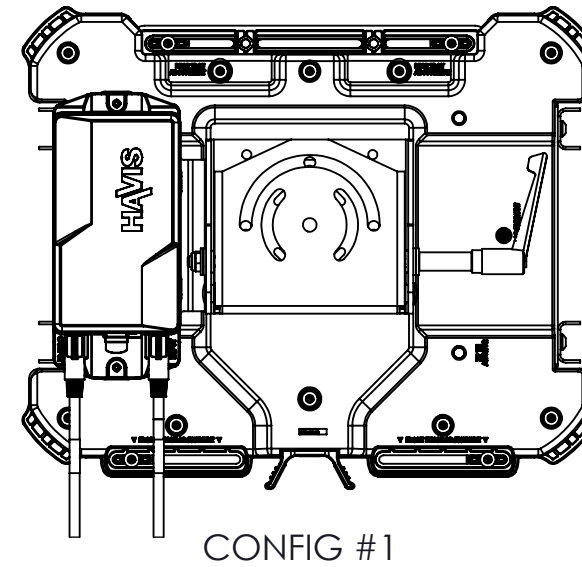
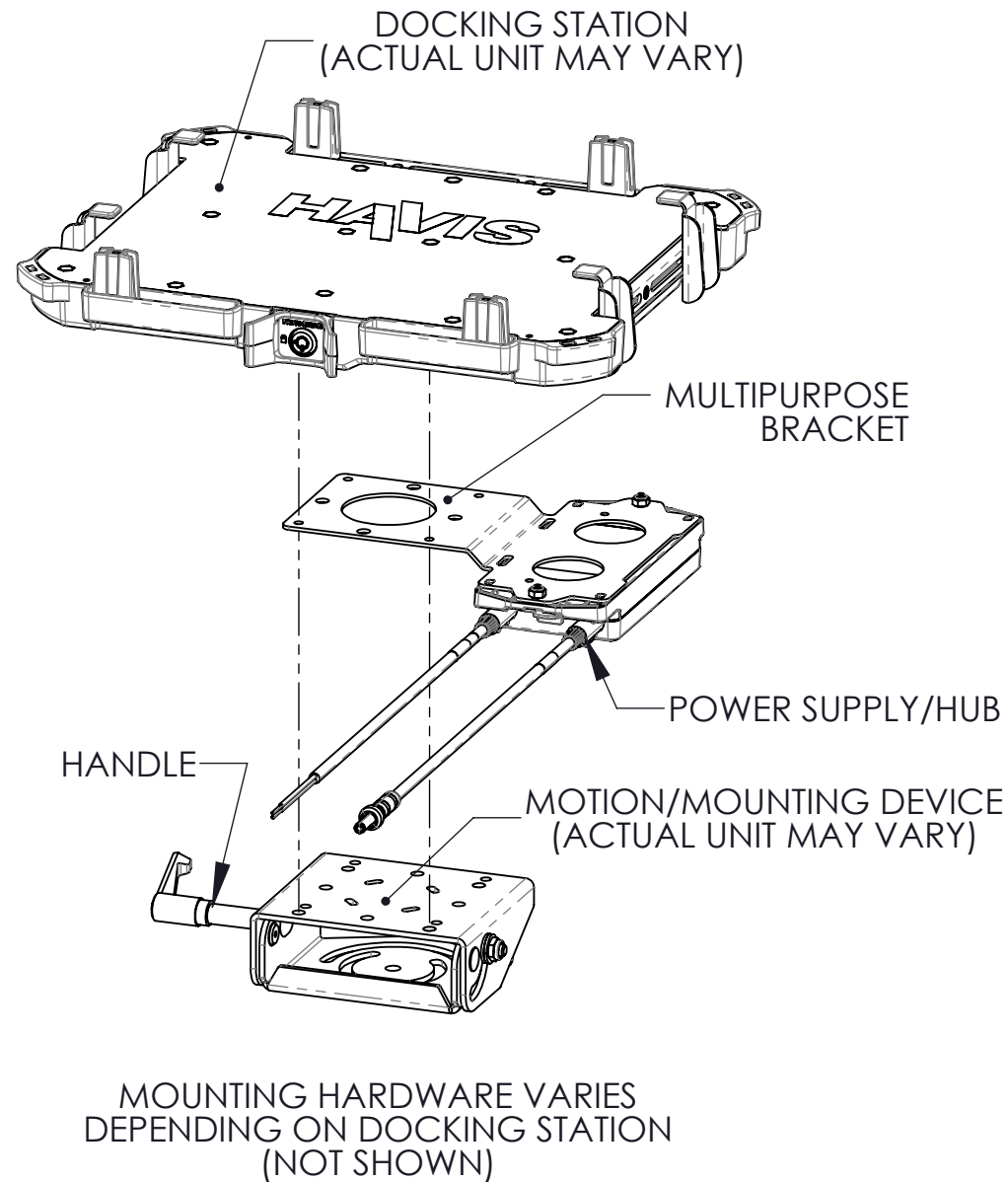

! WARNING: ALL HAVIS INC. PRODUCTS ARE DESIGNED WITH SAFETY OF USE AND INSTALLATION IN MIND. HOWEVER, IT IS THE SOLE RESPONSIBILITY OF THE OWNER/OPERATOR OF A VEHICLE USING HAVIS INC. MOUNTING AND DOCKING EQUIPMENT, TO ENSURE THAT THE EQUIPMENT IS INSTALLED SO THAT IT WILL NOT INTERFERE WITH VEHICLE OPERATION, INTERFERE WITH SAFETY DEVICES, OBSTRUCT VIEW OF DRIVING CONDITIONS, OR IN ANY WAY DEGRADE OCCUPANT SAFETY. IMPROPER INSTALLATION CAN CAUSE SERIOUS INJURY IN THE EVENT OF AN ACCIDENT. INSTALLATION SHOULD ONLY BE PERFORMED BY QUALIFIED PROFESSIONALS. COMPUTERS AND MOTION DEVICES MUST BE MOVED TO AND STOWED/SECURED IN THEIR SAFE DRIVING POSITIONS BEFORE OPERATING VEHICLE.

! AVERTISSEMENT : TOUS LES PRODUITS HAVIS INC. SONT CONÇUS EN TENANT COMPTE DES EXIGENCES EN MATIÈRE DE SÉCURITÉ D'UTILISATION ET D'INSTALLATION. CEPENDANT, IL EST DE LA SEULE RESPONSABILITÉ DU PROPRIÉTAIRE/OPÉRATEUR D'UN VÉHICULE UTILISANT L'ÉQUIPEMENT DE MONTAGE ET D'AMARRAGE DE HAVIS INC. DE S'ASSURER QUE L'ÉQUIPEMENT EST INSTALLÉ DE MANIÈRE À NE PAS INTERFÉRER AVEC LE FONCTIONNEMENT DU VÉHICULE, À NE PAS GÊNER LES DISPOSITIFS DE SÉCURITÉ, À NE PAS ENTRAVER LA VISIBILITÉ DES CONDITIONS DE CONDUITE OU À NE PAS COMPROMETTRE DE QUELQUE MANIÈRE QUE CE SOIT LA SÉCURITÉ DES OCCUPANTS. UNE INSTALLATION INCORRECTE PEUT PROVOQUER DES BLESSURES GRAVES EN CAS D'ACCIDENT. L'INSTALLATION NE DOIT ÊTRE EFFECTUÉE QUE PAR DES PROFESSIONNELS QUALIFIÉS. LES ORDINATEURS ET LES ÉQUIPEMENTS DE TRANSPORT DOIVENT ÊTRE DÉPLACÉS ET RANGÉS DE MANIÈRE ADÉQUATE ET EN TOUTE SÉCURITÉ AVANT UTILISATION DU VÉHICULE.

DRAWING NO. E102454	REV. A
PRODUCT DESCRIPTION INSTALLATION INSTRUCTIONS, LPS-211	
1-800-524-9900 WWW.HAVIS.COM	WEIGHT: (LBS) - REV. DATE 05-12-26